

CENTURY
 Environmental | Civil Co.
 1101 Forest Hill Road
 Raleigh, NC 27607
 919.876.1232
 www.century.com

Engineering | Survey | Planning
 Radtke Consulting, Inc.
 2400 Capital Boulevard
 Suite 201
 Cary, NC 27513
 919.487.1572
 www.radtke.com

Architect | Planner | Engineer
 Larch, Erb & Brower, Osh
 22805 Harris Center
 Raleigh, NC 27628
 919.876.1232
 www.larch.com

PGDA
 2400 Capital Boulevard
 Suite 201
 Cary, NC 27513
 919.487.1572
 www.pgda.com

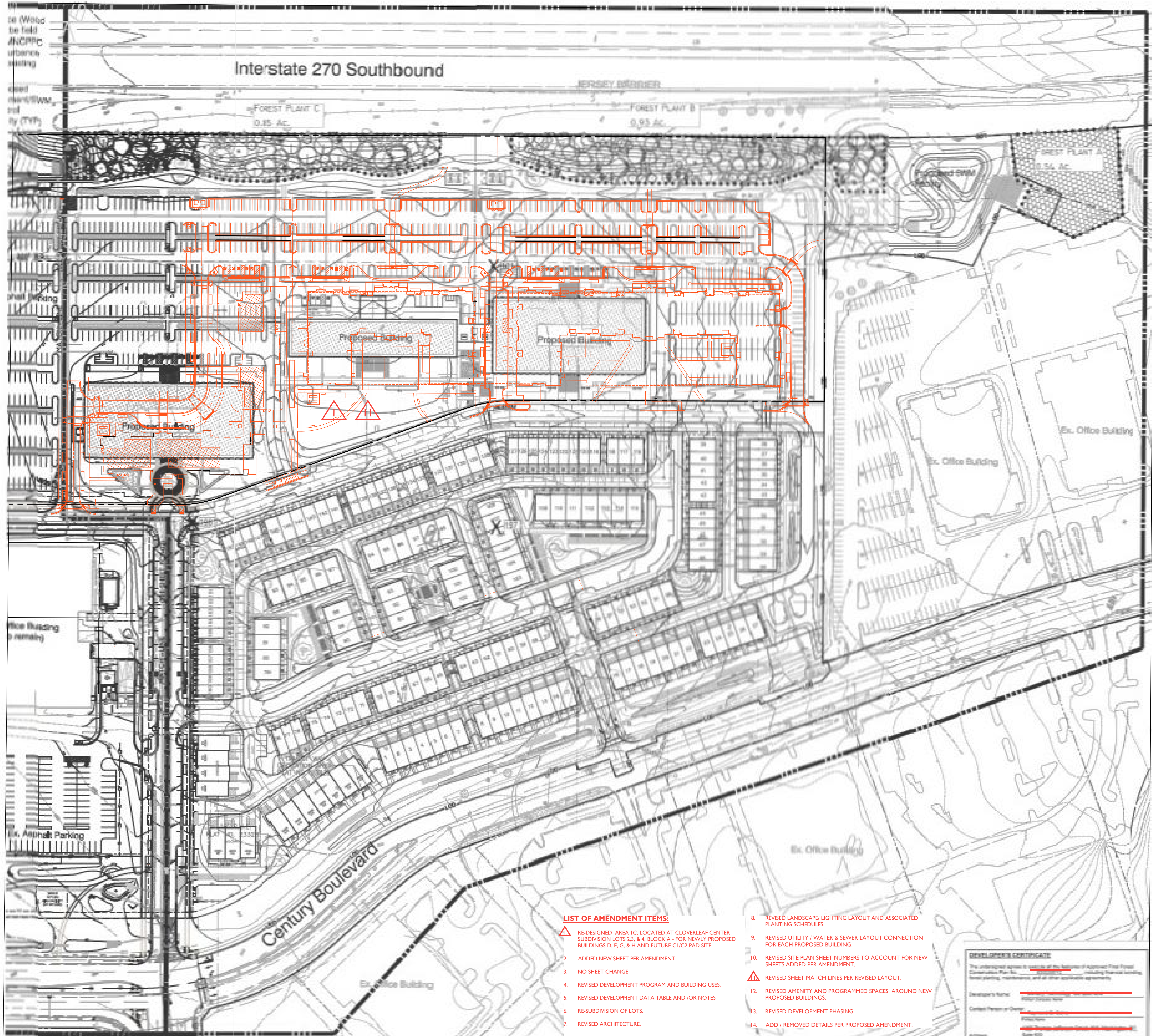

North arrow pointing upwards. Scale bar indicating 1" = 100'.

Legend

	10' Utility Easement
	20' Utility Easement
	30' Utility Easement
	40' Utility Easement
	50' Utility Easement
	60' Utility Easement
	75' Utility Easement
	100' Utility Easement
	150' Utility Easement
	200' Utility Easement
	300' Utility Easement
	400' Utility Easement
	500' Utility Easement
	600' Utility Easement
	750' Utility Easement
	1000' Utility Easement
	1500' Utility Easement
	2000' Utility Easement
	3000' Utility Easement
	4000' Utility Easement
	5000' Utility Easement
	6000' Utility Easement
	7500' Utility Easement
	10000' Utility Easement
	15000' Utility Easement
	20000' Utility Easement
	30000' Utility Easement
	40000' Utility Easement
	50000' Utility Easement

- LIST OF AMENDMENT ITEMS:**
1. RE-DESIGNED AREA 1C, LOCATED AT CLOVERLEAF CENTER SUBDIVISION LOTS 2,3, & 4, BLOCK A - FOR NEWLY PROPOSED BUILDINGS D, E, G, & H AND FUTURE C1/C2 PAD SITE.
 2. ADDED NEW SHEET PER AMENDMENT
 3. NO SHEET CHANGE
 4. REVISED DEVELOPMENT PROGRAM AND BUILDING USES.
 5. REVISED DEVELOPMENT DATA TABLE AND /OR NOTES
 6. RE-SUBDIVISION OF LOTS.
 7. REVISED ARCHITECTURE.
 8. REVISED LANDSCAPE / LIGHTING LAYOUT AND ASSOCIATED PLANTING SCHEDULES.
 9. REVISED UTILITY / WATER & SEWER LAYOUT CONNECTION FOR EACH PROPOSED BUILDING.
 10. REVISED SITE PLAN SHEET NUMBERS TO ACCOUNT FOR NEW SHEETS ADDED PER AMENDMENT.
 11. REVISED SHEET MATCH LINES PER REVISED LAYOUT.
 12. REVISED AMENITY AND PROGRAMMED SPACES AROUND NEW PROPOSED BUILDINGS.
 13. REVISED DEVELOPMENT PHASING.
 14. ADD / REMOVED DETAILS PER PROPOSED AMENDMENT.



CENTURY
Site Plan Amendment
 # 820000007/F

Cloverleaf Center - Parcel AA
 Election District (No. 3) - Craven, Montgomery County, Maryland

DATE

DATE	DESCRIPTION
01.10.2013	PRELIMINARY SITE PLAN
02.10.2013	FINAL SITE PLAN
03.10.2013	PRELIMINARY SITE PLAN
04.10.2013	FINAL SITE PLAN
05.10.2013	PRELIMINARY SITE PLAN
06.10.2013	FINAL SITE PLAN
07.10.2013	PRELIMINARY SITE PLAN
08.10.2013	FINAL SITE PLAN
09.10.2013	PRELIMINARY SITE PLAN
10.10.2013	FINAL SITE PLAN
11.10.2013	PRELIMINARY SITE PLAN
12.10.2013	FINAL SITE PLAN
13.10.2013	PRELIMINARY SITE PLAN
14.10.2013	FINAL SITE PLAN
15.10.2013	PRELIMINARY SITE PLAN
16.10.2013	FINAL SITE PLAN
17.10.2013	PRELIMINARY SITE PLAN
18.10.2013	FINAL SITE PLAN
19.10.2013	PRELIMINARY SITE PLAN
20.10.2013	FINAL SITE PLAN
21.10.2013	PRELIMINARY SITE PLAN
22.10.2013	FINAL SITE PLAN
23.10.2013	PRELIMINARY SITE PLAN
24.10.2013	FINAL SITE PLAN
25.10.2013	PRELIMINARY SITE PLAN
26.10.2013	FINAL SITE PLAN
27.10.2013	PRELIMINARY SITE PLAN
28.10.2013	FINAL SITE PLAN
29.10.2013	PRELIMINARY SITE PLAN
30.10.2013	FINAL SITE PLAN
31.10.2013	PRELIMINARY SITE PLAN
01.11.2013	FINAL SITE PLAN
02.11.2013	PRELIMINARY SITE PLAN
03.11.2013	FINAL SITE PLAN
04.11.2013	PRELIMINARY SITE PLAN
05.11.2013	FINAL SITE PLAN
06.11.2013	PRELIMINARY SITE PLAN
07.11.2013	FINAL SITE PLAN
08.11.2013	PRELIMINARY SITE PLAN
09.11.2013	FINAL SITE PLAN
10.11.2013	PRELIMINARY SITE PLAN
11.11.2013	FINAL SITE PLAN
12.11.2013	PRELIMINARY SITE PLAN
13.11.2013	FINAL SITE PLAN
14.11.2013	PRELIMINARY SITE PLAN
15.11.2013	FINAL SITE PLAN
16.11.2013	PRELIMINARY SITE PLAN
17.11.2013	FINAL SITE PLAN
18.11.2013	PRELIMINARY SITE PLAN
19.11.2013	FINAL SITE PLAN
20.11.2013	PRELIMINARY SITE PLAN
21.11.2013	FINAL SITE PLAN
22.11.2013	PRELIMINARY SITE PLAN
23.11.2013	FINAL SITE PLAN
24.11.2013	PRELIMINARY SITE PLAN
25.11.2013	FINAL SITE PLAN
26.11.2013	PRELIMINARY SITE PLAN
27.11.2013	FINAL SITE PLAN
28.11.2013	PRELIMINARY SITE PLAN
29.11.2013	FINAL SITE PLAN
30.11.2013	PRELIMINARY SITE PLAN
31.11.2013	FINAL SITE PLAN
01.12.2013	PRELIMINARY SITE PLAN
02.12.2013	FINAL SITE PLAN
03.12.2013	PRELIMINARY SITE PLAN
04.12.2013	FINAL SITE PLAN
05.12.2013	PRELIMINARY SITE PLAN
06.12.2013	FINAL SITE PLAN
07.12.2013	PRELIMINARY SITE PLAN
08.12.2013	FINAL SITE PLAN
09.12.2013	PRELIMINARY SITE PLAN
10.12.2013	FINAL SITE PLAN
11.12.2013	PRELIMINARY SITE PLAN
12.12.2013	FINAL SITE PLAN
13.12.2013	PRELIMINARY SITE PLAN
14.12.2013	FINAL SITE PLAN
15.12.2013	PRELIMINARY SITE PLAN
16.12.2013	FINAL SITE PLAN
17.12.2013	PRELIMINARY SITE PLAN
18.12.2013	FINAL SITE PLAN
19.12.2013	PRELIMINARY SITE PLAN
20.12.2013	FINAL SITE PLAN
21.12.2013	PRELIMINARY SITE PLAN
22.12.2013	FINAL SITE PLAN
23.12.2013	PRELIMINARY SITE PLAN
24.12.2013	FINAL SITE PLAN
25.12.2013	PRELIMINARY SITE PLAN
26.12.2013	FINAL SITE PLAN
27.12.2013	PRELIMINARY SITE PLAN
28.12.2013	FINAL SITE PLAN
29.12.2013	PRELIMINARY SITE PLAN
30.12.2013	FINAL SITE PLAN
31.12.2013	PRELIMINARY SITE PLAN
01.01.2014	FINAL SITE PLAN

DEVELOPER'S CERTIFICATE

The undersigned hereby certifies that this is a true and correct copy of the Final Site Plan for the above project, and that it complies with all applicable laws, regulations, and all other applicable agreements.

Developer's Name: Century Environmental | Civil Co.

Project Name: Century Environmental | Civil Co. Project # 820000007/F

Date: 11/26/17

Signature: [Signature]

FOR LICENSED PROFESSIONAL ENGINEER ONLY
 MARYLAND STATE BOARD OF PROFESSIONAL ENGINEERS
 License No. 11774
 Signature: [Signature]
 Date: 11/26/17