

WSSC GRID 224 NW 01
VICINITY MAP
SCALE: 1" = 2000'
TAX MAP JT342

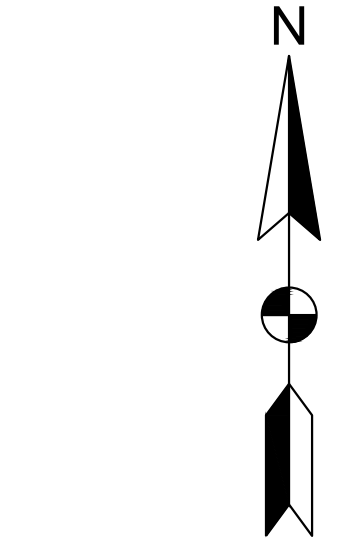
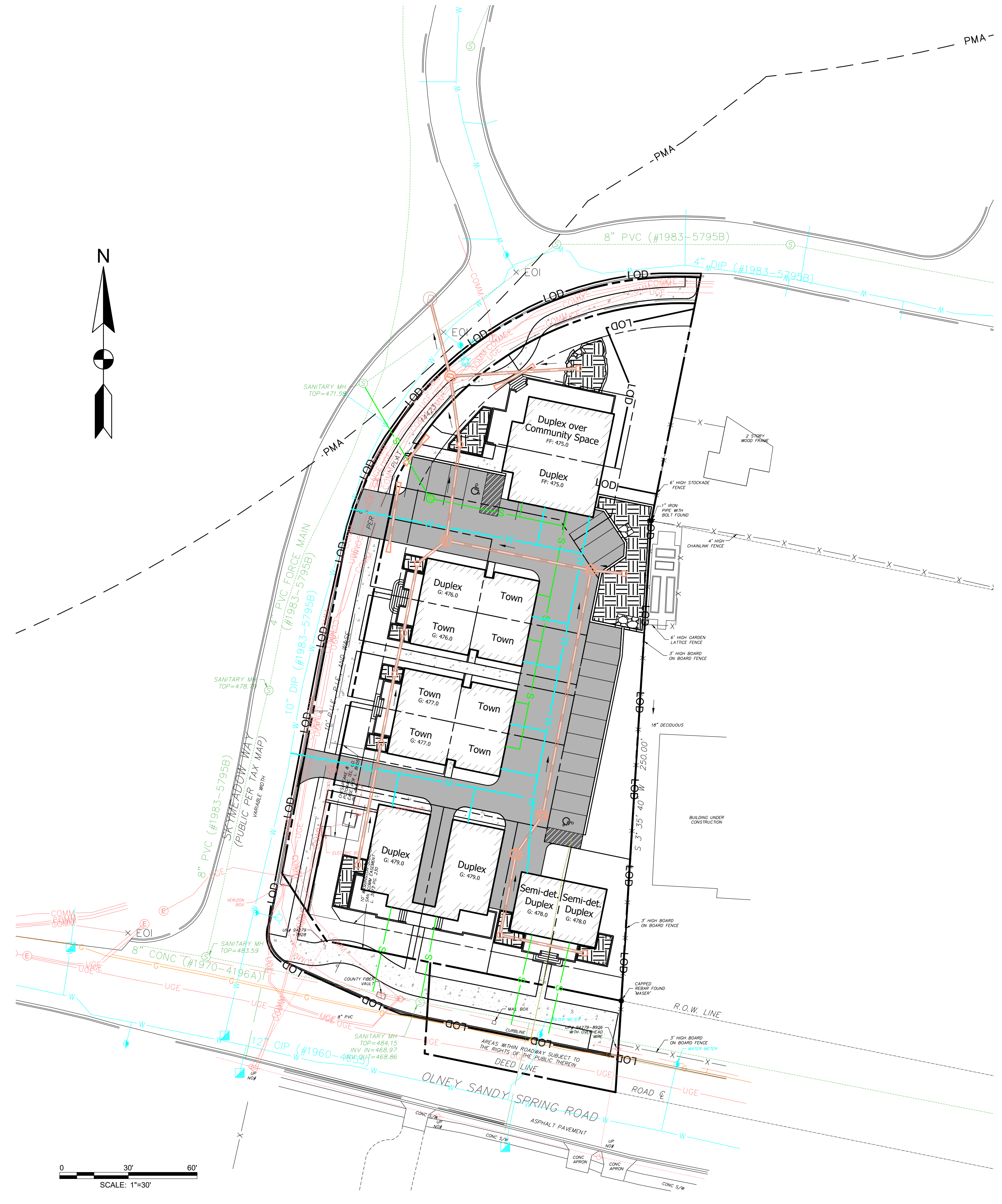

SCALE: 1"=30'

UTILITY LEGEND

EXISTING SANITARY	-----	PROPOSED WATER	—W—
EXISTING WATER	—W—	PROPOSED SEWER	—S—
EXISTING COMM.	—COMM—	PROP. STORM DRAIN	—SD—
EX. UNDERGROUND ELEC.	—UCE—	PROP. STORM STRUCTURE	⊙ ○
EXISTING GAS	—G—		

EXISTING CONDITIONS LEGEND

SIGN	⊕	AIR CONDITIONER	AC
STREET SIGN	⊕	BOTTOM OF CURB	BC
UTILITY POLE	⊙	BOTTOM OF STRUCTURE	BOT
LIGHT POLE	⊙	BOTTOM OF WALL	BW
HANDRAIL	---	CABLE/TV BOX	CATV
CHAIN LINK FENCE	-X-X-	DEPRESSED	DEP.
OVERHEAD WIRES	---	DIAMETER	DIA
WALL W/ FENCE	---	EDGE OF PAVEMENT	E.O.P.
CONCRETE PAD	CONC.	ELECTRIC	ELEC.
TREE	⊗	FILL OF WATER	F.O.W.
PARKING SPACE COUNT	④	FILLED WITH DEBRIS	F.W.D.
VAULT	⊕	GRASS AREA	GRASS
CONTOUR	---89---	INVERT	INV
SPOT ELEVATION	x 86.7	MISCELLANEOUS	MISC
STORM PIPE	---	RIGHT OF WAY	R.O.W.
CABLE BOX	⊕	TOP OF CURB	TC
ELECTRIC MANHOLE	⊕	TOP OF BELL ON PIPE	TOB
WATER VALVE	⊕	TOP OF DEBRIS	TOD
TELE. BOX	⊕	TERRA COTTA PIPE	T.C.
FIRE HYDRANT	⊕	TOP OF WALL	TW
MAIL BOX	⊕	TYPICAL	(TYP.)
[PARCEL 1] TITLE REPORT PARCEL NO.		UTILITY POLE	UP
		WATER VALVE	WV
		CONCRETE	CONC
		BUILDING RESTRICTION LINE	B.R.L.
		PUBLIC UTILITIES EASEMENT	P.U.E.
		PUBLIC IMPROVEMENT EASEMENT	P.I.E.
		WATER & SEWER EASEMENT	W&SE
		STORM DRAIN EASEMENT	S.D.E.

SITE LEGEND

CONCRETE PAVEMENT	▒	PROPOSED WATER	—W—
ASPHALT PAVEMENT	■	PROPOSED SEWER	—S—
SWM FACILITY	▒	PROP. STORM DRAIN	—SD—
PROPOSED BUILDING	▒	PROP. STORM STRUCTURE	⊙ ○
PROPOSED PROPERTY LINE	---	PROP. RETAINING WALL	---
PROPOSED LOT LINE	---	LIMIT OF DISTURBANCE	—LOD—

ENGINEER'S CERTIFICATION:
I HEREBY CERTIFY THAT THE INFORMATION SHOWN IS TAKEN FROM MASER CONSULTING (BOUNDARY SURVEY DATED 07/01/2014), MNCPPC (GIS DATA DOWNLOAD ON 05/01/2020), AND AVAILABLE PLANS AND RECORDS AND IS TRUE AND CORRECT TO THE BEST OF MY KNOWLEDGE AND BELIEF.

AARON SMITH
NAME
31196
MARYLAND REGISTRATION NUMBER
(E) R.L.S. OR R.L.A. (CIRCLE)

SIGNATURE
DATE

DEVELOPER'S CERTIFICATE
The undersigned agrees to execute all the features of the Site Plan Approval No. 820220090 including Approval Conditions, Development Program, and Certified Site Plan.

Developer: Housing Opportunities Commission Joy Shepherd
Company Contact Person

Address: 10400 Detrick Ave., Kensington, MD 20895

Phone: 240-627-9437

Signature: _____

SANDY SPRING MISSING MIDDLE PILOT PROJECT

17901 SKYMEADOW WAY
SANDY SPRING, MD 20860

OWNER

HOUSING OPPORTUNITIES COMMISSION
10400 DETRICK AVENUE
KENSINGTON, MD 20895
CONTACT: JAY SHEPHERD, (240) 627-9437

MARK	DATE	DESCRIPTION
------	------	-------------

PROJECT NO: 20-0166.002
SCALE: 1"=30'
DESIGNED BY: ABS
DRAWN BY: ASC
CHECKED BY: ABS
SHEET TITLE

COLOR-CODED UTILITY PLAN