

N 541.100
 E 1,304.815

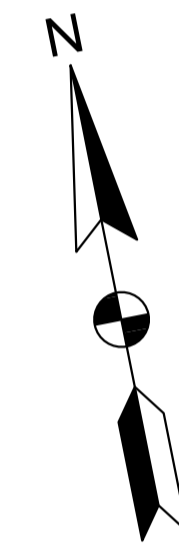

0 60' 120'
 SCALE: 1"=60'

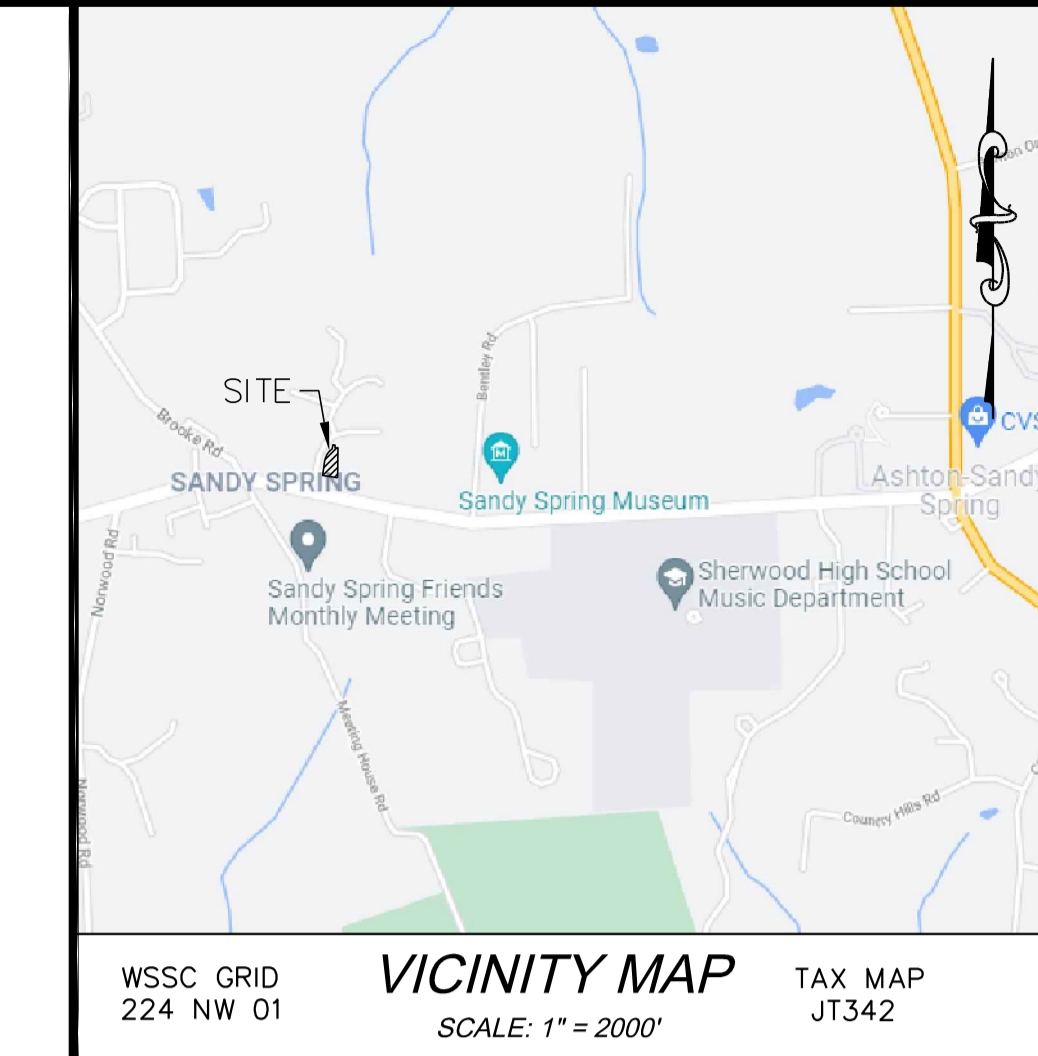

CONSULTANTS



"I HEREBY CERTIFY THAT THESE DOCUMENTS WERE PREPARED OR APPROVED BY ME, AND THAT I AM A DULY LICENSED PROFESSIONAL ENGINEER UNDER THE LAWS OF THE STATE OF MARYLAND, LICENSE NO. 31196, EXPIRATION DATE 1/16/2025."

SANDY SPRING MISSING MIDDLE PILOT PROJECT

17901 SKYMEADOW WAY
 SANDY SPRING, MD 20860

OWNER

HOUSING OPPORTUNITIES COMMISSION
 10400 DETRICK AVENUE
 KENSINGTON, MD 20895
 CONTACT: JAY SHEPHERD, (240) 627-9437

EXISTING LOT AREAS		
LOT #	AREA (SF)	AREA (AC)
PARCEL B	20948	0.48
617 OLNEY - SANDY SPRING RD	20908	0.48
7	9676	0.22
8	5682	0.13
9	7665	0.18
10	7873	0.18
11	5633	0.13
12	6380	0.15
13	5247	0.12
14	7380	0.17
15	7496	0.17
16	6539	0.15
17	6999	0.16
TOTAL	118426	2.72

ENGINEER'S CERTIFICATION:
 I HEREBY CERTIFY THAT THE INFORMATION SHOWN IS TAKEN FROM MASER CONSULTING (BOUNDARY SURVEY DATED 07/01/2014), MNCPPC (GIS DATA DOWNLOAD ON 05/01/2020), AND AVAILABLE PLANS AND RECORDS AND IS TRUE AND CORRECT TO THE BEST OF MY KNOWLEDGE AND BELIEF.

AARON SMITH
 SIGNATURE: *Aaron B. Smith*
 NAME: AARON SMITH
 MARYLAND REGISTRATION NUMBER: 31196
 DATE: 08/17/2023
 (P.E.) R.L.S. OR R.L.A. (CIRCLE)

MARK	DATE	DESCRIPTION

PROJECT NO:	20-0166.002
SCALE:	AS SHOWN
DESIGNED BY:	ABS
DRAWN BY:	ASC
CHECKED BY:	ABS
SHEET TITLE	

EXISTING LOTTING PLAN

VF-103

SHEET VALUE OF