

Approved Resolution (ENTER PROJECT NUMBER)

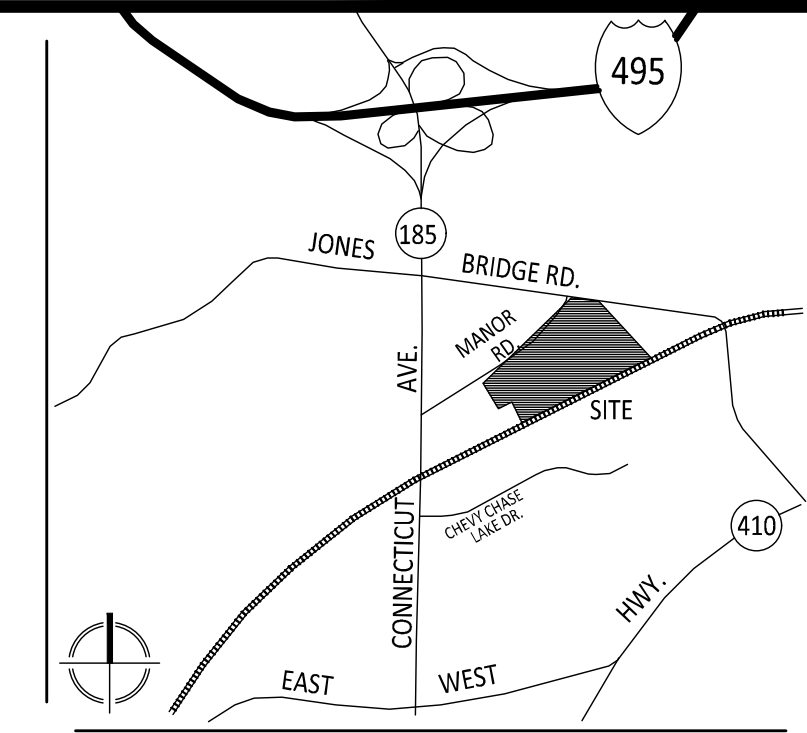

VICINITY MAP
SCALE: 1" = 2000'



VIKA MARYLAND, LLC
20251 Century Blvd., Suite 400
Germantown, MD 20874
301.916.4100 | vika.com

Our Site Set on the Future.

PREPARED FOR:
**TOLL MID-ATLANTIC LP
COMPANY, INC**
6731 COLUMBIA GATEWAY DRIVE
SUITE 120
COLUMBIA, MD, 21046
CONTACT: JEFFREY S. DRISCOLL
JDRISCOLL@TOLLBROTHERS.COM

DESIGN CONSULTANTS
**PLANNER, CIVIL ENGINEER
VIKA MARYLAND, LLC**
20251 CENTURY BOULEVARD
SUITE 400
GERMANTOWN MD, 20874
301.916.4100
CONTACT: JOSHUA SLOAN, RLA

**ATTORNEY
LERCH, EARLY & BREWER,
CHTD**
7600 WISCONSIN AVENUE
SUITE 700
BETHESDA MD, 20814
301.941.3832
CONTACT: PATRICIA A. HARRIS

REVISIONS REVISED PER DRC	DATE
	09/02/22

**PRESTON
PLACE AND LAKE
APARTMENTS**
7TH ELECTION DISTRICT
MONTGOMERY COUNTY,
MARYLAND
WSSC GRID: 210NW04
TAX MAP: HN43

**PLAN
APPROVALS**

SITE PLAN
#820220180

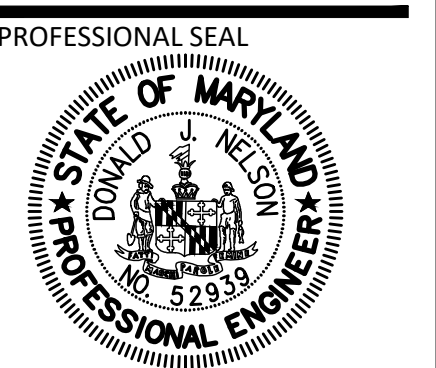

I HEREBY CERTIFY THAT THESE DOCUMENTS WERE PREPARED OR APPROVED BY ME, AND THAT I AM A DULY LICENSED PROFESSIONAL ENGINEER UNDER THE LAWS OF THE STATE OF MARYLAND. ENGINEER'S NAME: DONALD NELSON, P.E. LICENSE NO.: 5285 EXPIRATION DATE: JULY 11, 2024

THE INFORMATION, DESIGN AND CONTENT OF THESE DRAWINGS OR DOCUMENTS ARE PROPRIETARY TO VIKA MARYLAND, LLC AND CONSTITUTE ITS PROPRIETARY INTELLECTUAL PROPERTY. THESE DRAWINGS AND/OR DOCUMENTS MUST NOT BE REPRODUCED, COPIED, COPIES, DIGITALLY CONVERTED, MODIFIED OR USED FOR ANY PURPOSE, IN ANY FORMAT, WITHOUT PRIOR WRITTEN AUTHORIZATION FROM VIKA MARYLAND, LLC. VIOLATION MAY RESULT IN PROSECUTION. ONLY APPROVED, SIGNED AND SEALED PLANS OR DRAWINGS MAY BE UTILIZED FOR CONSTRUCTION PURPOSES.

© 2022 VIKA MARYLAND, LLC
DRAWN BY: _____
DESIGNED BY: _____
DATE ISSUED: 03/23/2022
VIKA PROJECT
DRAWING NO. SP-002
SHEET NO.

DEVELOPER'S CERTIFICATE

The undersigned agrees to execute all the features of the Site Plan Approval No. **820220180**, including Approval Conditions, Development Program and Certified Site Plan.

Developer's Name: TOLL MID-ATLANTIC LP COMPANY, INC

Contact Person: Jeffrey S. Driscoll

Address: 6731 Columbia Gateway Drive Suite 120 Columbia, MD 21046

Phone: 301-981-3263

Signature: _____ Date: _____

"FOR LOCATION OF UTILITIES CALL 8-1-1 or 1-800-257-7777 OR LOG ON TO www.call811.com or http://www.missutility.net 48 HOURS IN ADVANCE OF ANY WORK IN THIS VICINITY"

The excavator must notify all public utility companies with underground facilities in the area of proposed excavation and have those facilities located by the utility companies prior to commencing excavation. The excavator is responsible for compliance with requirements of Chapter 33A of the Montgomery County Code.