

LEGEND	
	EX. CONTOURS
	PROP. CONTOURS
	EX. BUILDING
	PROP. BUILDING (NON-RESIDENTIAL)
	EX. STREAM
	EX. CURB
	PROP. CURB
	PROP. FLUSH CURB
	PROP. MOUNTABLE CURB
	EX. SIDEWALK
	PROP. SIDEWALK
	EX. ELECTRIC
	EX. GAS
	EX. SEWER
	PROP. SEWER
	EX. WATER
	PROP. WATER
	EX. STORM DRAIN
	PROP. STORM DRAIN
	PROP. LIMIT OF DISTURBANCE
	EX. OVER HEAD WIRE
	EXISTING TREE LINE
	EX. FENCE
	LIMITS OF SITE PLAN AMENDMENT
	CAR SHARE PARKING SPACES
	CAR POOL PARKING SPACES
	ELECTRIC VEHICLE PARKING SPACES
	PROP. LIGHT POLE
	PROP. PARKING LOT LIGHT POLE

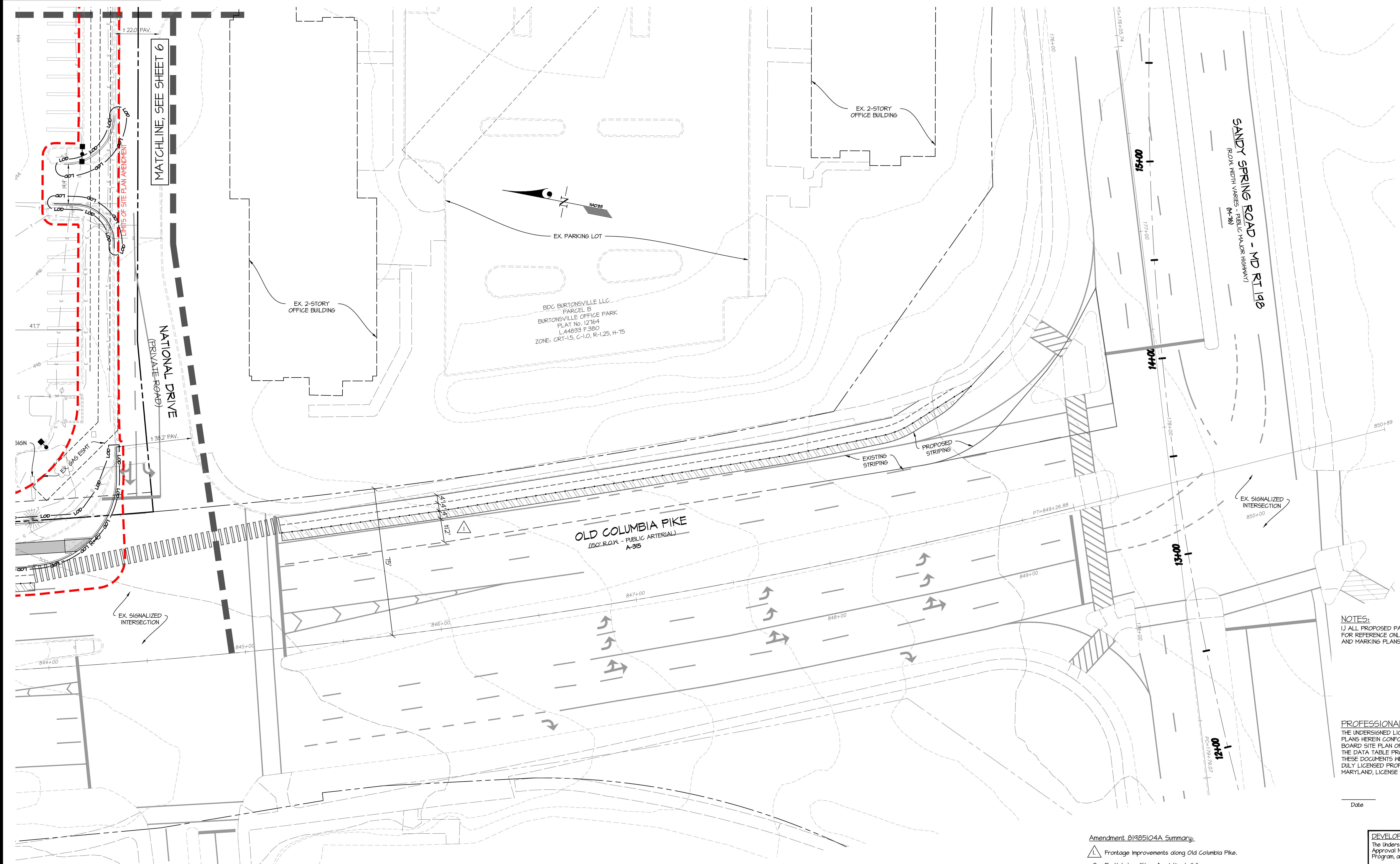

NOTES:
1) ALL PROPOSED PAVEMENT MARKINGS AND SIGNAGE ON PUBLIC STREETS ARE FOR REFERENCE ONLY AND WILL BE FINALIZED AT R/W PERMIT UNDER SIGNAGE AND MARKING PLANS.

PROFESSIONAL ENGINEER'S CERTIFICATION
THE UNDERSIGNED LICENSED PROFESSIONAL ENGINEER CERTIFIES THAT THE SITE PLANS HEREIN CONFORM TO THE STANDARDS OF THE ZONE, AND THE PLANNING BOARD SITE PLAN OPINION. IN ADDITION, THE SITE PLANS ARE CONSISTENT WITH THE DATA TABLE PROVIDED ON THE COVER SHEET. I HEREBY CERTIFY THAT THESE DOCUMENTS WERE PREPARED OR APPROVED BY ME, AND THAT I AM A DULY LICENSED PROFESSIONAL ENGINEER UNDER THE LAWS OF THE STATE OF MARYLAND, LICENSE No. 24914 EXPIRATION DATE: January 20, 2024.

Date _____
Tim M. Longfellow
Professional Engineer
Gutschick, Little & Weber, P.A.

- Amendment 81985104A Summary:**
- Frontage improvements along Old Columbia Pike.
 - Partial demolition of existing buildings.
 - New Retail Buildings.
 - Parking Modifications and revisions to meet ADA requirements.
 - Updates to on-site lighting, landscape, pedestrian circulation and open space.

DEVELOPER'S CERTIFICATE
The undersigned agrees to execute all the features of the Site Plan Approval No. 81985104A, including Approval Conditions, Development Program, and Certified Site Plan.

Developer's Name: Burtonsville (E&A) LLC William Caldwell, Contact Person
Address: 1272 5th Street NE, Suite 200
Washington, DC 20002
Phone: (202) 902-2600
Signature: William Caldwell, Managing Director



GLW
PLANNING | ENGINEERING | SURVEYING

3909 NATIONAL DRIVE | SUITE 250 | BURTONSVILLE, MD 20896 | GLWPA.COM
PHONE: 301-421-4024 | BALT: 410-880-1850 | DC/VA: 301-489-2524 | FAX: 301-421-4188

DESIGNED BY	DATE	REVISION	BY	APPR.
KAB				
TML				

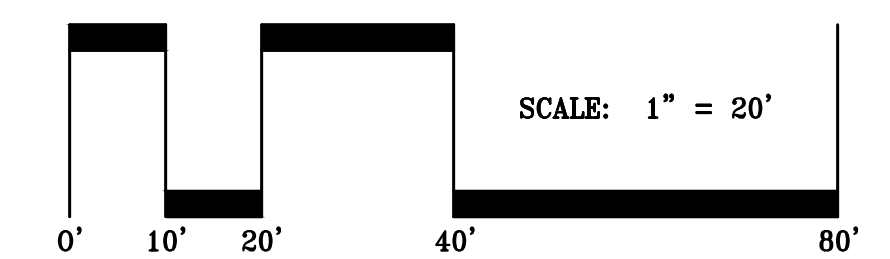

PREPARED FOR:
Burtonsville (E&A), LLC
1272 5th Street NE
Suite 200
Washington, DC 20002
Attn: Jim McKenney
202-902-2600

SCALE	ZONING
1"=20'	CRT-1.5 (C-1.0 R-1.25, H-7.5)
DATE	TAX MAP - GRID
JUNE 2022	K5-562

SITE PLAN

BURTONSVILLE CROSSING SHOPPING CENTER
PARCEL 'L' - BURTONSVILLE
Plat No. 16306
Deed Book 24792 Page 246

G. L. W. FILE No. **16028**

SHEET **11 OF 24**

COLESVILLE ELECTION DISTRICT No. 05 MONTGOMERY COUNTY, MARYLAND

L:\CAD\DRAWINGS\2022\PLANS BY GLW\SITE PLAN\2022 SP-06-11-SITE PLAN.dwg