

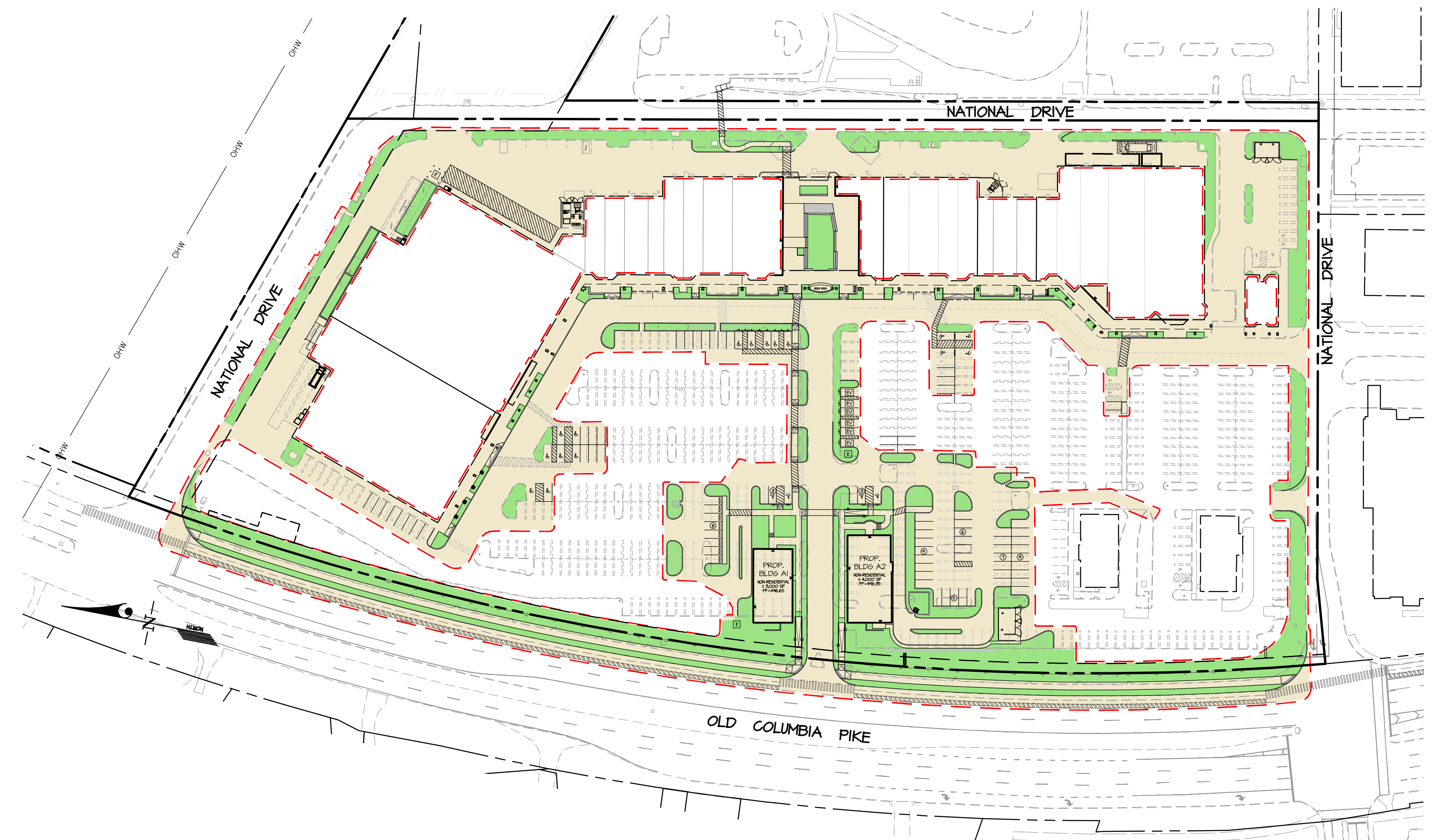

EXISTING IMPERVIOUS AREA  
82% IMPERVIOUS AREA WITHIN LIMITS OF SITE PLAN  
246,114 sf or 5.65 Ac.



PROPOSED IMPERVIOUS AREA  
14% IMPERVIOUS AREA WITHIN LIMITS OF SITE PLAN  
223,848 sf or 5.14 Ac.  
(IMPERVIOUS AREA DECREASED BY 8%)

		SITE IMPERVIOUS AREA
--- LIMITS OF SITE PLAN (L.O.S.)=	6.90 AC.	
EXISTING IMPERVIOUS AREA WITHIN L.O.S.=	5.65 AC.	82%
PROPOSED IMPERVIOUS WITHIN L.O.S.=	5.14 AC.	74%

SITE PLAN No. 81985104A

**GLW**  
PLANNING [ENGINEERING] SURVEYING

3809 NATIONAL DRIVE | SUITE 250 | BURTONSVILLE, MD 20896 | GLWPA.COM  
PHONE: 301-421-4024 | BALT: 410-880-1500 | DC/VA: 301-489-2524 | FAX: 301-421-4188

DESIGNED BY:				
DRAWN BY:	KAB			
CHECKED BY:				
TML				
DATE		REVISION	BY	APPR.

PREPARED FOR:  
Burtonsville (E&A), LLC  
1272 5th Street NE  
Suite 200  
Washington, DC 20002  
Attn: Jim McKenney  
202-902-2600

SCALE	ZONING
1"=80'	CRT-0.75 C-0.5, R-0.25, H-35T & R-90
DATE	TAX MAP - GRID
JUNE, 2022	K5-562

IMPERVIOUS AREA EXHIBIT  
**BURTONSVILLE CROSSING SHOPPING CENTER**  
PARCEL 'L' - BURTONSVILLE  
Plat No. 16306  
Deed Book 24792 Page 246

G. L. W. FILE No.  
**16028**  
SHEET  
1 OF 1

COLESVILLE ELECTION DISTRICT No. 05

MONTGOMERY COUNTY, MARYLAND

L:\CAD\DRAWINGS\2022\PLANS BY GLW\BIE PLANS\EXHIBITS\16028-impervious\_Area.dwg