

# PLANNING BOARD HEARING

On, **December 8, 2022**, the Montgomery County Planning Board will conduct an in person and virtual public hearing at 2425 Reddie Drive, Wheaton, Maryland on the following development plan:

**Name of Plan:** Burtonsville Shopping Center  
**Site Plan Amendment Number:** 81985104A  
**Zoning:** CRT-1.5, C-1.0, R-1.25, H-75 zone (reviewed under CRT-1.5 zone from previous Zoning Ordinance)  
**Property Size:** 6.90 acres (amendment area)  
**Master Plan:** 2012 Burtonsville Crossroads Neighborhood Plan  
**Proposed Use:** Amendment to allow for redeveloping the Burtonsville Shopping Center by demolishing 7,600 square feet of existing retail uses and relocating that retail square footage into two new pad sites with Drive-Thrus including improvements to open space, landscaping, lighting, and pedestrian circulation.

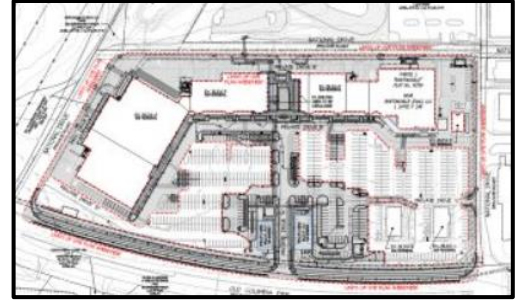

**Located** at 15701 Old Columbia Pike.

To review a written report by planners regarding the development plan, check the approximate hearing time, or to sign up to testify via Microsoft Teams, over the phone, or in person, go to our website at [montgomeryplanningboard.org/agendas/](http://montgomeryplanningboard.org/agendas/). To testify, you must fill out the [Sign Up to Testify](#) form on the website or call 301-495-4605 **by 12 noon on the day before the Planning Board meeting**. Any written materials must also be submitted by 12 noon the day before the Planning Board meeting by emailing to [mcp-chair@mncppc-mc.org](mailto:mcp-chair@mncppc-mc.org); faxing to 301-495-1320, or mailing to address on the back of this card. The public can watch the Planning Board hearing online via livestream at [www.montgomeryplanningboard.org](http://www.montgomeryplanningboard.org). For ADA accommodations or to request materials in alternate formats, please submit requests one week prior to the meeting date and consult <https://montgomeryplanning.org/accessibility/> or contact the Montgomery Planning ADA Coordinator at 301-495-1324 or 301-495-1331(TTY)| 7-1-1 or 800-552-7724 for MD Relay Service assistance.

For more information or to comment on the development plan, please contact Ryan Sigworth the Plan Reviewer via email at [Ryan.Sigworth@montgomeryplanning.org](mailto:Ryan.Sigworth@montgomeryplanning.org), or by phone at 301-495-2112.



Montgomery County Planning Department  
M-NCPPC  
2425 Reddie Drive  
Wheaton, MD 20902

## Montgomery County Planning Board HEARING NOTICE

[Burtonsville Shopping Center  
Site Plan Amendment  
December 8, 2022](#)

(view additional information on the back of this card)

Written comments should include the agenda item and must be received by **12 noon on Wednesday** before a scheduled Thursday hearing. They may be emailed to Montgomery County Planning Board Chair at [mcp-chair@mncppc-mc.org](mailto:mcp-chair@mncppc-mc.org); mailed to Montgomery County Planning Board, 2425 Reddie Drive, Wheaton, MD 20902; or faxed to (301) 495-1320.

Written comments received after the deadline may not be considered by the Planning Board or be included in the public record unless the Chair leaves the record open.

Name 1	Name 2	Department	Address1	Address2	City	State	PostalCode
Burtonsville (E&A) LLC			PO Box 528		Columbia	SC	29202-0528
BDC Burtonsville LLC			5301 Wisconsin Ave., N.W.	Suite 500	Washington	DC	20015
Potomac Electric Power Co.		c/o Corporate Tax Dept.	701 9th St., NW	Suite 5617	Washington	DC	20068-0001
Burtonsville (E&A) LLC			PO Box 528		Columbia	SC	29202-0528
Montgomery County		c/o GFS Realty Inc.	PO Box 1804	Dept. 671	Washington	DC	20013
Cloverly/Fairland/White Oak CAC	Dan Wilhelm		904 Cannon Road		Colesville	MD	20904
Cloverly/Fairland/White Oak CAC	Quentin Remein		201 Bryants Nursery Rd		Silver Spring	MD	20905
East County Citizens Advisory Board	Rachel Evans	Chair	3300 Briggs Chaney Road		Silver Spring	MD	20904
Greater Ashton Community Association	Susan Berkheimer	Secretary	4805 Brightwood Circle		Olney	MD	20832
Montgomery County Renters Alliance	William Roberts, Esq	Chair - Treasurer	P.O. Box 7773-7773		Silver Spring	MD	20907
Northern Montgomery County Alliance	Julius Cinque	Chair	22300 Slidell Road		Boysd	MD	20841
Patuxent Watershed Protective Assn.	Chamberlain Donald	Representative	4624 Dustin Rd		Burtonsville	MD	20866
Patuxent Watershed Protective Assn.	James Putman	Treasurer	4617 Dustin Rd		Burtonsville	MD	20866
Patuxent Watershed Protective Assn.	Luigi Faustini	President	4505 Dustin Rd		Burtonsville	MD	20866
Santini Road Property Owners Association	Lois Peters	President	15620 Santini Road		Burtonsville	MD	20866
Sierra Club - Montgomery County Group	Jennifer Rossmere	Treasurer	P O Box 4024		Rockville	MD	20849
Timber Hill Civic Association	George Krouse	President	4540 Dustin Road		Burtonsville	MD	20866
M-NCPPC	Intake & Regulatory Coordination Division		2425 Reedie Dr.	14th Fl.	Wheaton	MD	20902
Miles & Stockbridge, PC	Erin E. Girard, Esq.		11 N. Washington St.	Suite 700	Rockville	MD	20850
Gutschick, Little & Weber, PA	Kevin A. Foster		3909 National Drive	Suie 250	Burtonsville	MD	20866
Gutschick, Little & Weber, PA	Tim M. Longfellow		3909 National Drive	Suite 250	Burtonsville	MD	20866
EDENS	Jim McKenney		1272 5th Street, NE	Suite 200	Washington	DC	20002
EDENS	Ryan Lorey		1272 5th Street, NE	Suite 200	Washington	DC	20002
EDENS	David Germakian		1272 5th Street, NE	Suite 200	Washington	DC	20002