

Certified Site Plan  
 File No.  
 Montgomery County Planning Board Approval  
 Chair or Designee: \_\_\_\_\_ Date: \_\_\_\_\_

- NOTES:**
- DRAWINGS ARE CONCEPTUAL ONLY AND REPRESENT PROPOSED DEVELOPMENT IN AN ILLUSTRATIVE MANNER. FINAL BUILDING LOCATIONS, DIMENSIONS, HEIGHTS, USES, PHASING, DENSITY, PARKING, UNIT MIX, DEVELOPMENT STANDARDS AND PROGRAMS SHALL BE DETERMINED AT TIME OF SITE PLAN APPLICATIONS
  - INTERIOR PARTITIONS, INCLUDING CORE LAYOUT, THE NUMBER AND SIZE OF TENANT SPACES, STAIRS, ELEVATORS, TOILET AND LOCKER ROOMS, STRUCTURAL ELEMENTS, AND FACADE ARTICULATION ARE PRELIMINARY AND SHOWN FOR ILLUSTRATIVE PURPOSES ONLY. FINAL LAYOUTS MAY VARY.
  - REFER TO CIVIL AND LANDSCAPE DOCUMENTS FOR EXTERIOR IMPROVEMENTS.
  - LAYOUT OF LONG TERM BIKE STORAGE FACILITY AND EQUIPMENT SELECTION ARE PRELIMINARY. FINAL LAYOUT AND SELECTIONS MAY VARY.
  - LONG TERM BIKE STORAGE FACILITY TO BE EQUIPPED WITH AT LEAST ONE OUTLET FOR EVERY FIVE SPACES, DISTRIBUTED EVENLY.
  - DOORS ACCESSING LONG TERM BIKE STORAGE FACILITY WILL BE EQUIPPED WITH PUSH BUTTON OPERATORS.

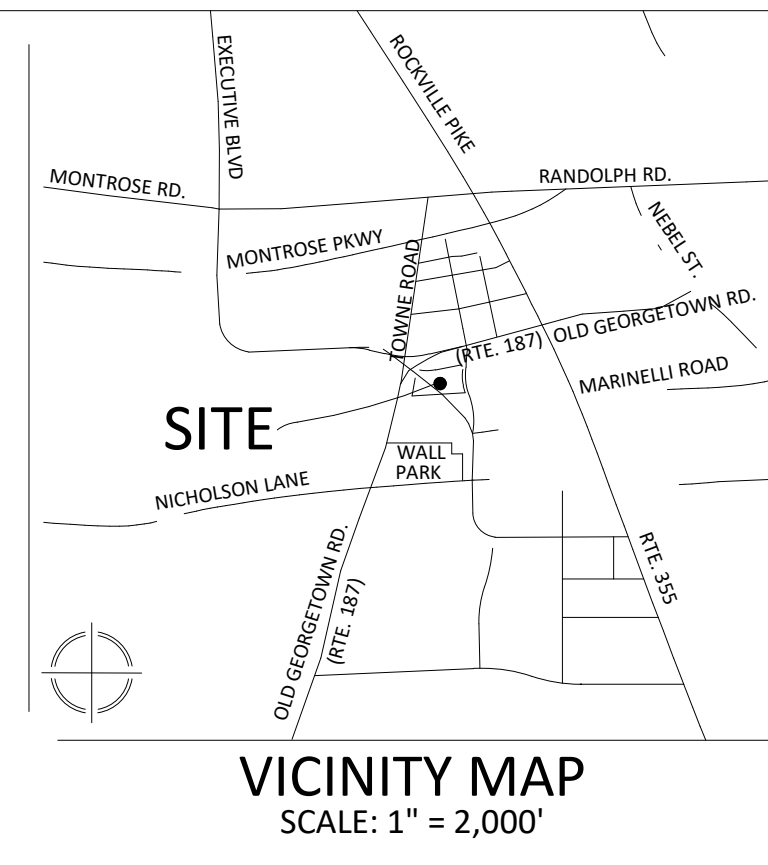

**VIKA MARYLAND, LLC**  
 20251 Century Blvd., Suite 400  
 Germantown, MD 20874  
 301.916.4100 | vika.com  
 Our Site Set on the Future.

PREPARED FOR:  
**STONEBRIDGE**  
 301.321.3202  
 SMITH@STONEBRIDGE.US.COM

ATTORNEY:  
**SELZER GURVITCH RABIN WERTHEIMER & POLOTT, P.C.**  
 301.634.3150  
 MATT GORDON

ARCHITECTS:  
**EWINGCOLE**  
 215.625.4411  
 BRETT SPEARMAN

LANDSCAPE ARCHITECT :  
**MAHAN RYKIEL ASSOCIATES, INC.**  
 410.900.1626  
 JINGPENG GU, PLA, ASLA

TRAFFIC ENGINEER :  
**WELLS + ASSOCIATES**  
 301.971.3415  
 NANCY RANDALL

DRY UTILITY CONSULTANT :  
**RICHTER & ASSOCIATES**  
 301.548.7475  
 JOHN O'BOYLE

CIVIL ENGINEER :  
**VIKA MARYLAND, LLC**  
 301.916.4100  
 JASON EVANS, P.E.

LAND PLANNER :  
**VIKA MARYLAND, LLC**  
 301.916.4100  
 IAN P. DUKE

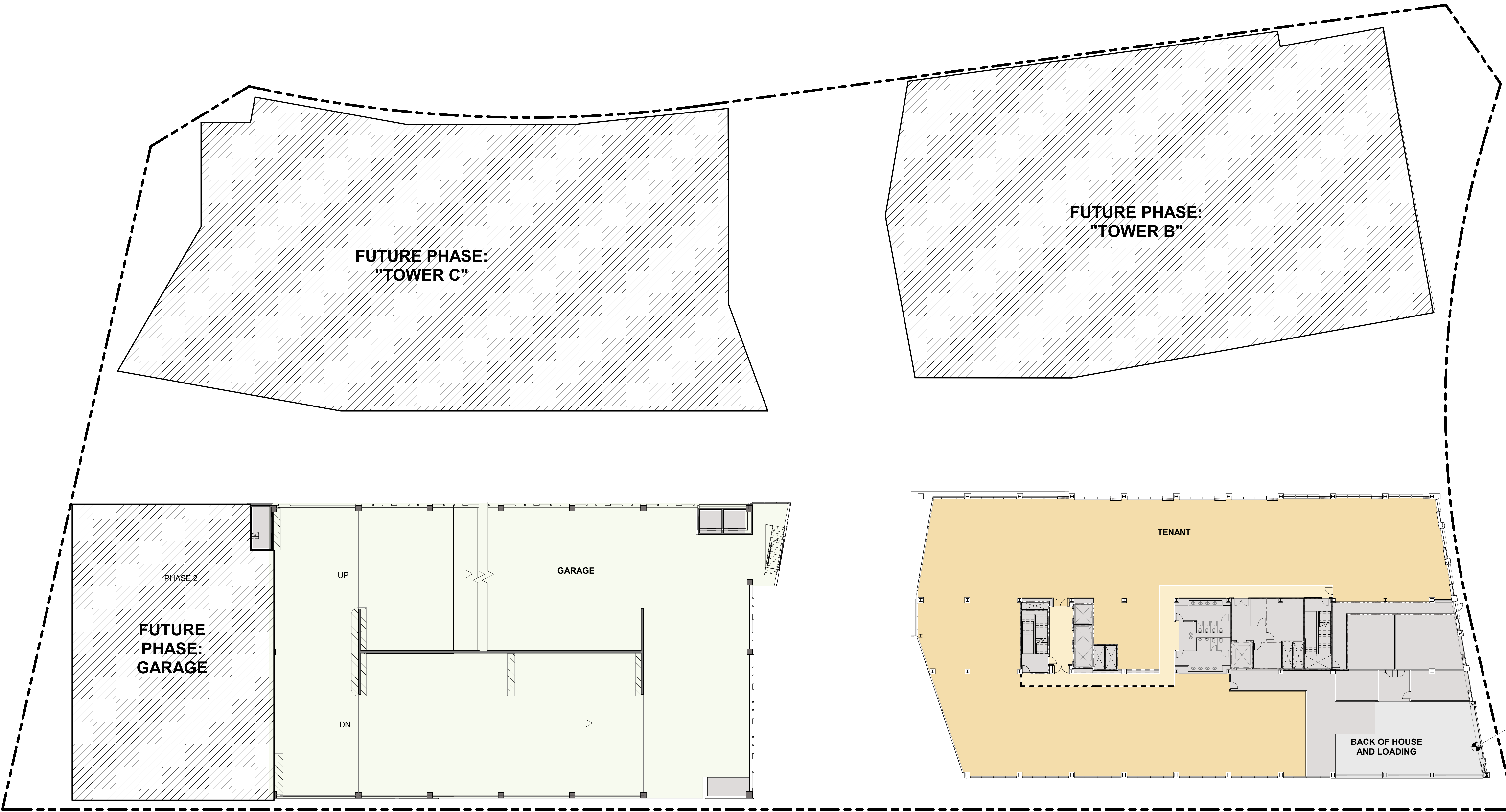

REVISIONS	DATE

**EvolutionLabs North Bethesda**  
 1st ELECTION DISTRICT  
 MONTGOMERY COUNTY,  
 MARYLAND  
 WSSC GRID: 215NW06  
 TAX MAP: GG62  
**82015001B**  
 ILLUSTRATIVE FLOOR PLAN



1 SITE PLAN - ILLUSTRATIVE SECOND FLOOR PLAN  
 SCALE: 1" = 20'-0"

FOR LOCATION OF UTILITIES CALL  
 8-1-1 or 1-800-257-7777 OR LOG ON TO  
 www.call11.com or http://www.missutility.net  
 48 HOURS IN ADVANCE OF ANY  
 WORK IN THIS VICINITY

**DEVELOPER'S CERTIFICATE**

THE UNDERSIGNED AGREES TO EXECUTE ALL THE FEATURES OF THE SITE PLAN APPROVAL NO. 82015001B, INCLUDING APPROVAL CONDITIONS, DEVELOPMENT PROGRAM AND CERTIFIED SITE PLAN

DEVELOPER'S NAME: \_\_\_\_\_  
 DRAWN BY: WJS  
 DESIGNED BY: BS  
 DATE ISSUED: 1/31/2023

CONTACT PERSON OR OWNER: \_\_\_\_\_  
 ADDRESS: \_\_\_\_\_  
 PHONE & E-MAIL: \_\_\_\_\_  
 SIGNATURE: \_\_\_\_\_

PREPARED OR APPROVED BY ME AND THAT I AM A DULY LICENSED PROFESSIONAL ARCHITECT UNDER THE LAWS OF THE STATE OF MARYLAND, LICENSE NO. 19863, EXPIRATION DATE: 10/28/22

THE INFORMATION, DESIGN AND CONTENT OF THESE DRAWINGS OR DOCUMENTS ARE PROPRIETARY TO VIKA MARYLAND, LLC AND CONSTITUTE ITS PROPRIETARY INTELLECTUAL PROPERTY. THESE DRAWINGS AND/OR DOCUMENTS MUST NOT BE FORWARDED, SHARED, COPIED, DIGITALLY CONVERTED, REPRODUCED OR USED FOR ANY PURPOSE, IN ANY FORMAT, WITHOUT PRIOR WRITTEN AUTHORIZATION FROM VIKA MARYLAND, LLC. VIOLATIONS MAY RESULT IN PROSECUTION. ONLY APPROVED, SIGNED AND SEALED PAPER OR DRAWINGS MAY BE UTILIZED FOR CONSTRUCTION PURPOSES.

© 2023 VIKA MARYLAND, LLC  
 VIKA PROJECT **VM1614**  
 EC PROJECT 20210623  
 DRAWING NO.  
 SHEET NO. Z-A101