

Certified Site Plan  
 File No.  
**Montgomery County Planning Board Approval**  
 Chair or Designee: \_\_\_\_\_ Date: \_\_\_\_\_

**NOTES:**

1. DRAWINGS ARE CONCEPTUAL ONLY AND REPRESENT PROPOSED DEVELOPMENT IN AN ILLUSTRATIVE MANNER. FINAL BUILDING LOCATIONS, DIMENSIONS, HEIGHTS, USES, PHASING, DENSITY, PARKING, UNIT MIX, DEVELOPMENT STANDARDS AND PROGRAMS SHALL BE DETERMINED AT TIME OF SITE PLAN APPLICATIONS
2. INTERIOR PARTITIONS, INCLUDING CORE LAYOUT, THE NUMBER AND SIZE OF TENANT SPACES, STAIRS, ELEVATORS, TOILET AND LOCKER ROOMS, STRUCTURAL ELEMENTS, AND FACADE ARTICULATION ARE PRELIMINARY AND SHOWN FOR ILLUSTRATIVE PURPOSES ONLY. FINAL LAYOUTS MAY VARY.
3. REFER TO CIVIL AND LANDSCAPE DOCUMENTS FOR EXTERIOR IMPROVEMENTS.
4. LAYOUT OF LONG TERM BIKE STORAGE FACILITY AND EQUIPMENT SELECTION ARE PRELIMINARY. FINAL LAYOUT AND SELECTIONS MAY VARY.
5. LONG TERM BIKE STORAGE FACILITY TO BE EQUIPPED WITH AT LEAST ONE OUTLET FOR EVERY FIVE SPACES, DISTRIBUTED EVENLY.
6. DOORS ACCESSING LONG TERM BIKE STORAGE FACILITY WILL BE EQUIPPED WITH PUSH BUTTON OPERATORS.

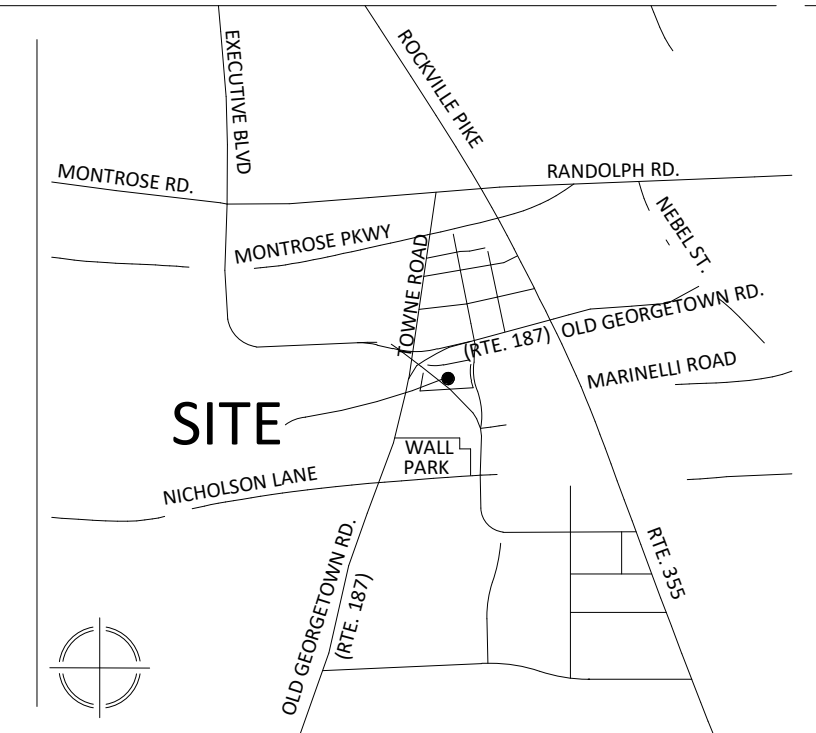

**VICINITY MAP**  
 SCALE: 1" = 2,000'



**VKA MARYLAND, LLC**  
 20251 Century Blvd., Suite 400  
 Germantown, MD 20874  
 301.916.4100 | vka.com  
 Our Site Set on the Future.

PREPARED FOR:  
**STONEBRIDGE**  
 301.321.3202  
 SMITH@STONEBRIDGE.US.COM

ATTORNEY:  
**SELZER GURVITCH RABIN WERTHEIMER & POLOTT, P.C.**  
 301.634.3150  
 MATT GORDON

ARCHITECTS:  
**EWINGCOLE**  
 215.625.4411  
 BRETT SPEARMAN

LANDSCAPE ARCHITECT :  
**MAHAN RYKIEL ASSOCIATES, INC.**  
 410.900.1626  
 JINGPENG GU, PLA, ASLA

TRAFFIC ENGINEER :  
**WELLS + ASSOCIATES**  
 301.971.3415  
 NANCY RANDALL

DRY UTILITY CONSULTANT :  
**RICHTER & ASSOCIATES**  
 301.548.7475  
 JOHN O'BOYLE

CIVIL ENGINEER :  
**VKA MARYLAND, LLC**  
 301.916.4100  
 JASON EVANS, P.E.

LAND PLANNER :  
**VKA MARYLAND, LLC**  
 301.916.4100  
 IAN P. DUKE

REVISIONS	DATE

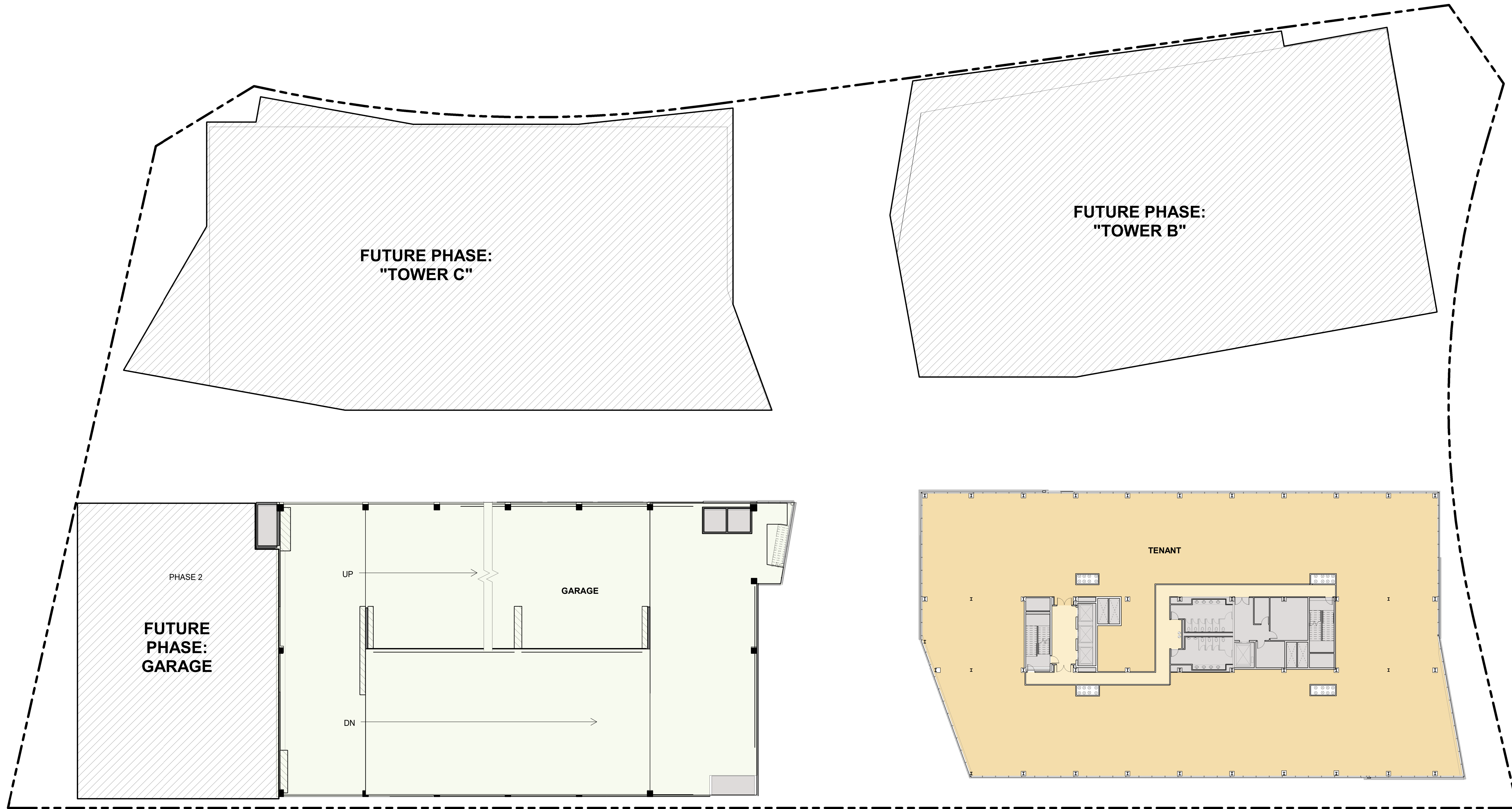

**EvolutionLabs North Bethesda**

1st ELECTION DISTRICT  
 MONTGOMERY COUNTY,  
 MARYLAND  
 WSSC GRID: 215NW06  
 TAX MAP: GQ62

**82015001B**

ILLUSTRATIVE FLOOR PLAN



1  
 PREPARED OR APPROVED BY ME AND 12/22/22  
 DULY LICENSED PROFESSIONAL ARCHITECT UNDER THE LAWS OF THE STATE OF MARYLAND, LICENSE NO. 19663, EXPIRATION DATE: 10/2026

THE INFORMATION, DESIGN AND CONTENT OF THESE DRAWINGS OR DOCUMENTS ARE PROPRIETARY TO VKA MARYLAND, LLC AND CONSTITUTE ITS PROPRIETARY INTELLECTUAL PROPERTY. THESE DRAWINGS AND/OR DOCUMENTS MUST NOT BE FORWARDED, SHARED, COPIED, DIGITALLY CONVERTED, REPRODUCED OR USED FOR ANY PURPOSE, IN ANY FORMAT, WITHOUT PRIOR WRITTEN AUTHORIZATION FROM VKA MARYLAND, LLC. VIOLATIONS MAY RESULT IN PROSECUTION. ONLY APPROVED, SIGNED AND SEALED PAPER OR DRAWINGS MAY BE UTILIZED FOR CONSTRUCTION PURPOSES.

© 2019 VKA MARYLAND, LLC  
 DRAWN BY: WJS  
 DESIGNED BY: BS  
 DATE ISSUED: 12/22/2022  
 VKA PROJECT VM1614  
 EC PROJECT 20210623  
 DRAWING NO.

SHEET NO. Z-A103

**1 SITE PLAN - ILLUSTRATIVE TYPICAL FLOOR PLAN**  
 SCALE: 1" = 20'-0"

"FOR LOCATION OF UTILITIES CALL 8-1-1 or 1-800-257-7777 OR LOG ON TO www.call811.com or http://www.missutility.net 48 HOURS IN ADVANCE OF ANY WORK IN THIS VICINITY"