

Certified Site Plan
 File No.
 Montgomery County Planning Board Approval

Chair or Designee: _____ Date: _____

NOTES:

- DRAWINGS ARE CONCEPTUAL ONLY AND REPRESENT PROPOSED DEVELOPMENT IN AN ILLUSTRATIVE MANNER. FINAL BUILDING LOCATIONS, DIMENSIONS, HEIGHTS, USES, PHASING, DENSITY, PARKING, UNIT MIX, DEVELOPMENT STANDARDS AND PROGRAMS SHALL BE DETERMINED AT TIME OF SITE PLAN APPLICATIONS.
- INTERIOR PARTITIONS, INCLUDING CORE LAYOUT, THE NUMBER AND SIZE OF TENANT SPACES, STAIRS, ELEVATORS, TOILET AND LOCKER ROOMS, STRUCTURAL ELEMENTS, AND FACADE ARTICULATION ARE PRELIMINARY AND SHOWN FOR ILLUSTRATIVE PURPOSES ONLY. FINAL LAYOUTS MAY VARY.
- REFER TO CIVIL AND LANDSCAPE DOCUMENTS FOR EXTERIOR IMPROVEMENTS.
- LAYOUT OF LONG TERM BIKE STORAGE FACILITY AND EQUIPMENT SELECTION ARE PRELIMINARY. FINAL LAYOUT AND SELECTIONS MAY VARY.
- LONG TERM BIKE STORAGE FACILITY TO BE EQUIPPED WITH AT LEAST ONE OUTLET FOR EVERY FIVE SPACES, DISTRIBUTED EVENLY.
- DOORS ACCESSING LONG TERM BIKE STORAGE FACILITY WILL BE EQUIPPED WITH PUSH BUTTON OPERATORS.

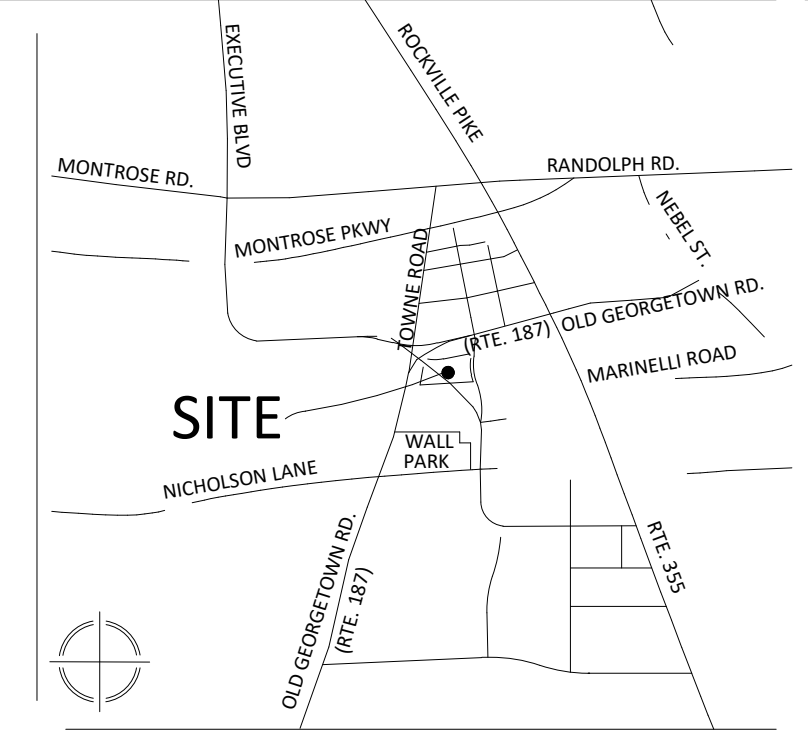

VICINITY MAP
 SCALE: 1" = 2,000'

VIA MARYLAND, LLC
 20251 Century Blvd., Suite 400
 Germantown, MD 20874
 301.916.4100 | via.com
 Our Site Set on the Future.

PREPARED FOR:
 STONEBRIDGE
 301.321.3202
 SMITH@STONEBRIDGE.US.COM

ATTORNEY:
 SELZER GURVITCH RABIN WERTHEIMER & POLOTT, P.C.
 301.634.3150
 MATT GORDON

ARCHITECTS:
 EWINGCOLE
 215.625.4411
 BRETT SPEARMAN

LANDSCAPE ARCHITECT :
 MAHAN RYKIEL ASSOCIATES, INC.
 410.900.1626
 JINGPENG GU, PLA, ASLA

TRAFFIC ENGINEER :
 WELLS + ASSOCIATES
 301.971.3415
 NANCY RANDALL

DRY UTILITY CONSULTANT :
 RICHTER & ASSOCIATES
 301.548.7475
 JOHN O'BOYLE

CIVIL ENGINEER :
 VIKI MARYLAND, LLC
 301.916.4100
 JASON EVANS, P.E.

LAND PLANNER :
 VIKI MARYLAND, LLC
 301.916.4100
 IAN P. DUKE

REVISIONS	DATE

EvolutionLabs North Bethesda

1st ELECTION DISTRICT
 MONTGOMERY COUNTY, MARYLAND
 WSSC GRID: 215NW06
 TAX MAP: GQ62

82015001B

ILLUSTRATIVE FLOOR PLAN

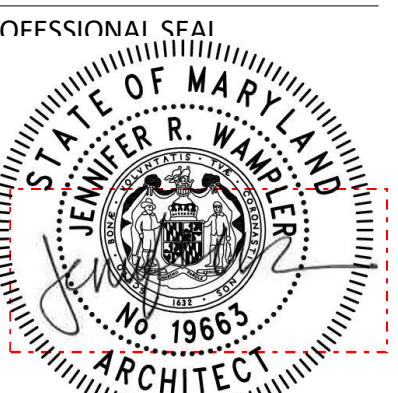

PREPARED OR APPROVED BY ME AND THAT I AM A DULY LICENSED PROFESSIONAL ARCHITECT UNDER THE LAWS OF THE STATE OF MARYLAND, LICENSE NO. 19863, EXPIRATION DATE: 10/2026

THE INFORMATION, DESIGN AND CONTENT OF THESE DRAWINGS OR DOCUMENTS ARE PROPRIETARY TO VIA MARYLAND, LLC AND CONSTITUTE ITS PROPRIETARY INTELLECTUAL PROPERTY. THESE DRAWINGS AND/OR DOCUMENTS MUST NOT BE FORWARDED, SHARED, COPIED, DIGITALLY CONVERTED, REPRODUCED OR USED FOR ANY PURPOSE, IN ANY FORMAT, WITHOUT PRIOR WRITTEN AUTHORIZATION FROM VIA MARYLAND, LLC. VIOLATIONS MAY RESULT IN PROSECUTION. ONLY APPROVED, SIGNED AND SEALED PAPER OR DRAWINGS MAY BE UTILIZED FOR CONSTRUCTION PURPOSES.

© 2019 VIA MARYLAND, LLC

DEVELOPER'S CERTIFICATE
 THE UNDERSIGNED AGREES TO EXECUTE ALL THE FEATURES OF THE SITE PLAN APPROVAL NO. 82015001B, INCLUDING APPROVAL CONDITIONS, DEVELOPMENT PROGRAM AND CERTIFIED SITE PLAN

DEVELOPER'S NAME: _____
 DRAWN BY: VJS
 CONTACT PERSON OR OWNER: _____
 DESIGNED BY: BS
 ADDRESS: _____
 PHONE & E-MAIL: _____
 DATE ISSUED: 1/31/2023
 SIGNATURE: _____

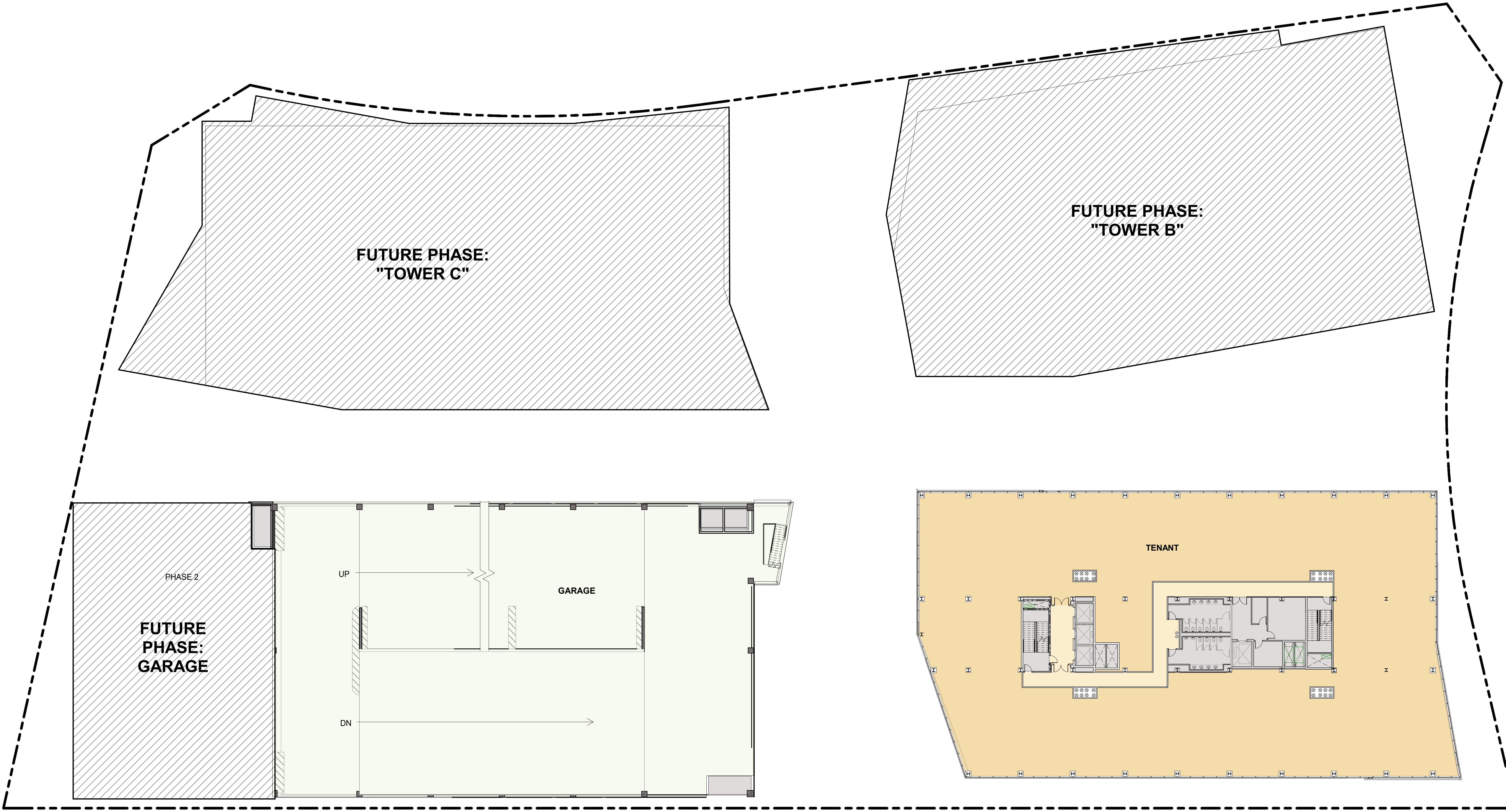

1 SITE PLAN - ILLUSTRATIVE TYPICAL FLOOR PLAN
 SCALE: 1" = 20'-0"

FOR LOCATION OF UTILITIES CALL
 8-1-1 or 1-800-257-7777 OR LOG ON TO
 www.call811.com or http://www.missutility.net
 48 HOURS IN ADVANCE OF ANY
 WORK IN THIS VICINITY