

PLANNING DEPARTMENT USE ONLY (E-PLANS)

SITE PAVING LEGEND

KEY	SYMBOL	DESCRIPTION
P1		CONCRETE PAVING TYPE 1
P2		CONCRETE PAVING TYPE 2
P3		CONCRETE UNIT PAVER A & B
P4		MULCH PATH
P5		PRECAST CONCRETE TREAD
P6		8" FLUSH CONCRETE CURB

JOINTING LEGEND

KEY	DESCRIPTION
	SAW CUT CONTROL JOINT
	EXPANSION JOINT
	DECORATIVE JOINT

WALL LEGEND

KEY	DESCRIPTION
W1	BIORETENTION PLANTER WALL
W2	PRECAST CONCRETE VENEER WALL
W3	PLANTER CURB
W4	PRECAST CONCRETE WALL
W5	CIP CONCRETE WALL

BOLLARD LEGEND

KEY	DESCRIPTION
B1	ARCHITECTURAL BOLLARD

SITE FURNISHING LEGEND

KEY	SYMBOL	DESCRIPTION
F1		BENCH
F2		TRASH/RECYCLING RECEPTACLE
F3		BICYCLE RACK
F4		WOOD SEAT TOP
F5		BISTRO TABLE
F6		PLAZA TABLE
F7		RAFT BENCH
F8		SWING BENCH
F9		PLANTER BENCH
F10		BIKE REPAIR STATION
F11		WOOD BENCH SEATING
F12		CHARGING STATION
F13		GFCI OUTLET

LIGHTING LEGEND

KEY	SYMBOL	DESCRIPTION
CT 1		CATENARY LIGHT
M1		ROADWAY LIGHT
M2		INTERNAL ROADWAY LIGHT
M3		SITE/PEDESTRIAN LIGHT
M3A		SITE/PEDESTRIAN LIGHT
M4		LIGHT POLE
M5		SITE/PEDESTRIAN POLE
Q1		WALL DOWN LIGHT
S1		TREE UP LIGHT
V1		PEDESTRIAN BOLLARD
V1A		PEDESTRIAN BOLLARD

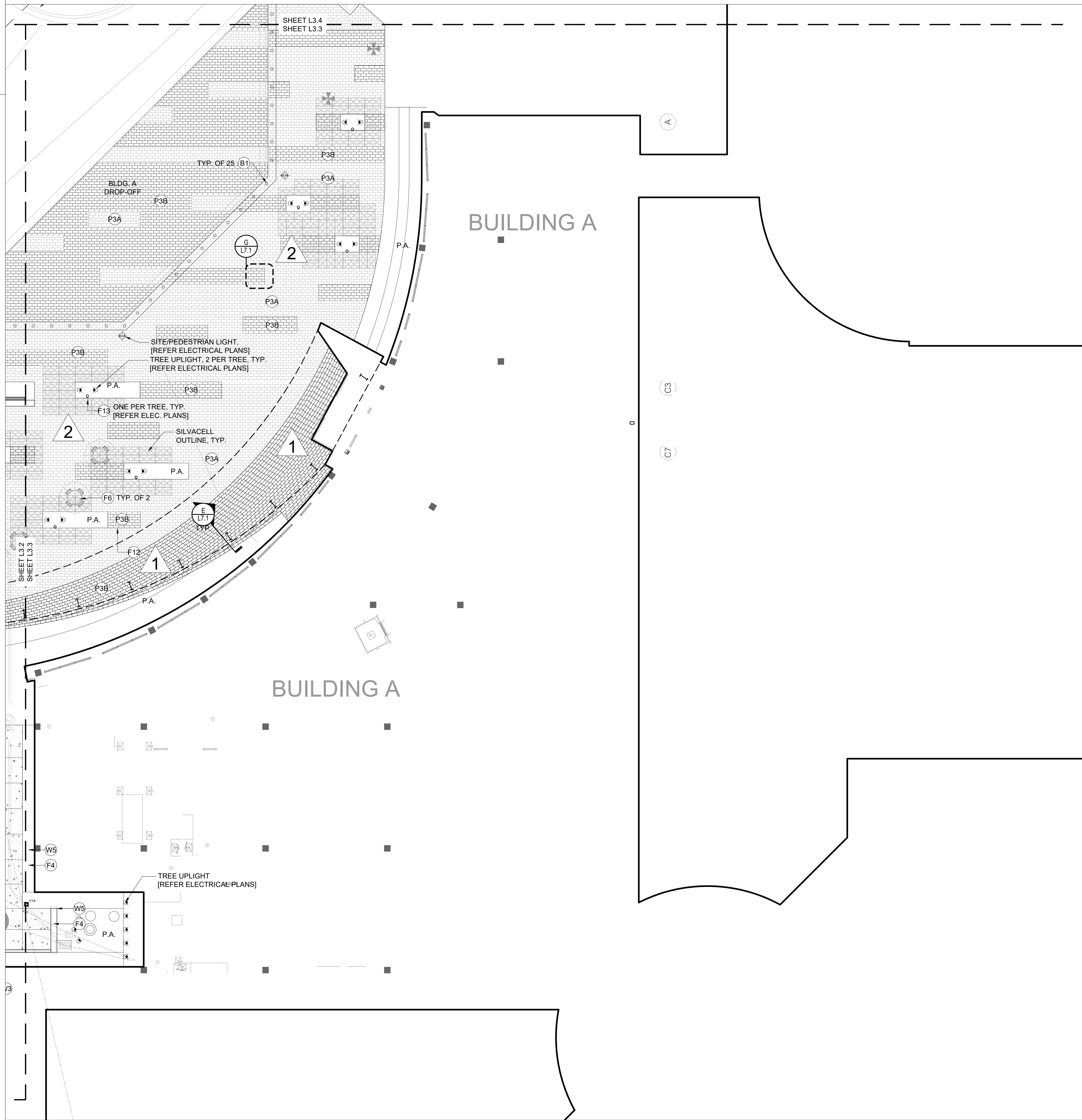

AMENDMENT SUMMARY
#81995045H

- 1 INSTALL ENTRANCE CANOPY FROM THE NEW GARAGE TO BUILDING A ENTRANCE
- 2 ADJUST TREE LOCATION AND DECK STRUCTURE IN NEW PLAZA TO ACCOMMODATE CANOPY
- 3 REVISE FOUNDATION PLANTINGS TO ACCOMMODATE CANOPY

Consulted by: EWINGCOLE
CONSULTANTS
CIVIL SITE ENGINEERS
 550 WEST CHAMBERS ST.
 2nd Floor, Suite 200
 Baltimore, MD 21201
 Phone: 410-528-1000
 Fax: 410-528-1001
LAND PLANNERS & LANDSCAPE ARCHITECTS:
 W&P
 405 South Lenoir Alley
 Columbia, MD 21046
 Phone: 410-621-2700
STRUCTURAL ENGINEERS:
 F&S ENGINEERING, INC.
 815 Light Street
 Baltimore, MD 21202
 Phone: 410-528-1000
MEDIA ENGINEERS:
 JENSEN ENGINEERING, INC.
 8817 Forest Road
 Nottingham, MD 21078
 Phone: 410-331-1300
SUSTAINABILITY CONSULTANTS:
 LOUVA PARTNERSHIP, LLC
 1000 Light Street
 Baltimore, MD 21202
 Phone: 410-681-0100

KEY PLAN

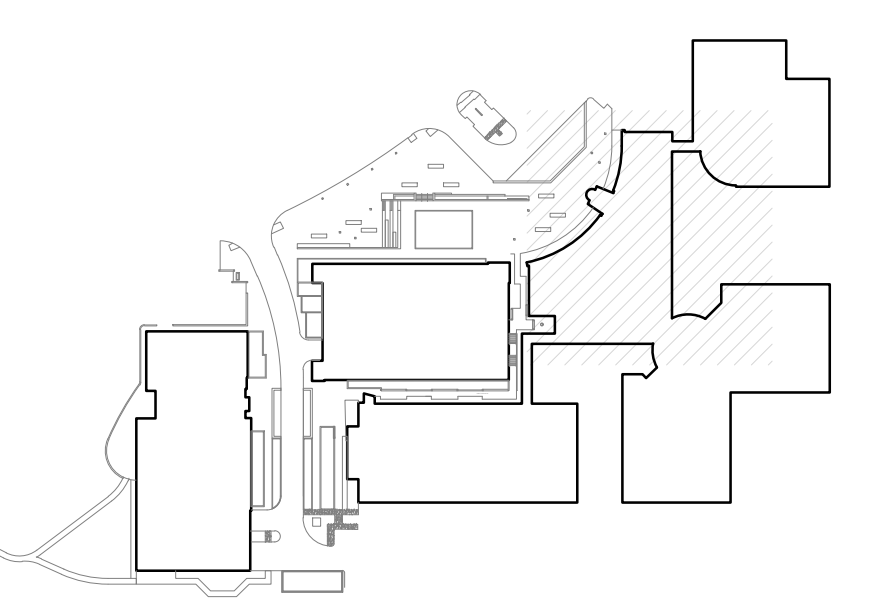

PRINCIPAL
 ANDY KNIGHT, PLA
PROJECT MANAGER
 RICK ESPE, PLA
 Professional Certification: I certify that these documents were prepared or approved by me, and that I am a duly licensed landscape architect under the laws of the State of Maryland.
 License No: 01-4189 Expiration Date: 01/26/23



REVISIONS

NO.	BY	DESCRIPTION	DATE

#81995045H 10-13-2023



ALEXANDRIA
 ALEXANDRIA REAL ESTATE EQUITIES, INC

9808 MEDICAL CENTER DRIVE
 BUILDING E & PARKING DECK

ROCKVILLE, MD 20850

CERTIFIED SITE PLAN 81995045

DEVELOPER'S CERTIFICATE

The undersigned agrees to execute all the features of the Site Plan Approval No. 81995045H, including Approval Conditions, Development Program, and Certified Site Plan.

Developer's Name: ARE-Maryland No. 24, LLC
 Contact Person: Ari Hoffman
 Address: 946 Copper Road, Gaithersburg, MD 20878
 Phone: 301.947.1770

Signature: _____
 Authorized Signatory

DRAWN BY: DB DATE: 02-19-2021

PROJECT NO. SCALE

DRAWING NAME

MATERIALS PLAN

FLOOR/SECTION/PHASE: CD DRAWING NO.: L3.3

