

PLANNING DEPARTMENT USE ONLY (E-PLANS)

| KEY | SYMBOL | DESCRIPTION |
|-----|--------|---------------------------|
| P1 | | CONCRETE PAVING TYPE 1 |
| P2 | | CONCRETE PAVING TYPE 2 |
| P3 | | CONCRETE UNIT PAVER A & B |
| P4 | | MULCH PATH |
| P5 | | PRECAST CONCRETE TREAD |
| P6 | | 8" FLUSH CONCRETE CURB |

| KEY | DESCRIPTION |
|-----|-----------------------|
| | SAW CUT CONTROL JOINT |
| | EXPANSION JOINT |
| | DECORATIVE JOINT |

| KEY | DESCRIPTION |
|-----|------------------------------|
| W1 | BIORETENTION PLANTER WALL |
| W2 | PRECAST CONCRETE VENEER WALL |
| W3 | PLANTER CURB |
| W4 | PRECAST CONCRETE WALL |
| W5 | CIP CONCRETE WALL |

| KEY | DESCRIPTION |
|-----|-----------------------|
| B1 | ARCHITECTURAL BOLLARD |

| KEY | SYMBOL | DESCRIPTION |
|-----|--------|----------------------------|
| F1 | | BENCH |
| F2 | | TRASH/RECYCLING RECEPTACLE |
| F3 | | BICYCLE RACK |
| F4 | | WOOD SEAT TOP |
| F5 | | BISTRO TABLE |
| F6 | | PLAZA TABLE |
| F7 | | RAFT BENCH |
| F8 | | SWING BENCH |
| F9 | | PLANTER BENCH |
| F10 | | BIKE REPAIR STATION |
| F11 | | WOOD BENCH SEATING |
| F12 | | CHARGING STATION |
| F13 | | GFCI OUTLET |

| KEY | SYMBOL | DESCRIPTION |
|------|--------|------------------------|
| CT 1 | | CATENARY LIGHT |
| M1 | | ROADWAY LIGHT |
| M2 | | INTERNAL ROADWAY LIGHT |
| M3 | | SITE/PEDESTRIAN LIGHT |
| M3A | | SITE/PEDESTRIAN LIGHT |
| M4 | | LIGHT POLE |
| M5 | | SITE/PEDESTRIAN POLE |
| Q1 | | WALL DOWN LIGHT |
| S1 | | TREE UP LIGHT |
| V1 | | PEDESTRIAN BOLLARD |
| V1A | | PEDESTRIAN BOLLARD |

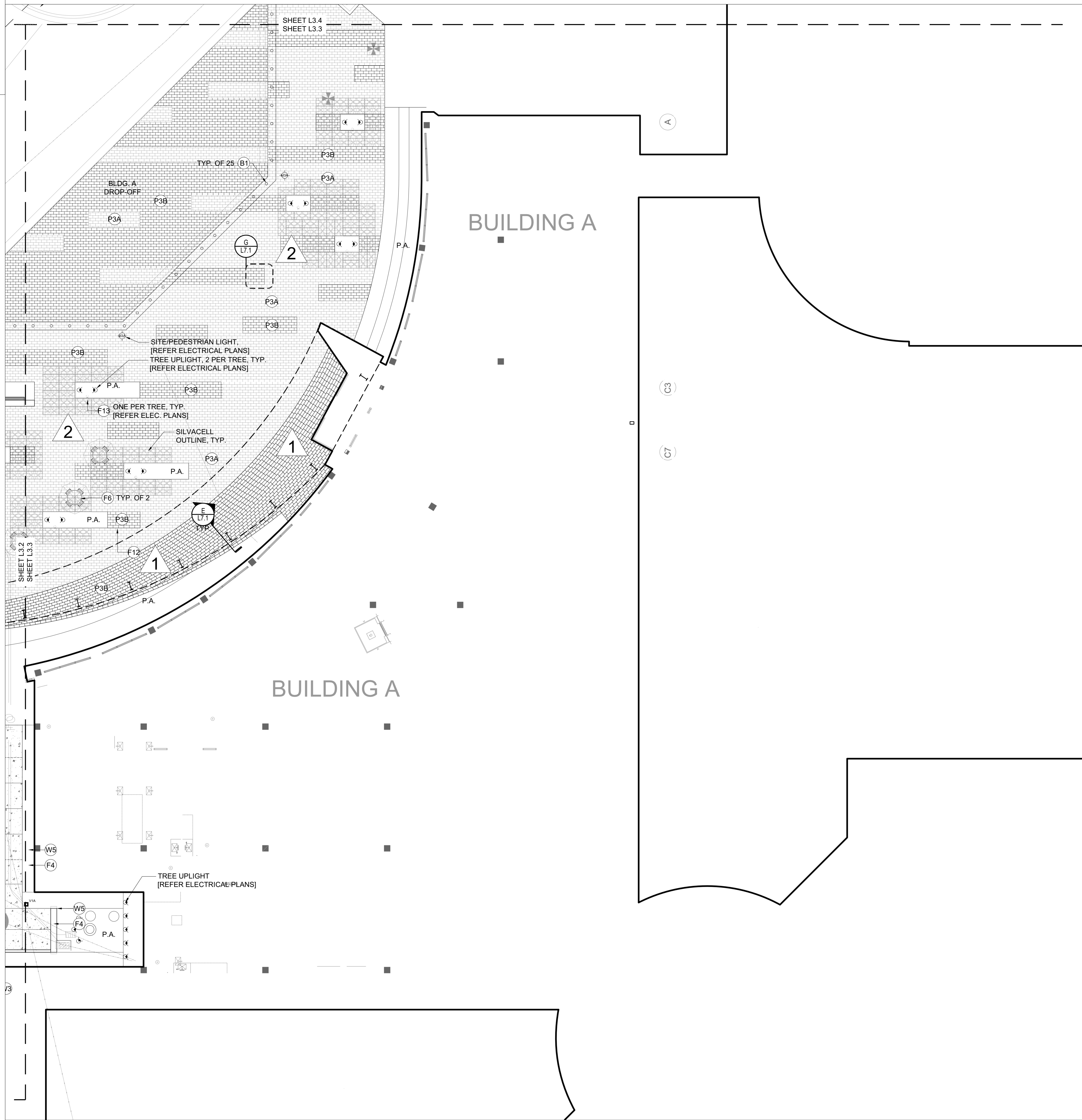

AMENDMENT SUMMARY
 #81995045H

- 1 INSTALL ENTRANCE CANOPY FROM THE NEW GARAGE TO BUILDING A ENTRANCE
- 2 ADJUST TREE LOCATION AND DECK STRUCTURE IN NEW PLAZA TO ACCOMMODATE CANOPY
- 3 REVISE FOUNDATION PLANTINGS TO ACCOMMODATE CANOPY

Consultant: EWINGCOLE
CONSULTANTS
 CIVIL SITE ENGINEERS
 55112 FARMERSVILLE
 2 Newell Street, Suite 100
 Rockville, MD 20850
 Phone: 301.947.2700
 Fax: 301.947.2703

LAND PLANNERS & LANDSCAPE ARCHITECTS:
 W&P
 4500 Lullwater Alley
 Columbia, MD 21046
 Phone: 410.421.2700

STRUCTURAL ENGINEERS:
 H&M ENGINEERS, INC.
 815 Light Street
 Baltimore, MD 21202
 Phone: 410.528.1800

M&P ENGINEERS:
 JENSEN ENGINEERING, INC.
 8817 Forest Road
 Montgomery, MD 20878
 Phone: 410.521.1200

SUSTAINABILITY CONSULTANTS:
 LOWE PARTNERSHIPS, LLC
 2000 Light Street
 Baltimore, MD 21202
 Phone: 410.488.0100

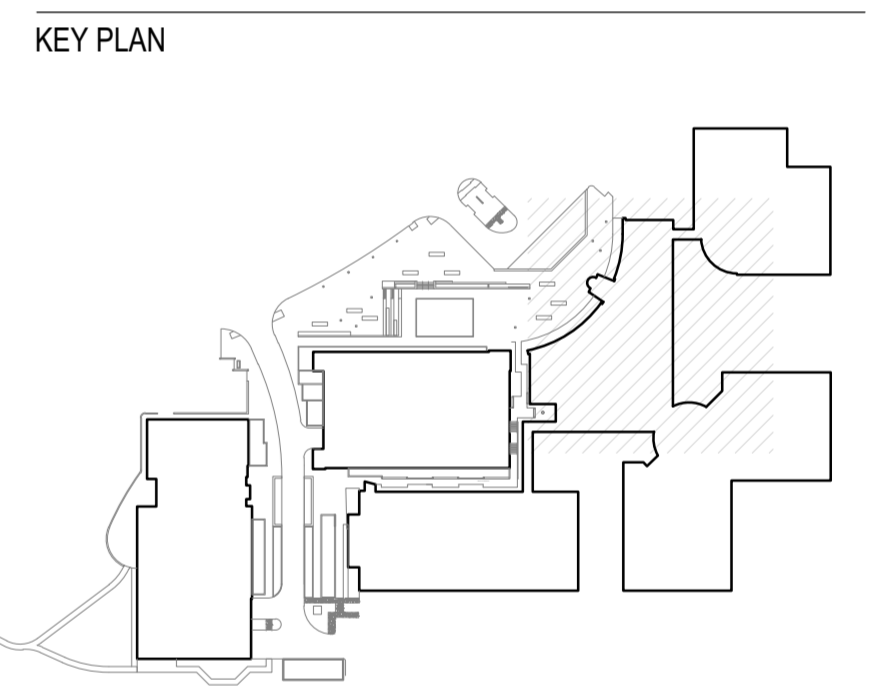

PRINCIPAL
 ANDY KNIGHT, PLA
 PROJECT MANAGER
 RICK ESPE, PLA

Professional Certification: I certify that these documents were prepared or approved by me, and that I am a duly licensed landscape architect under the laws of the State of Maryland.
 License No: 01-4188 Expiration Date: 01/26/23

REVISIONS

| NO. | BY | DESCRIPTION | DATE |
|-----|----|-------------|------|
| | | | |

#81995045H 1/5/23

ALEXANDRIA
 ALEXANDRIA REAL ESTATE EQUITIES, INC
 9808 MEDICAL CENTER DRIVE
 BUILDING E & PARKING DECK
 ROCKVILLE, MD 20850

CERTIFIED SITE PLAN 81995045

DEVELOPER'S CERTIFICATE
 The undersigned agrees to execute all the features of the Site Plan Approval No. 81995045H, including Approval Conditions, Development Program, and Certified Site Plan.
 Developer's Name: ARE-Maryland No. 24, LLC
 Contact Person: Ari Hoffman
 Address: 945 Copper Road, Gaithersburg, MD 20878
 Phone: 301.947.1770

Signature: *Ari Hoffman*
 Authorized Signatory

DRAWN BY DB DATE 02-19-2021
 PROJECT NO. SCALE
 DRAWING NAME CERTIFIED SITE PLAN #81995045H
 MATERIALS PLAN
 FLOOR/SECTION/PHASE CD DRAWING NO. L3.3

