

PLANNING DEPARTMENT USE ONLY (E-PLANS)

SITE PAVING LEGEND		
KEY	SYMBOL	DESCRIPTION
P1		CONCRETE PAVING TYPE 1
P2		CONCRETE PAVING TYPE 2
P3		CONCRETE UNIT PAVER A & B
P4		MULCH PATH
P5		PRECAST CONCRETE TREAD
JOINTING LEGEND		
KEY	DESCRIPTION	
	SAW CUT CONTROL JOINT	
	EXPANSION JOINT	
	DECORATIVE JOINT	
WALL LEGEND		
KEY	DESCRIPTION	
W1	BIORETENTION PLANTER WALL	
W2	PRECAST CONCRETE VENEER WALL	
W3	PLANTER CURB	
W4	PRECAST CONCRETE WALL	
W5	CIP CONCRETE WALL	
BOLLARD LEGEND		
KEY	DESCRIPTION	
B1	ARCHITECTURAL BOLLARD	
SITE FURNISHING LEGEND		
KEY	SYMBOL	DESCRIPTION
F1		BENCH
F2		TRASH/RECYCLING RECEPTACLE
F3		BICYCLE RACK
F4		WOOD SEAT TOP
F5		BISTRO TABLE
F6		PLAZA TABLE
F7		RAFT BENCH
F8		SWING BENCH
F9		PLANTER BENCH
F10		BIKE REPAIR STATION
F11		WOOD BENCH SEATING
F12		CHARGING STATION
F13		GFCI OUTLET
LIGHTING LEGEND		
KEY	SYMBOL	DESCRIPTION
CT 1		CATENARY LIGHT
M1		ROADWAY LIGHT
M2		INTERNAL ROADWAY LIGHT
M3		SITE/PEDESTRIAN LIGHT
M3A		SITE/PEDESTRIAN LIGHT
M4		LIGHT POLE
M5		SITE/PEDESTRIAN POLE
Q1		WALL DOWN LIGHT
S1		TREE UP LIGHT
V1		PEDESTRIAN BOLLARD
V1A		PEDESTRIAN BOLLARD

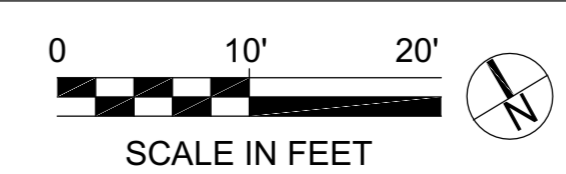
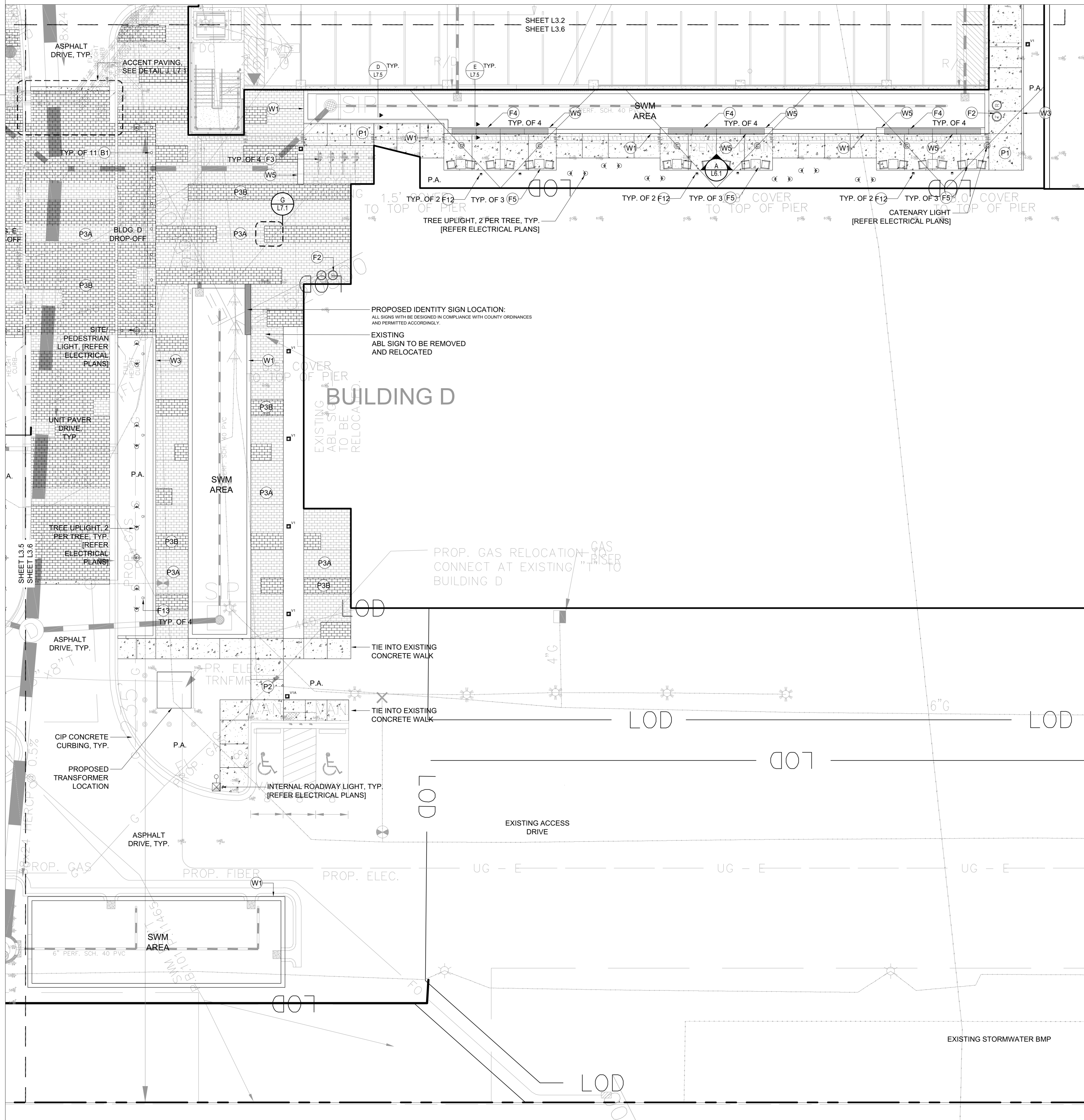

**CERTIFIED SITE PLAN 81995045G**

**DEVELOPER'S CERTIFICATE**  
 The Undersigned agrees to execute all the features of the Site Plan Approval No. 81995045G, including Approval Conditions, Development Program and Certified Site Plan.  
 Developer's Name: ARE-Maryland No.24, LLC. William DePippo  
 Company Contact Person  
 Address: 946 Clopper Road, Gaithersburg, MD 20878  
 Phone: 301-947-1770  
 Signature: *William DePippo*

**EWING COLE**

810 Light Street  
 Baltimore, MD 21230-3970  
 Tel: 410-837-5040 Fax: 410-234-8010

CONSULTANTS  
 CIVIL SITE ENGINEERS  
 501 TECH CENTER DR  
 2 River Street, Suite 100  
 Pikesville, MD 21076  
 Phone: 410-641-3700

LAND PLANNERS & LANDSCAPE ARCHITECTS:  
 W&P  
 402 East Lottow Alley  
 Columbia, MD 21046  
 Phone: 410-671-2700

STRUCTURAL ENGINEERS:  
 P&S  
 810 Light Street  
 Baltimore, MD 21230  
 Phone: 410-671-1800

M&P ENGINEERS:  
 JENSEN ENGINEERING, INC.  
 68117 Rock Road  
 Hagerstown, MD 21756  
 Phone: 410-393-1300

SUSTAINABILITY CONSULTANTS:  
 LOCAL PARTNERSHIPS, LLC  
 1001 6th Street  
 Baltimore, MD 21205  
 Phone: 410-681-0100

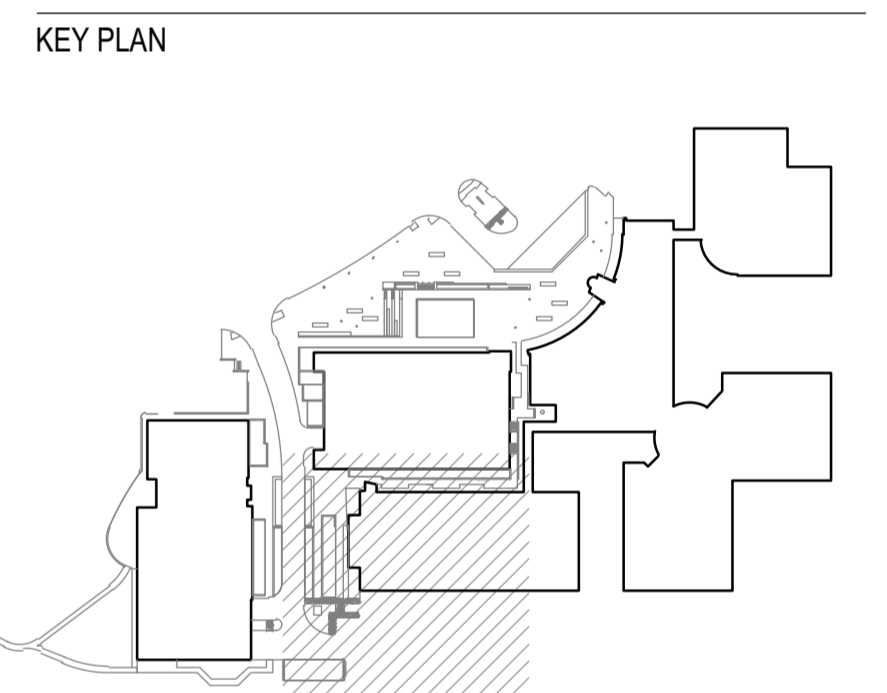

**PRINCIPAL**  
 ANDY KNIGHT, PLA  
**PROJECT MANAGER**  
 RICK ESPE, PLA

Professional Certification: I certify that these documents were prepared or approved by me, and that I am a duly licensed landscape architect under the laws of the State of Maryland.  
 License No: 01-4188 Expiration Date: 01/26/23

**REVISIONS**

NO.	BY	DESCRIPTION	DATE

**ALEXANDRIA**  
 ALEXANDRIA REAL ESTATE EQUITIES, INC

9808 MEDICAL CENTER DRIVE  
 BUILDING E & PARKING DECK

ROCKVILLE, MD 20850

DRAWN BY: DB DATE: 02-19-2021  
 PROJECT NO.: SCALE:  
 DRAWING NAME:  
 MATERIALS PLAN

FLOOR/SECTION/PHASE: CD DRAWING NO.: L3.6