

PLANNING DEPARTMENT USE ONLY (E-PLANS)

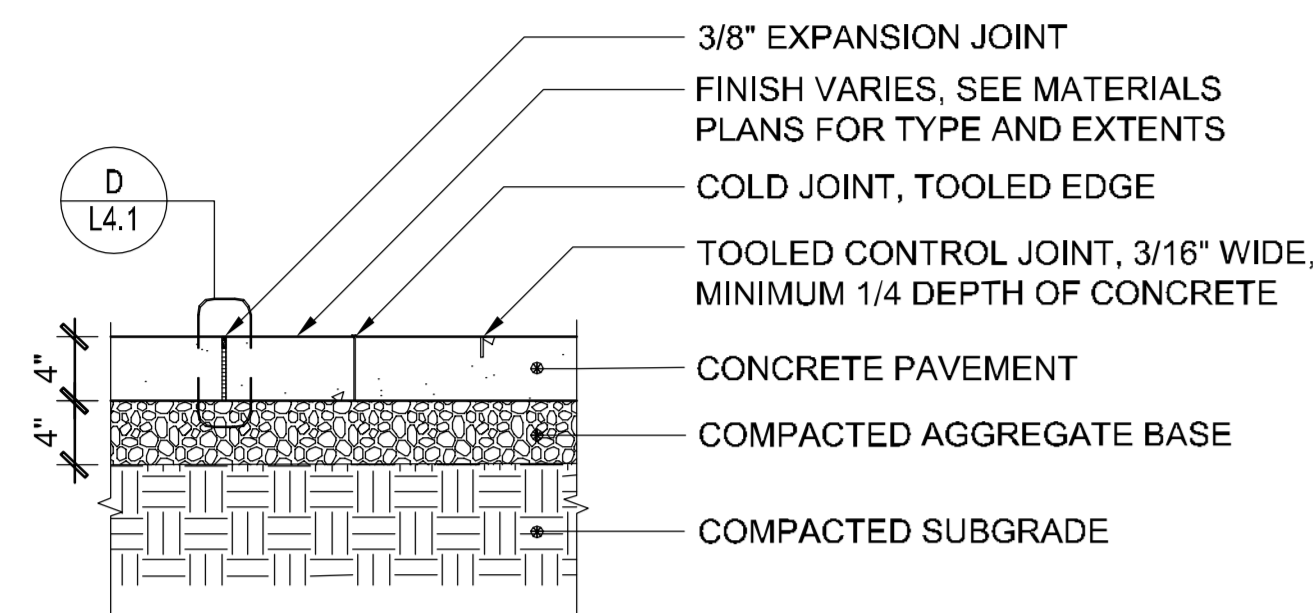

A CONCRETE PAVEMENT
 0 1/2 1 2 TYPICAL SECTION

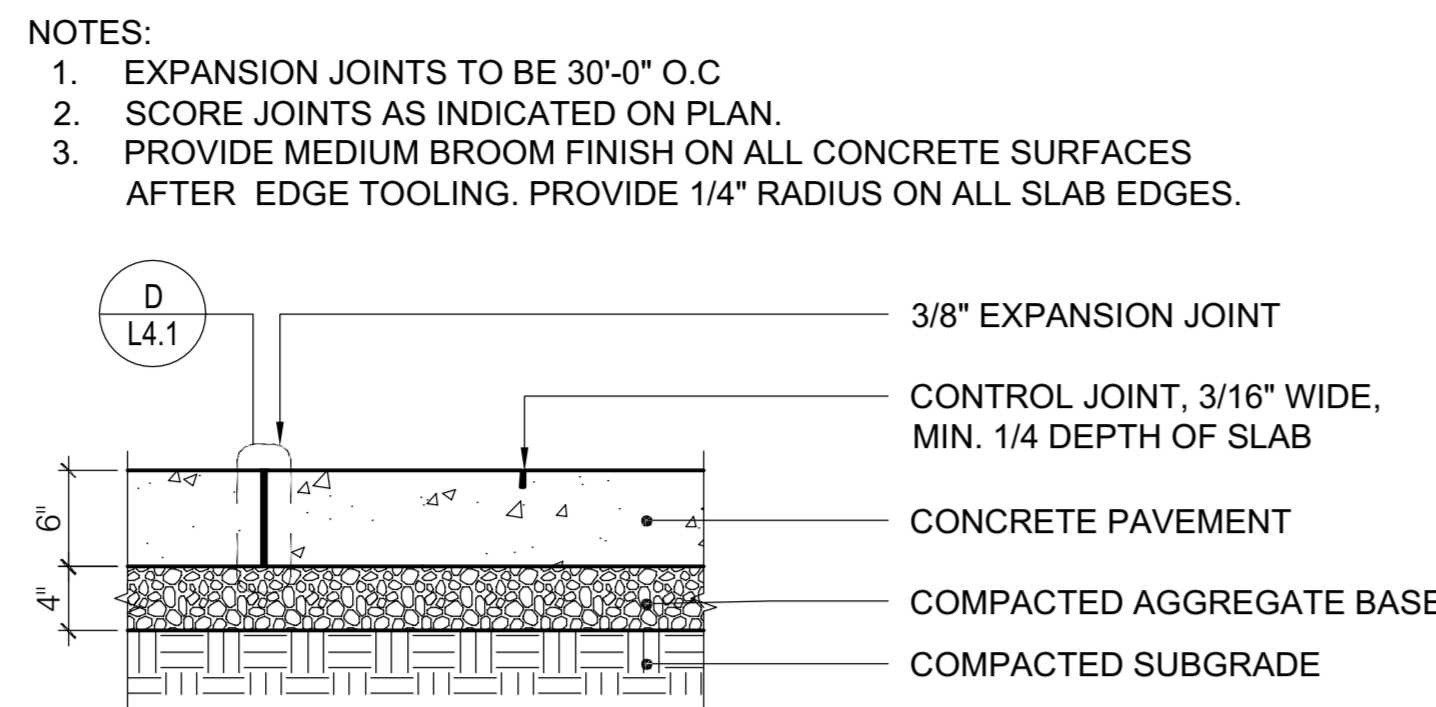

B HEAVY DUTY CONCRETE PAVING
 0 1/2 1 2 TYPICAL SECTION

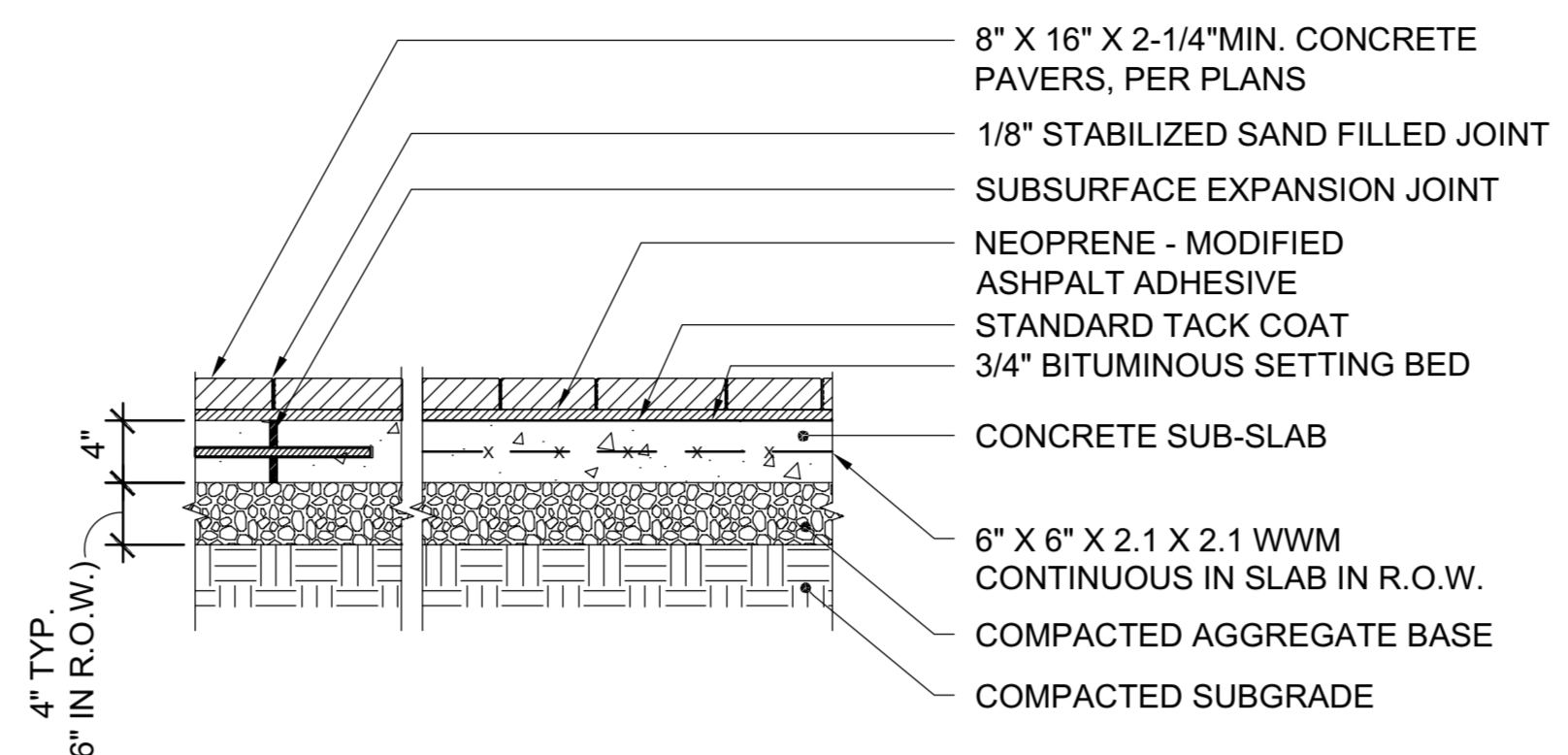

C PEDESTRIAN PAVERS
 0 1/2 1 2 TYPICAL SECTION

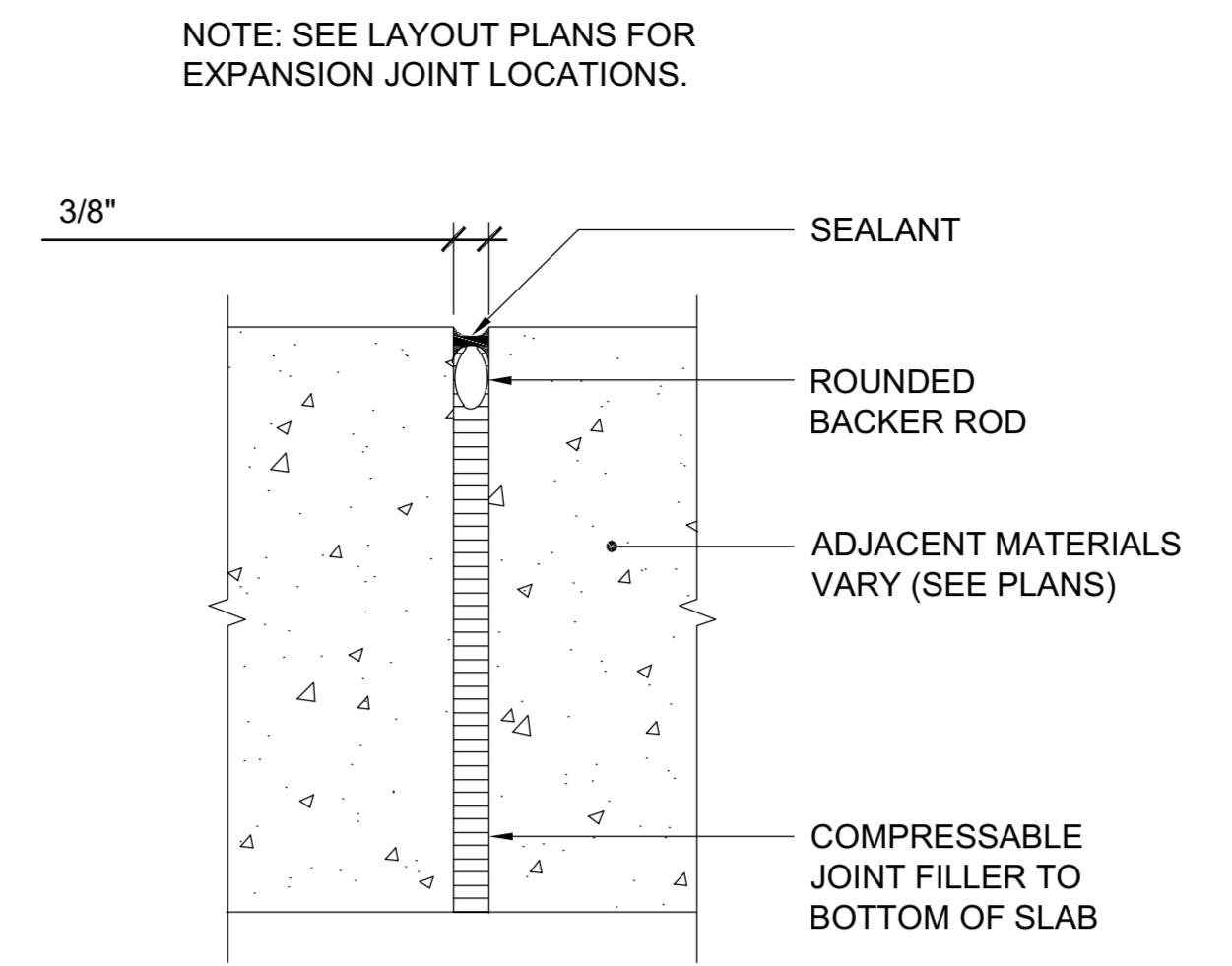

D EXPANSION JOINT
 0 1.5 3 6 TYPICAL SECTION

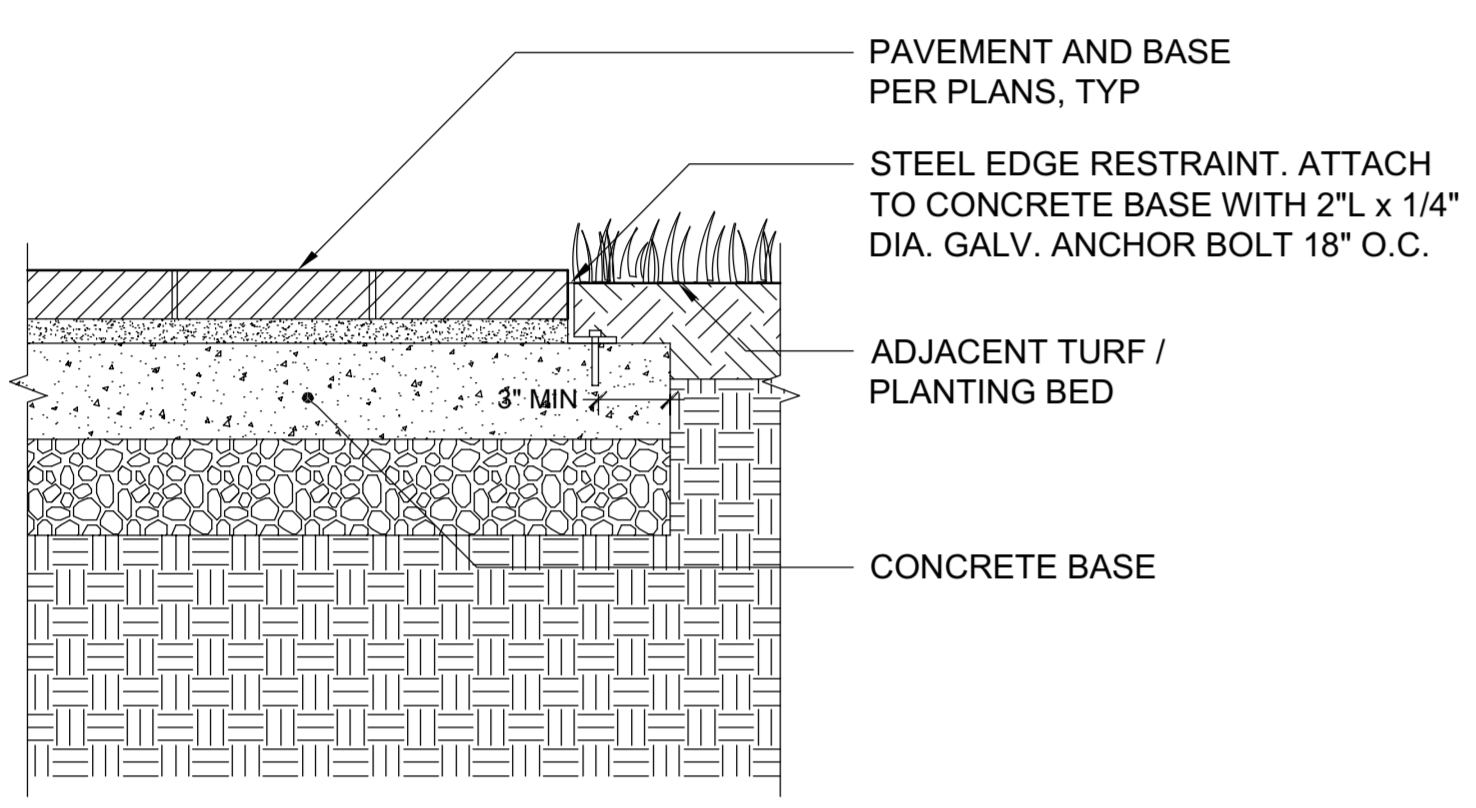

E PAVER EDGE RESTRAINT
 0 3/4 1 1/2 3 TYPICAL SECTION

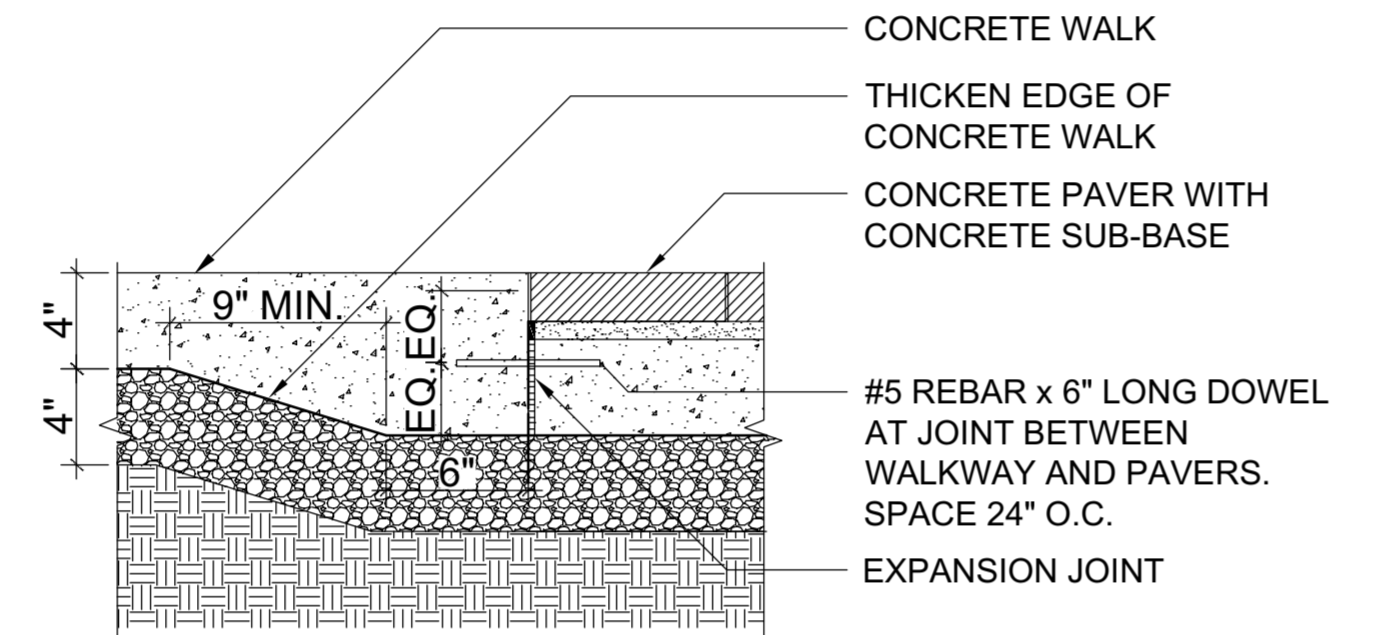

F PAVERS AT CONCRETE
 0 3/4 1 1/2 3 TYPICAL SECTION

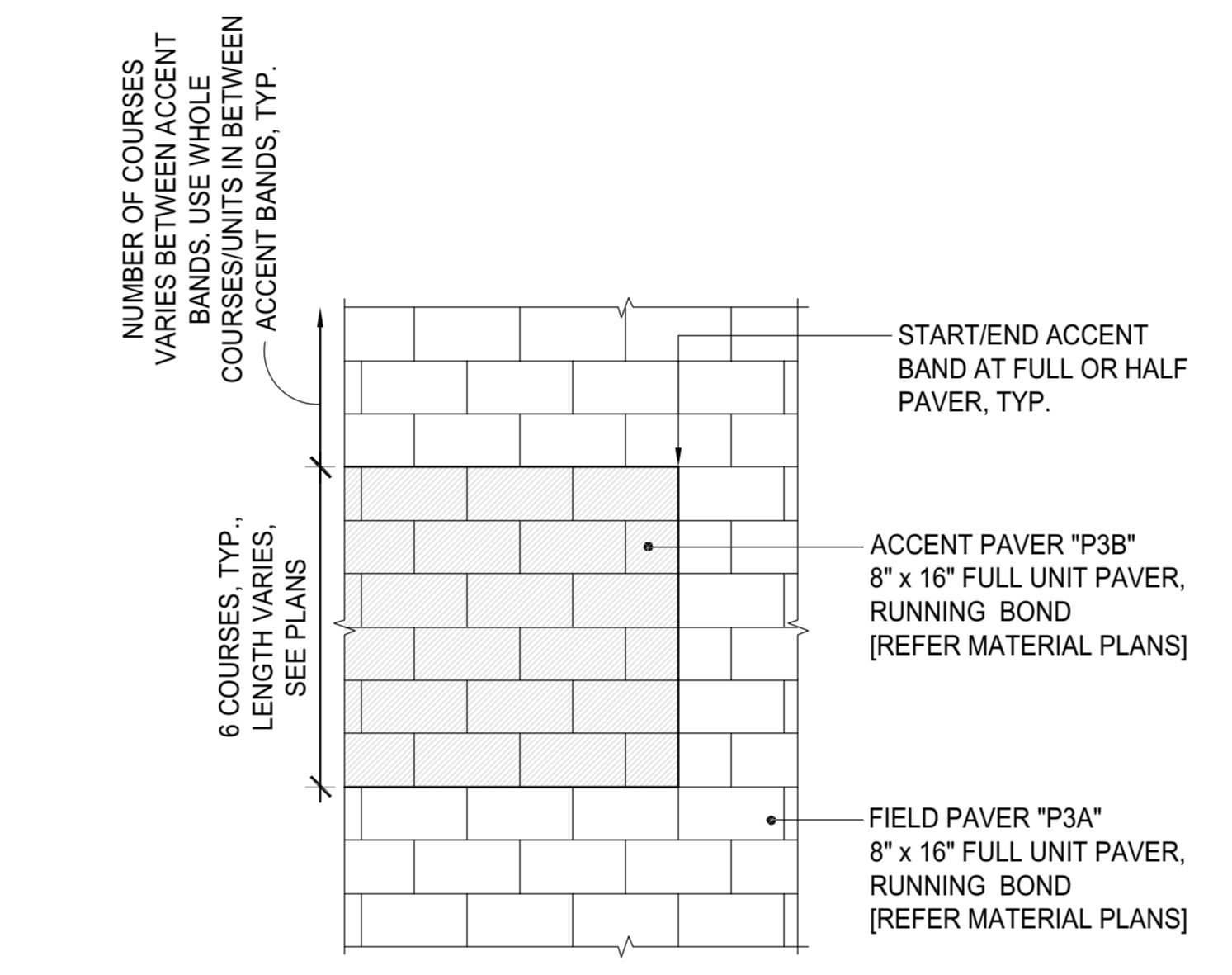

G UNIT PAVING - BANDING ENLARGEMENT
 0 1 2 4 PLAN TYPICAL

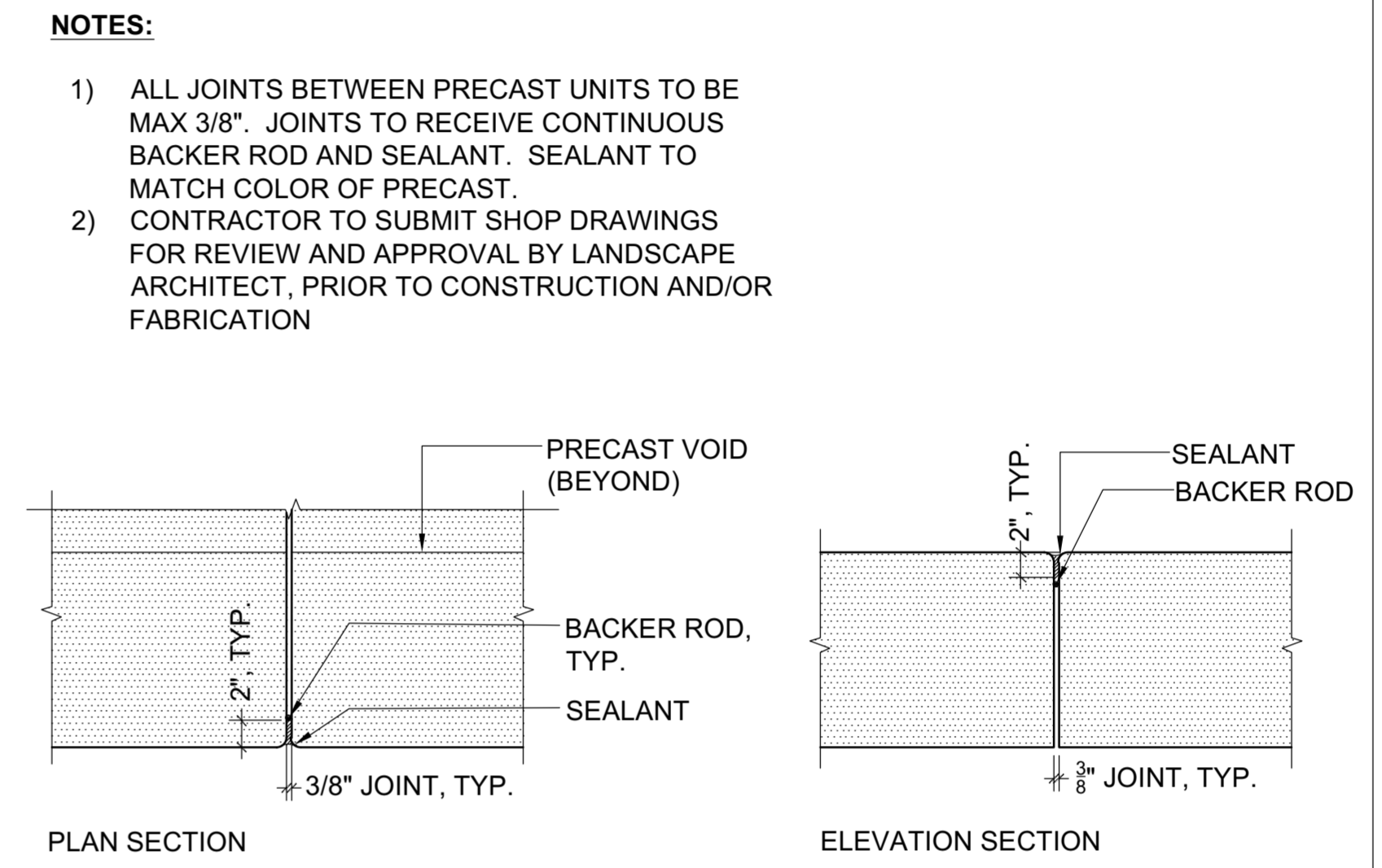

H PRECAST CONCRETE SEATWALL JOINT
 0 6 1 1 2 PLAN SECTION ELEVATION SECTION

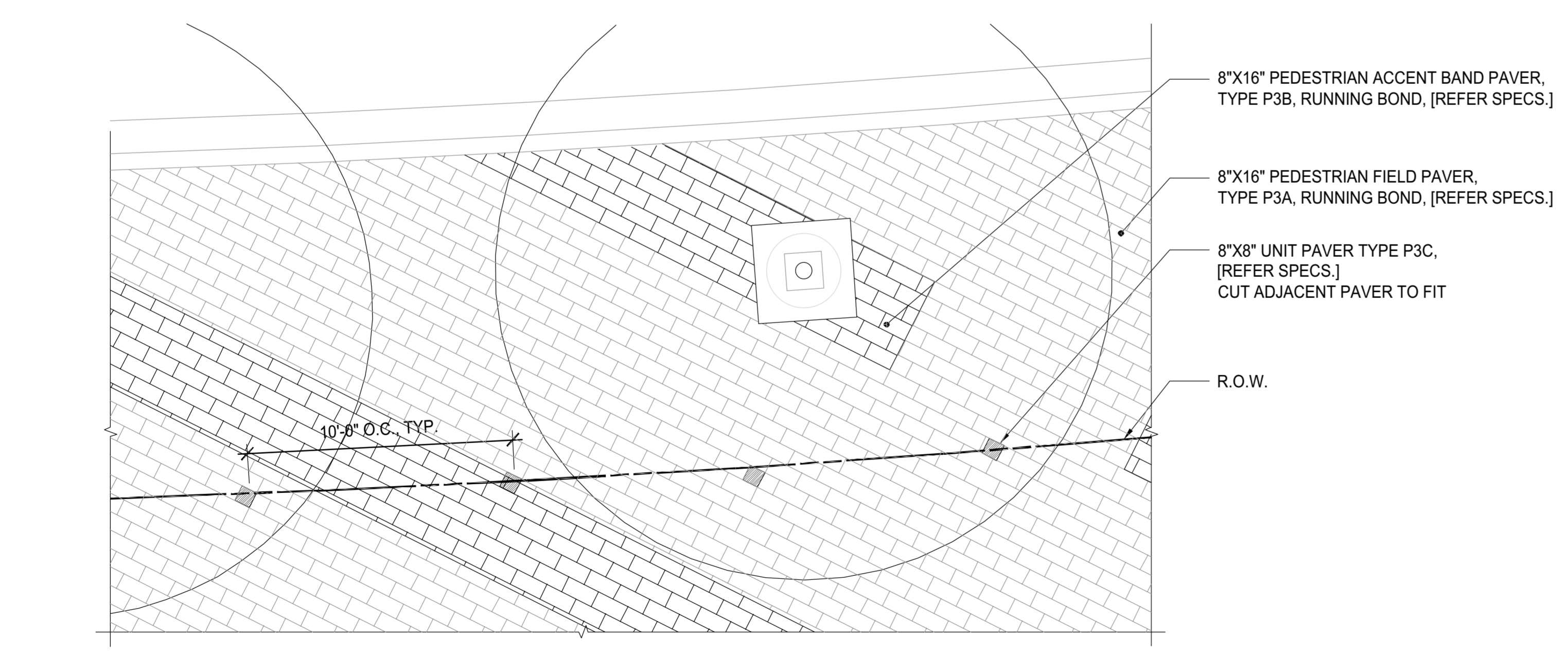

I R.O.W. DEMARCATION BAND
 0 1/8 1/4 1/2 PLAN

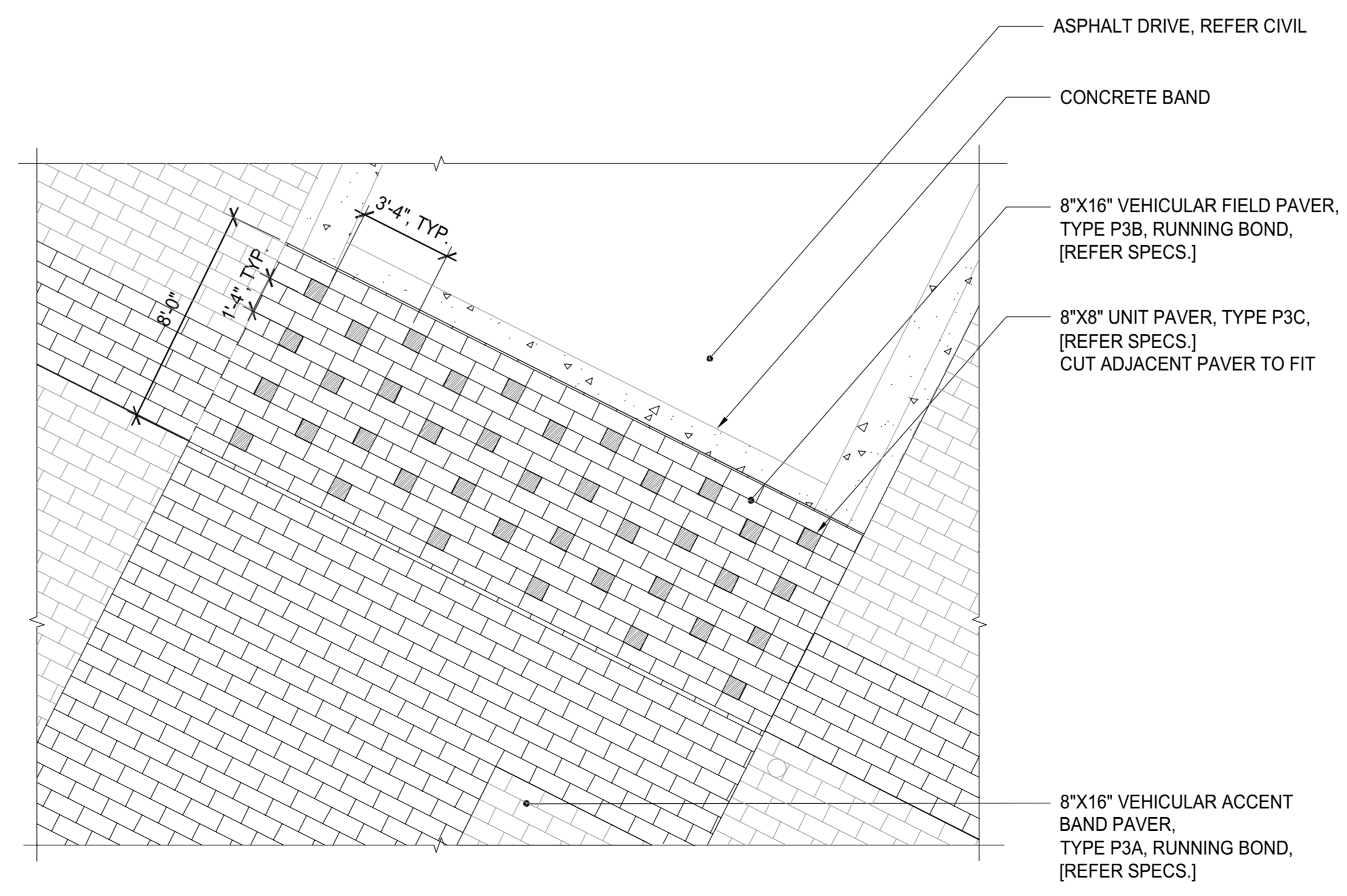

J CROSSWALK DEMARCATION PAVERS
 0 1/8 1/4 1/2 PLAN

NOTES:
 1. SEE MCD 111.02 FOR PAVERS IN R.O.W.

NOTE: SEE LAYOUT PLANS FOR EXPANSION JOINT LOCATIONS.

NOTES:
 1) ALL JOINTS BETWEEN PRECAST UNITS TO BE MAX 3/8". JOINTS TO RECEIVE CONTINUOUS BACKER ROD AND SEALANT. SEALANT TO MATCH COLOR OF PRECAST.
 2) CONTRACTOR TO SUBMIT SHOP DRAWINGS FOR REVIEW AND APPROVAL BY LANDSCAPE ARCHITECT, PRIOR TO CONSTRUCTION AND/OR FABRICATION

CONSULTANTS
 CIVIL SITE ENGINEERS
 501 TEC CHAMBERS
 2 River Street, Suite 100
 Baltimore, MD 21202
 Phone: 410-528-1000
 Fax: 410-528-1001

LAND PLANNERS & LANDSCAPE ARCHITECTS:
 W&P
 405 East Lister Alley
 Columbia, SC 29405
 Phone: 843-721-2700

STRUCTURAL ENGINEERS:
 PAULY ENGINEERING
 810 Light Street
 Baltimore, MD 21202
 Phone: 410-528-1000

M&P ENGINEERS:
 JENSEN ENGINEERING, INC.
 8511 Rock Road
 Nottingham, MD 21088
 Phone: 410-521-1200

SUSTAINABILITY CONSULTANTS:
 LOCAL PARTNERSHIPS, LLC
 1000 Light Street
 Baltimore, MD 21202
 Phone: 410-528-1000

KEY PLAN

PRINCIPAL
 ANDY KNIGHT, PLA
 PROJECT MANAGER
 RICK ESPE, PLA



Professional Certification: I certify that these documents were prepared or approved by me, and that I am a duly licensed landscape architect under the laws of the State of Maryland.
 License No: 01-4189 Expiration Date: 01/26/23

REVISIONS

NO.	BY	DESCRIPTION	DATE

NO. BY DESCRIPTION DATE

ALEXANDRIA
 ALEXANDRIA REAL ESTATE EQUITIES, INC

9808 MEDICAL CENTER DRIVE
 BUILDING E & PARKING DECK

ROCKVILLE, MD 20850

DRAWN BY DB DATE 02-19-2021

PROJECT NO. SCALE

DRAWING NAME

DETAILS

FLOOR/SECTION/PHASE DRAWING NO.

CD L7.1

CERTIFIED SITE PLAN 81995045G

DEVELOPER'S CERTIFICATE

The Undersigned agrees to execute all the features of the Site Plan Approval No. 81995045G, including Approval Conditions, Development Program and Certified Site Plan.

Developer's Name: ARE-Maryland No.24, LLC. William DePippo
 Company Contact Person

Address: 946 Clopper Road, Gaithersburg, MD 20878

Phone: 301-947-1770

Signature: *William DePippo*