

PLANNING DEPARTMENT USE ONLY (E-PLANS)

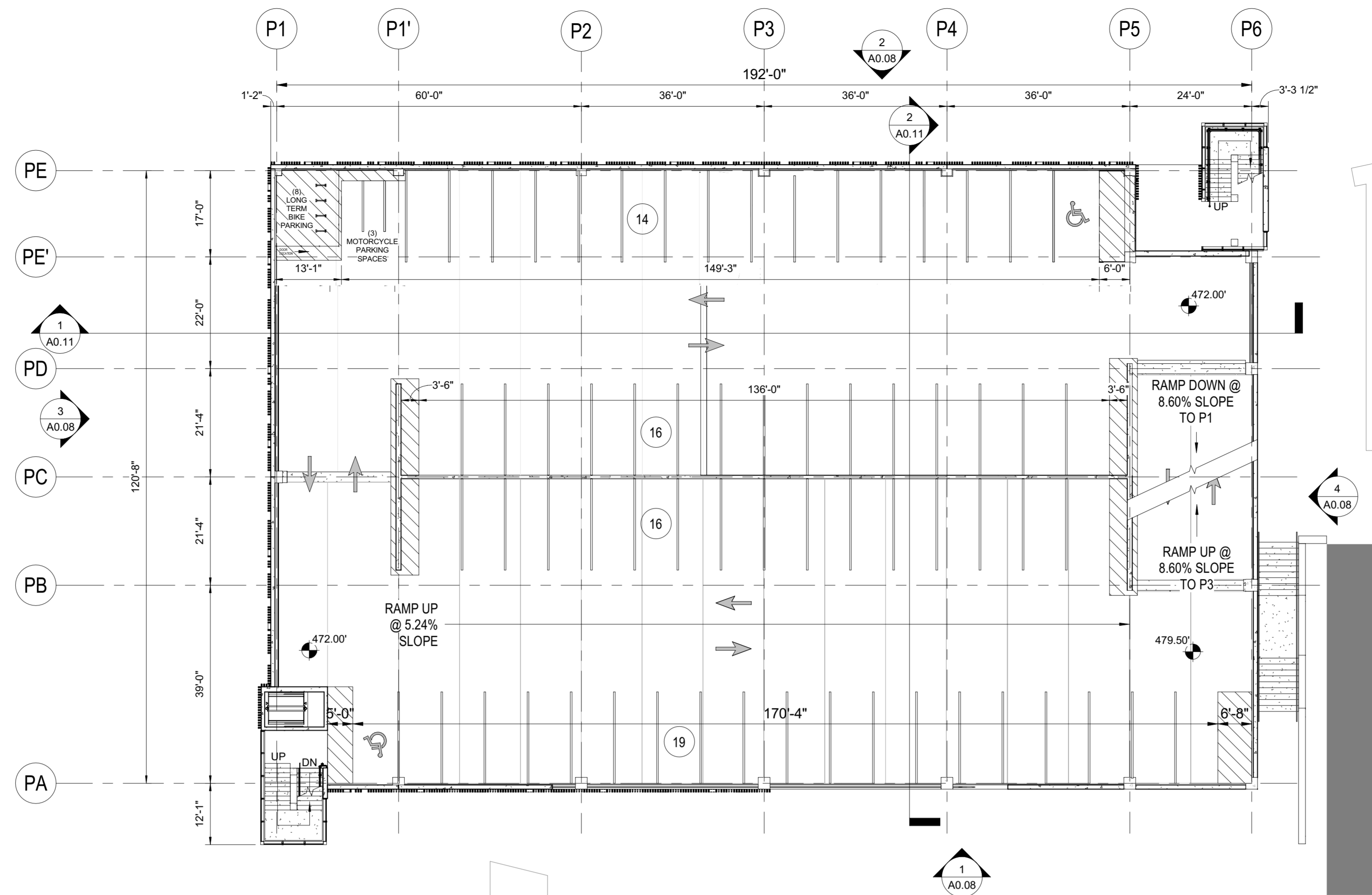

2 SITE PLAN AMENDMENT - PARKING GARAGE - P2 LEVEL PLAN
 1/16" = 1'-0"

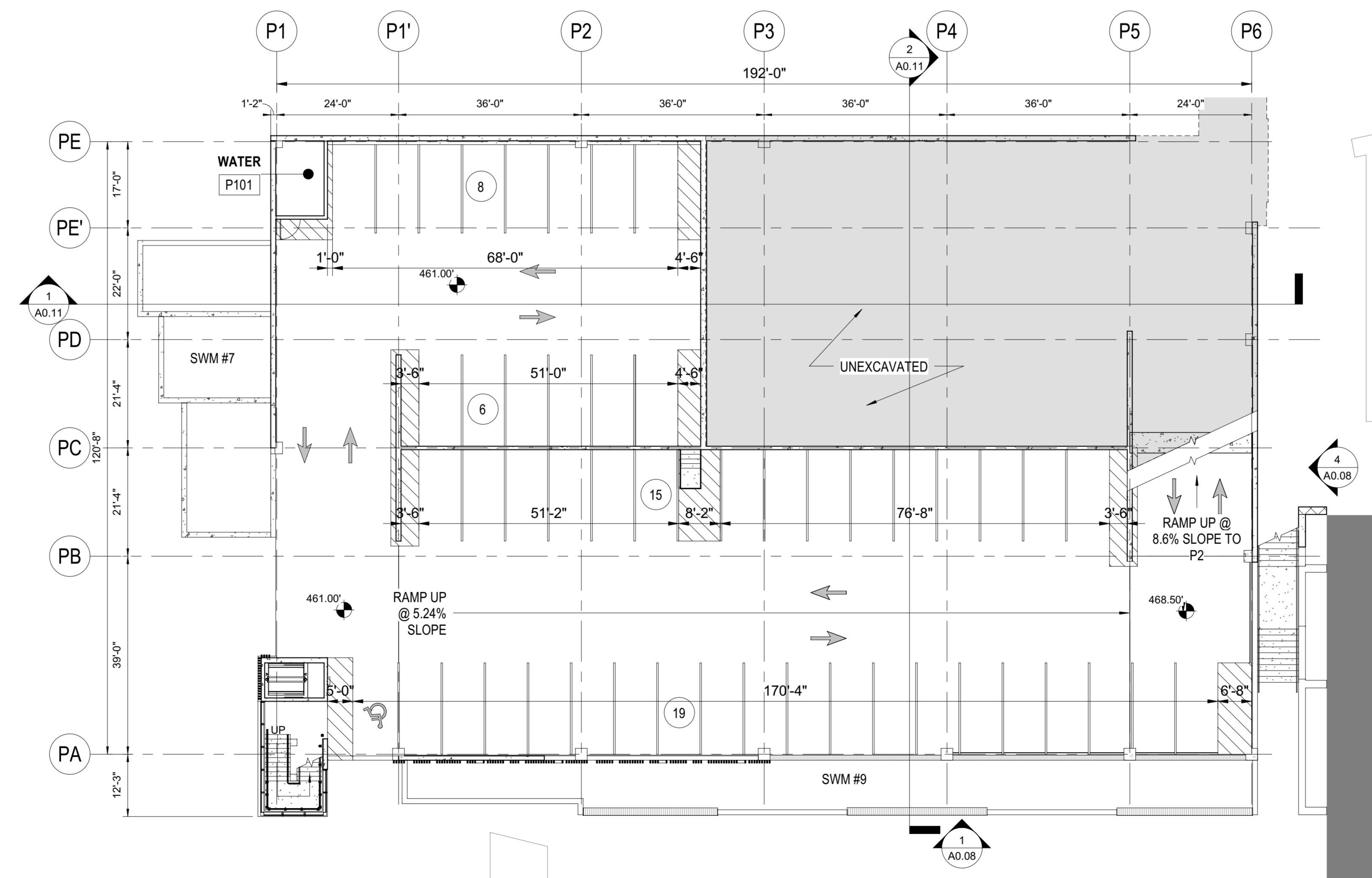

1 SITE PLAN AMENDMENT - PARKING GARAGE - P1 LEVEL PLAN
 1/16" = 1'-0"

CERTIFIED SITE PLAN 81995045G

DEVELOPER'S CERTIFICATE

The Undersigned agrees to execute all the features of the Site Plan Approval No. 81995045G, including Approval Conditions, Development Program and Certified Site Plan.

Developer's Name: ARE-Maryland No.24.LLC William DePippo
 Company Contact Person

Address: 946 Clopper Road, Gaithersburg, MD 20878

Phone: 301-947-1770

Signature: *William DePippo*

4/20/2021 10:44:10 AM C:\Revised Files\20205505_02_CENTRAL_PARKING GARAGE_#modest12.dwg

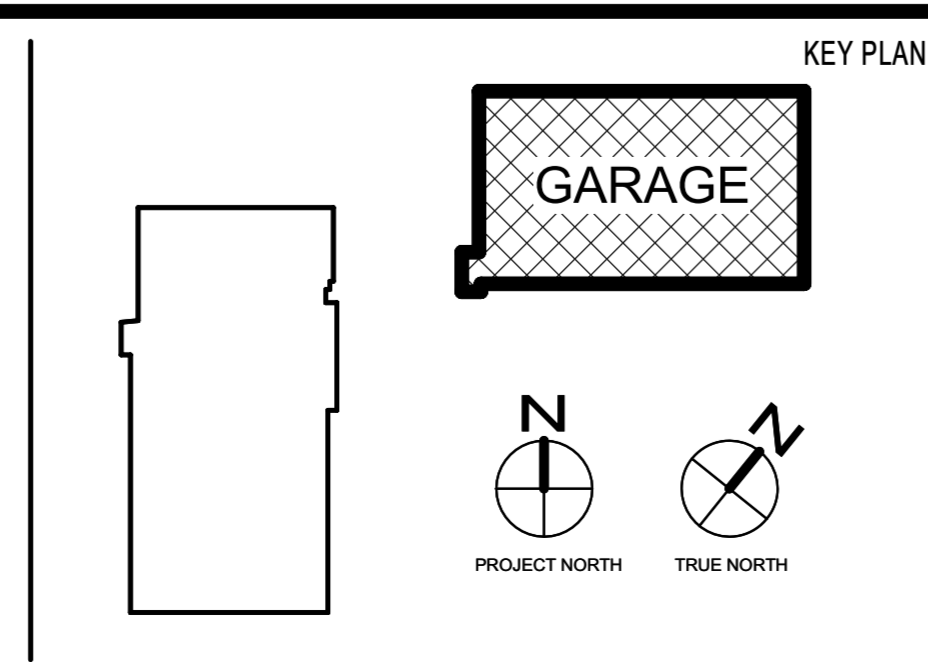

REVISIONS

NO.	BY	DESCRIPTION	DATE	CONSULTANTS

CIVIL SITE ENGINEERS:
 SOLITEC ENGINEERING
 2 Riverchase Plaza, Suite 100
 Rockville, MD 20850
 Phone: 301-948-2700

LAND PLANNERS & LANDSCAPE ARCHITECTS:
 MCKE
 462 South Lakes Alley
 Columbia, OH 43219
 Phone: 614-621-2796

STRUCTURAL ENGINEERS:
 FACILITY ASSOCIATES, INC.
 810 Light Street
 Baltimore, MD 21202
 Phone: 410-783-1699

MEP/FP ENGINEERS:
 JENNIFER ENGINEERING, INC.
 8833 D Miller Road
 Nottingham, MD 21236
 Phone: 410-670-1300

SUSTAINABILITY CONSULTANTS:
 LORAX PARTNERSHIPS, LLC
 1220 Light Street
 Baltimore, MD 21202
 Phone: 410-448-0319

PRINCIPAL
 WILLIAM A.L. GAUDREAU
 PROJECT MANAGER
 RICH WILLIAMS

810 Light Street
 Baltimore, MD 21203-3970
 Tel: 410-837-5040 Fax: 410-234-8010

Professional Certification: I certify that these documents were prepared or approved by me, and that I am a duly licensed architect under the laws of the State of Maryland.
 License No: 6103-R Expiration Date: 08/03/2022

EWING COLE

Copyright ©2021 by EWINGCOLE

PROJECT NO. 20200550 SCALE 1/16" = 1'-0"

DRAWING NAME PARKING GARAGE - FLOOR PLANS

ALEXANDRIA REAL ESTATE EQUITIES

9808 MEDICAL CENTER DRIVE,
 PARKING DECK
 ROCKVILLE, MD 20850

DRAWN BY Author DATE 04/30/21
 FLOOR/SECTION PHASE DRAWING NO.
 DD A0.04