

E-FILE STAMP

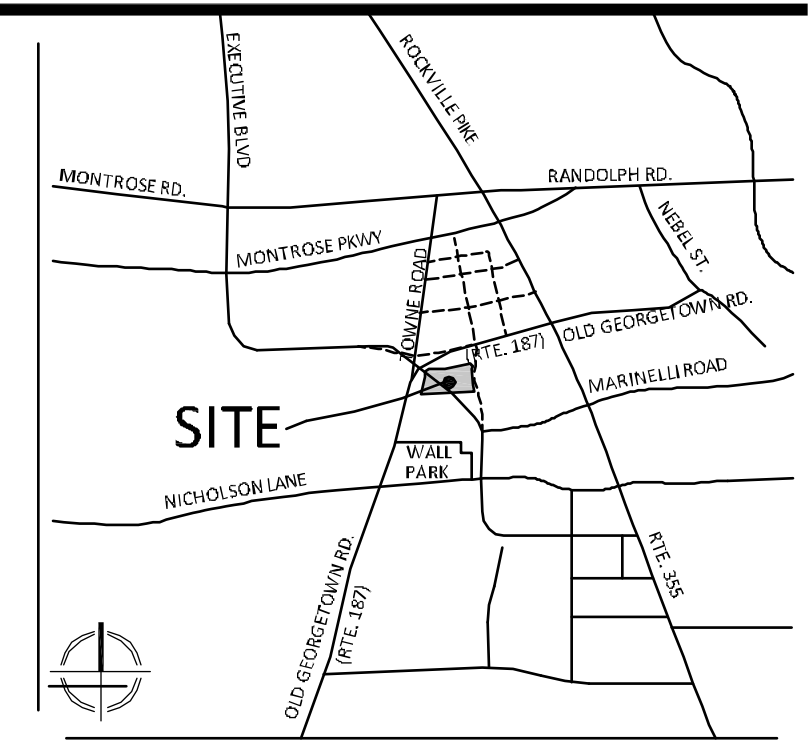

# GABLES WHITE FLINT

Rockville, Maryland

PREPARED FOR:  
LG Georgetown LLC  
8280 Greensboro Drive  
Suite 605  
McLean, VA 22102  
703-919-9503  
Jorgen Pardo

DESIGN CONSULTANTS

ARCHITECTS  
Torti Gallas & Partners  
1300 Spring Street  
Suite 400  
Silver Spring, MD 20910  
301-558-4000  
Danell Ashbury

LANDSCAPE ARCHITECTS  
NAME  
ADDRESS  
PHONE  
CONTACT

ATTORNEY  
Linowes & Blocher  
7200 Wisconsin Avenue  
Suite 800  
Bethesda, MD 20814  
301-654-6504  
Stephen Kaufman

TRAFFIC ENGINEER  
Wells + Associates  
8730 Georgia Avenue  
Suite 200  
Silver Spring, MD 20910  
301-448-1333  
Nancy Flandall

CIVIL ENGINEER  
VIKA MARYLAND, LLC  
20251 CENTURY BOULEVARD  
SUITE 403  
GERMANTOWN MD, 20874  
301.918.4100  
Ian P. Duke

VICINITY MAP  
SCALE: 1" = 2000'

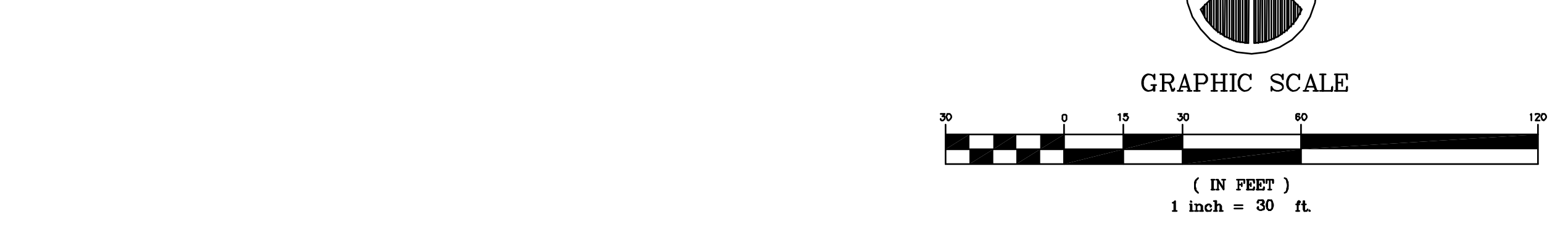
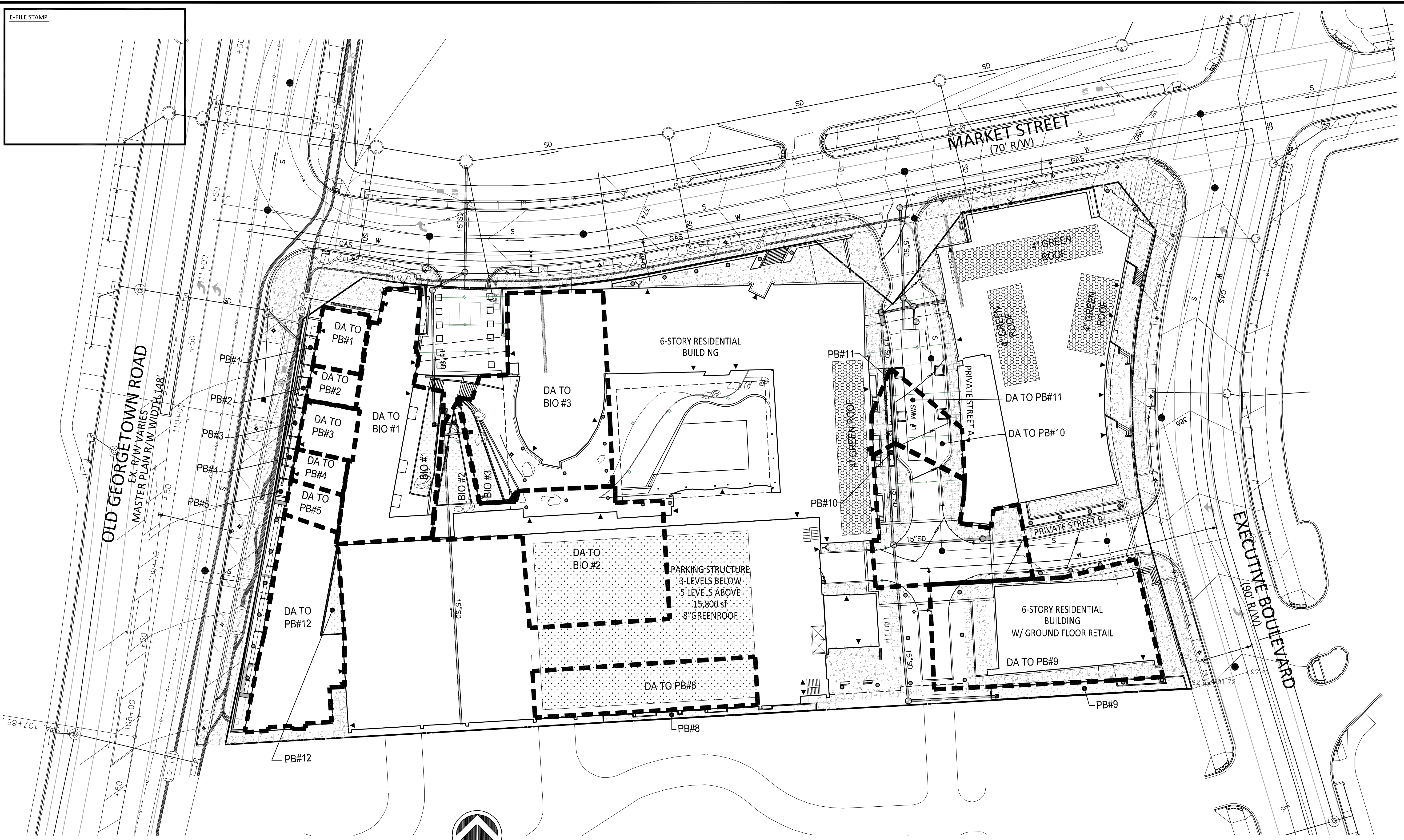

**LEGEND:**

PROP. SEWER		PROPOSED MICRO-BIO RETENTION FACILITY	
PROP. WATER		SWM VAULT/STORM FILTER-SWM-1	
STORM DRAIN PIPE		8" GREEN ROOF	
DA TO MICRO-BIOFILTERS		4" GREEN ROOF	
SWM EASEMENT			

"FOR LOCATION OF UTILITIES CALL 81-1 or 1-800-257-7777 OR LOG ON TO www.call81.com or http://www.mnccppc.net 48 HOURS IN ADVANCE OF ANY WORK IN THIS VICINITY"

The excavator must notify all public utility companies with underground facilities in the area of proposed excavation and have those facilities located by the utility companies prior to commencing excavation. The excavator is responsible for compliance with requirements of Chapter 306 of the Montgomery County Code.

**PROFESSIONAL CERTIFICATION:**  
I HEREBY CERTIFY THAT THESE DOCUMENTS WERE PREPARED OR APPROVED BY ME, AND THAT I AM A DULY LICENSED PROFESSIONAL ENGINEER UNDER THE LAWS OF THE STATE OF MARYLAND.

SIGNATURE: JASON EVANS DATE: JANUARY 16, 2015  
PRINTED NAME: JASON EVANS TITLE: ASSOCIATE EXPIRATION DATE: \_\_\_\_\_  
LICENSE No. 39885

DATE	REVISIONS

**GABLES WHITE FLINT**

PARCELS: P665, N610/P/O N628, & P/O EXECUTIVE BLVD R/W  
1ST ELECTION DISTRICT  
MONTGOMERY COUNTY, MARYLAND  
WSSC GRID: 215 NW 06  
TAX MAP: GQ62

**MNCPPC # 120150010**

**CONCEPT SWM PLAN (PHASE 1)**

DRAWN BY: LWA  
DESIGNED BY: JPD  
DATE ISSUED: \_\_\_\_\_

SHEET NO. CSWM-1