

E-FILE STAMP

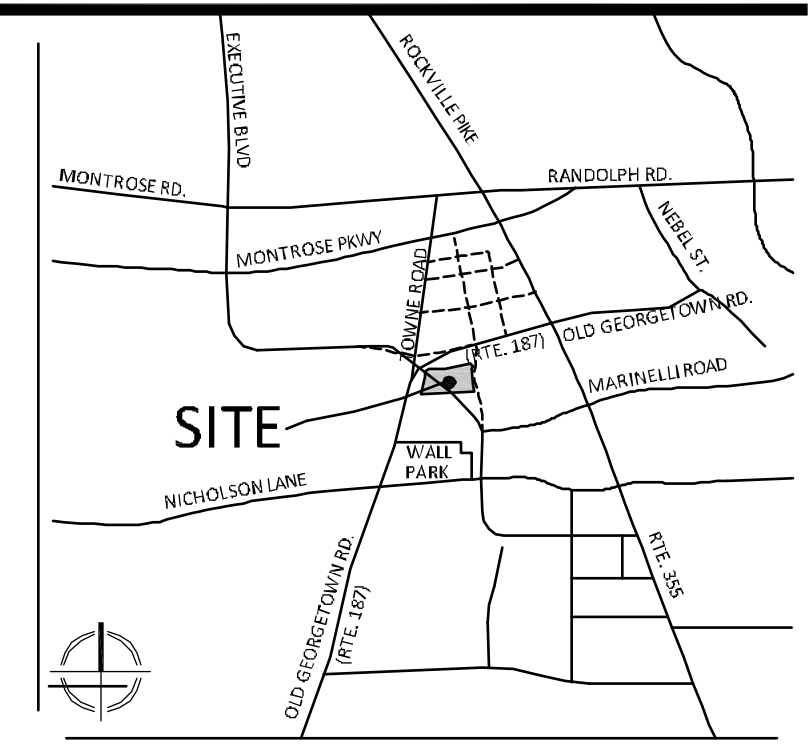

GABLES WHITE FLINT

Rockville, Maryland

PREPARED FOR:
LG Georgetown LLC
8280 Greensboro Drive
Suite 605
McLean, VA 22102
703-919-9500
Jorgen Pardo

DESIGN CONSULTANTS

ARCHITECTS
Torti Gallas & Partners
1300 Spring Street
Suite 400
Silver Spring, MD 20910
301-558-8000
Danell Ashbury

LANDSCAPE ARCHITECTS
NAME
ADDRESS
PHONE
CONTACT

ATTORNEY
Linowes & Blocher
7200 Wilcoxon Avenue
Suite 800
Bethesda, MD 20814
301-654-9504
Stephen Kaufman

TRAFFIC ENGINEER
Wells + Associates
8730 Georgia Avenue
Suite 200
Silver Spring, MD 20910
301-448-1333
Nancy Flandall

CIVIL ENGINEER
Vika Maryland, LLC
20251 CENTURY BOULEVARD
SUITE 400
GERMANTOWN MD, 20874
301.918.4100
Ian P. Duke

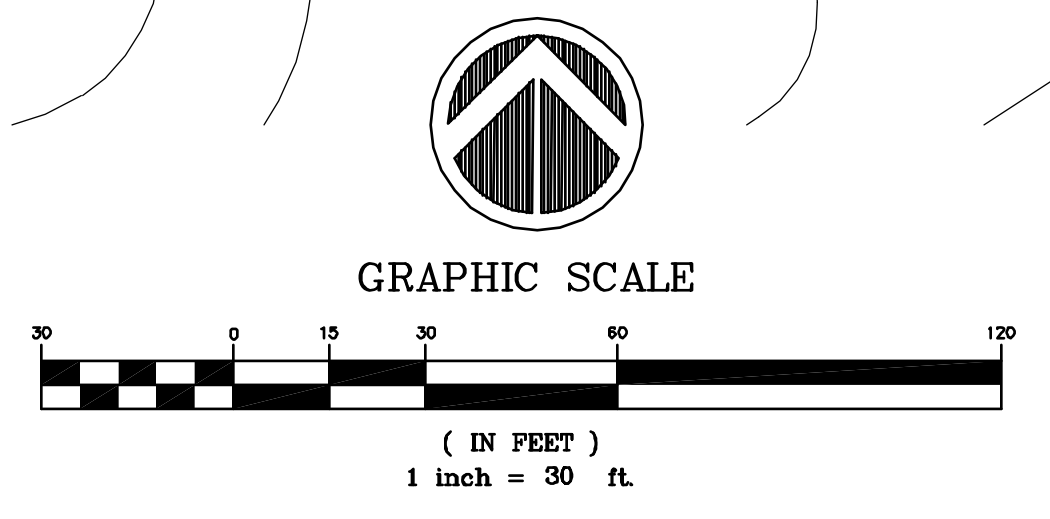
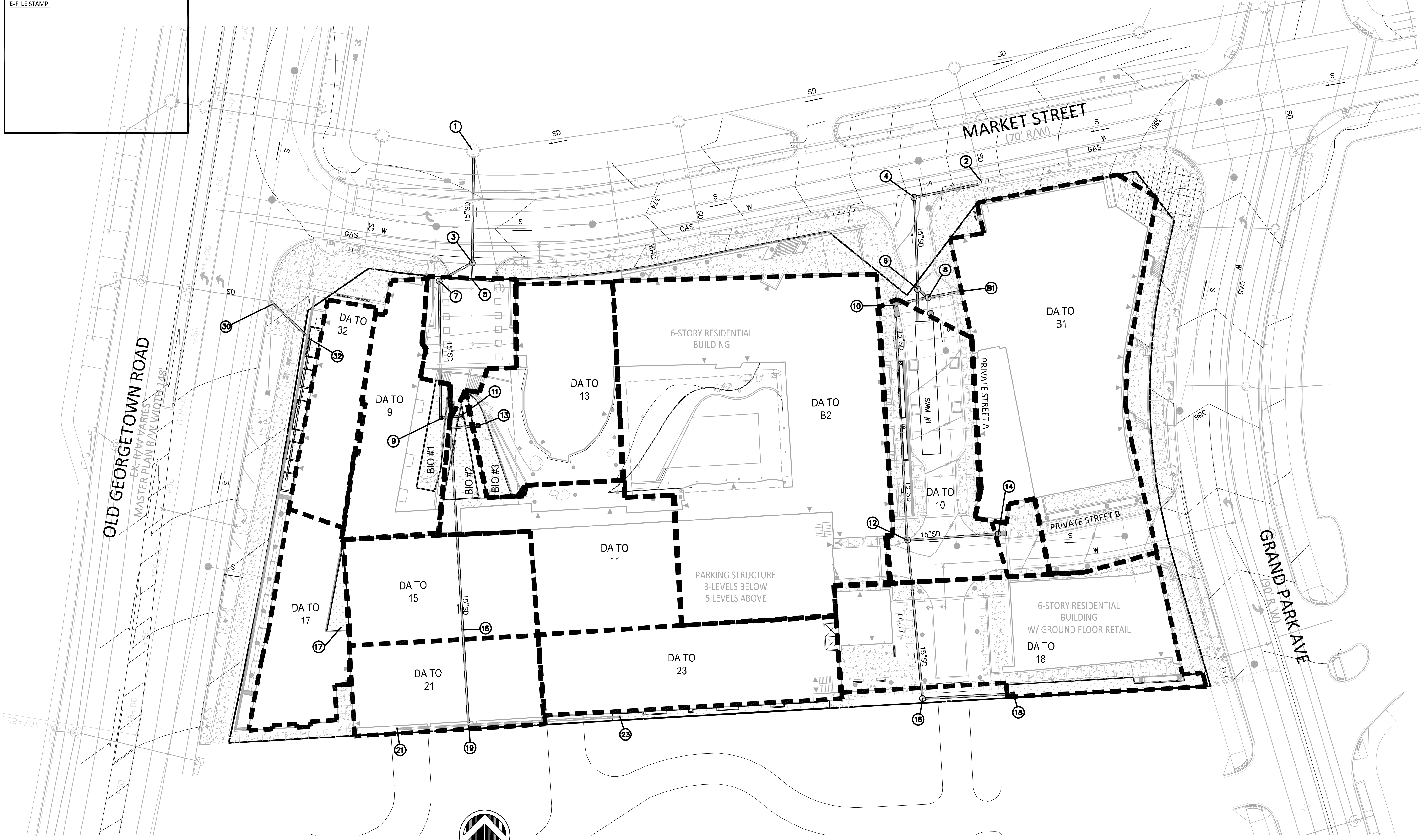

10YR. STORM DRAIN COMPUTATION																		28-JUL-14	
FROM	TO	INC. AREA ACRES	TOTAL AREA ACRES	C	A*C	ACUM. A*C	Tc MIN-SEC	I 10 YR IN/HR	Q10 CFS	MIN SLOPE %	ACT SLOPE %	n	PIPE SIZE IN	F.F. VEL FFS	ACT VEL FFS	LENGTH FEET	TIME IN PIPE MIN	Q CAPACITY CFS	
32	31	0.11	0.11	0.90	0.10	0.10	5.00	7.07	0.7	0.01	1.00	0.013	15	5.26	3.2	33	0.17	6.46	
23	19	0.24	0.24	0.90	0.22	0.22	5.00	7.07	1.5	0.06	1.00	0.013	15	5.26	4.3	98	0.38	6.46	
21	19	0.18	0.18	0.90	0.16	0.16	5.00	7.07	1.1	0.03	1.00	0.013	15	5.26	3.9	47	0.20	6.46	
19	15	0.00	0.42	0.90	0.00	0.38	5.38	6.96	2.6	0.17	1.00	0.013	15	5.26	4.9	63	0.21	6.46	
17	15	0.15	0.15	0.90	0.14	0.14	5.00	7.07	1.0	0.02	1.00	0.013	15	5.26	3.7	78	0.35	6.46	
15	13	0.18	0.75	0.90	0.16	0.68	5.59	6.90	4.7	0.52	1.00	0.013	15	5.26	5.7	139	0.41	6.46	
13	11	0.25	1.00	0.70	0.18	0.85	6.00	6.78	5.8	0.80	1.00	0.013	15	5.26	5.9	17	0.05	6.46	
11	10	0.26	1.26	0.70	0.18	1.03	6.05	6.77	7.0	0.44	1.00	0.013	18	5.94	6.3	10	0.03	10.50	
10	9	2.25	2.25	0.90	0.00	1.81	6.07	6.76	12.2	1.35	1.00	0.013	18	5.94	5.9	10	0.03	10.50	
9	7	0.19	2.44	0.70	0.13	1.94	6.10	6.76	13.1	1.55	1.00	0.013	18	5.94	5.9	86	0.24	10.50	
7	3	0.00	2.44	0.00	0.00	1.94	6.34	6.69	13.0	1.52	1.00	0.013	18	5.94	5.9	22	0.06	10.50	
5	3	0.09	0.09	0.90	0.08	0.08	5.00	7.07	0.6	0.01	1.00	0.013	15	5.26	3.2	9	0.05	6.46	
3	1	0.00	2.53	0.90	0.00	2.02	6.40	6.68	13.5	1.65	1.00	0.013	18	5.94	5.9	67	0.19	10.50	
18	16	0.38	0.38	0.90	0.34	0.34	5.00	7.07	2.4	0.14	1.00	0.013	15	5.26	4.8	57	0.20	6.46	
16	12	0.00	0.38	0.90	0.00	0.34	5.20	7.01	2.4	0.14	1.00	0.013	15	5.26	4.8	102	0.35	6.46	
14	12	0.02	0.02	0.90	0.02	0.02	5.00	7.07	0.1	0.00	1.00	0.013	15	5.26	1.7	56	0.56	6.46	
12	10	0.00	0.40	0.90	0.00	0.36	5.55	6.91	2.5	0.15	1.00	0.013	15	5.26	4.8	151	0.52	6.46	
B2	10	0.59	0.59	0.70	0.41	0.41	7.00	6.52	2.7	0.17	1.00	0.013	15	5.26	5.0	10	0.03	6.46	
10	8	0.26	2.51	0.90	0.23	2.04	7.03	6.52	13.3	0.70	1.00	0.013	21	6.59	7.4	19	0.04	15.85	
B1	8	0.81	0.81	0.90	0.73	0.73	5.00	7.07	5.2	0.64	1.00	0.013	15	5.26	5.8	10	0.03	6.46	
8	6	0.00	3.32	0.90	0.00	2.77	7.08	6.50	18.0	0.63	1.00	0.013	24	7.20	8.0	6	0.01	22.62	
6	4	0.00	3.32	0.90	0.00	2.77	7.09	6.50	18.0	0.63	1.00	0.013	24	7.20	8.0	56	0.12	22.62	
4	2	0.00	3.32	0.90	0.00	2.77	7.21	6.47	17.9	0.63	1.00	0.013	24	7.20	8.0	41	0.09	22.62	

"FOR LOCATION OF UTILITIES CALL 81-1 or 1-800-257-7777 OR LOG ON TO www.call81.com or http://www.mnccpp.net 48 HOURS IN ADVANCE OF ANY WORK IN THIS VICINITY"

The excavator must notify all public utility companies with underground facilities in the area of proposed excavation and have those facilities located by the utility companies prior to commencing excavation. The excavator is responsible for compliance with requirements of Chapter 366 of the Montgomery County Code.

PROFESSIONAL CERTIFICATION:
I HEREBY CERTIFY THAT THESE DOCUMENTS WERE PREPARED OR APPROVED BY ME, AND THAT I AM A DULY LICENSED PROFESSIONAL ENGINEER UNDER THE LAWS OF THE STATE OF MARYLAND.

SIGNATURE: JASON EVANS
PRINTED NAME: JASON EVANS
TITLE: ASSOCIATE

DATE: JANUARY 16, 2015
EXPIRATION DATE:

LICENSE No. 39885

DATE	REVISIONS

PROFESSIONAL SEAL

GABLES WHITE FLINT

PARCELS: P665, N610/P/O N628, & P/O EXECUTIVE BLVD R/W
1ST ELECTION DISTRICT
MONTGOMERY COUNTY, MARYLAND
WSSC GRID: 215 NW 06
TAX MAP: GQ62

MNCPPC
120150010

DRAINAGE STUDY

DRAWN BY: LWA
DESIGNED BY: JPD
DATE ISSUED:

SHEET NO. DAM-1