

E-FILE STAMP

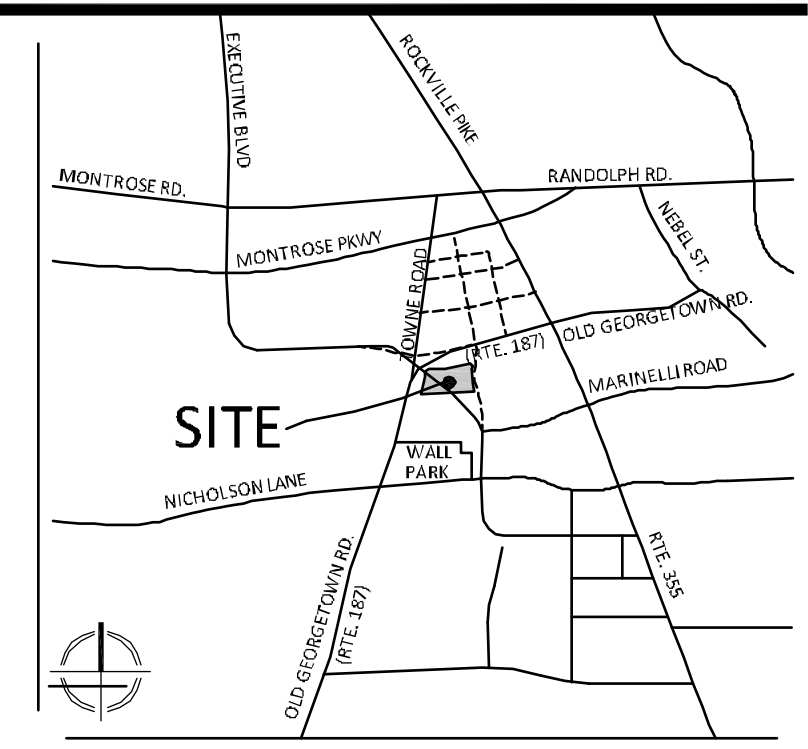
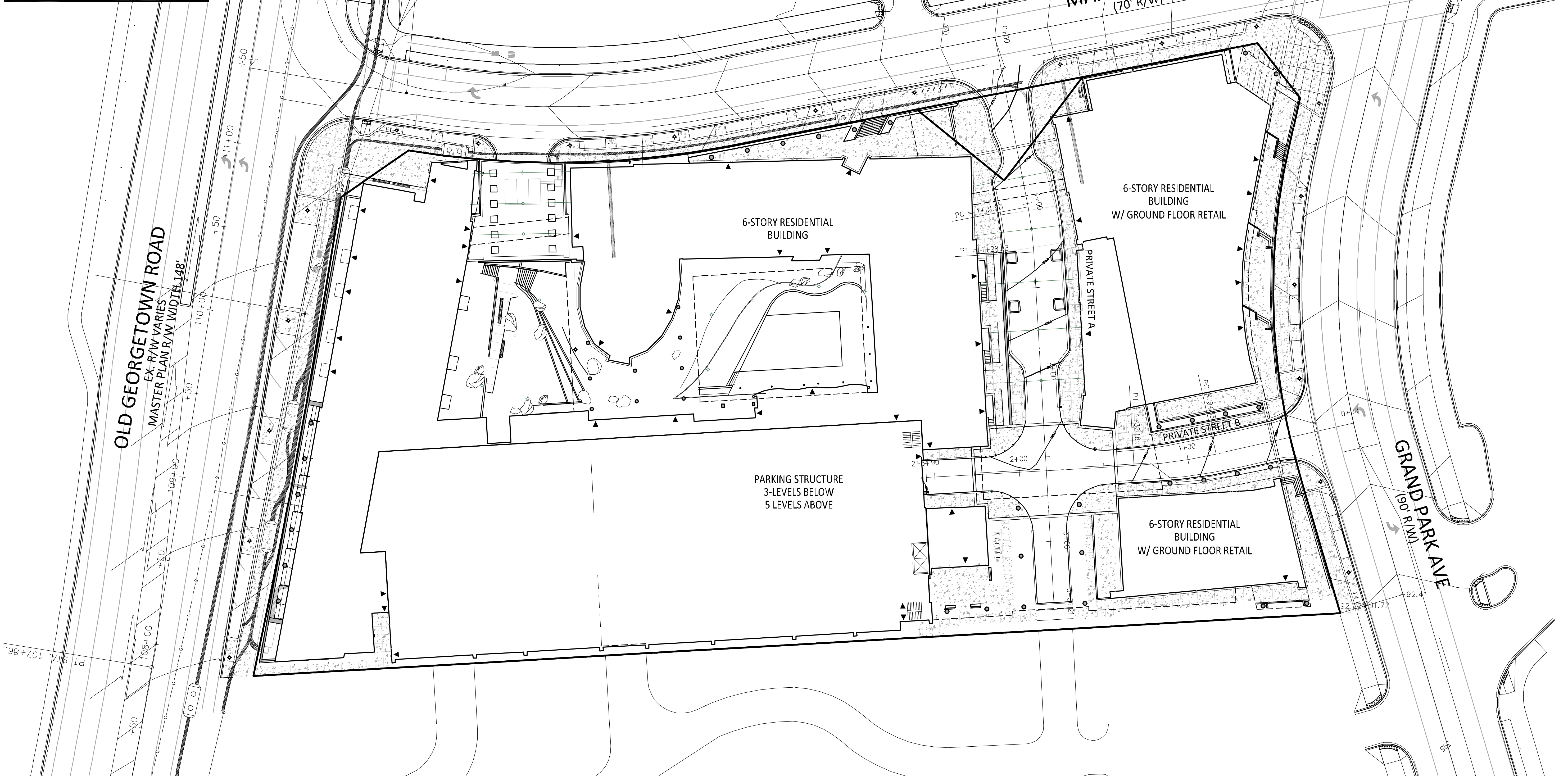

GABLES WHITE FLINT

Rockville, Maryland

DESIGN CONSULTANTS
ARCHITECTS
Torti Gallas & Partners

LANDSCAPE ARCHITECTS
NAME
ADDRESS

ATTORNEY
Linowes & Blocher

TRAFFIC ENGINEER
Wells + Associates

CIVIL ENGINEER
VIKA MARYLAND, LLC

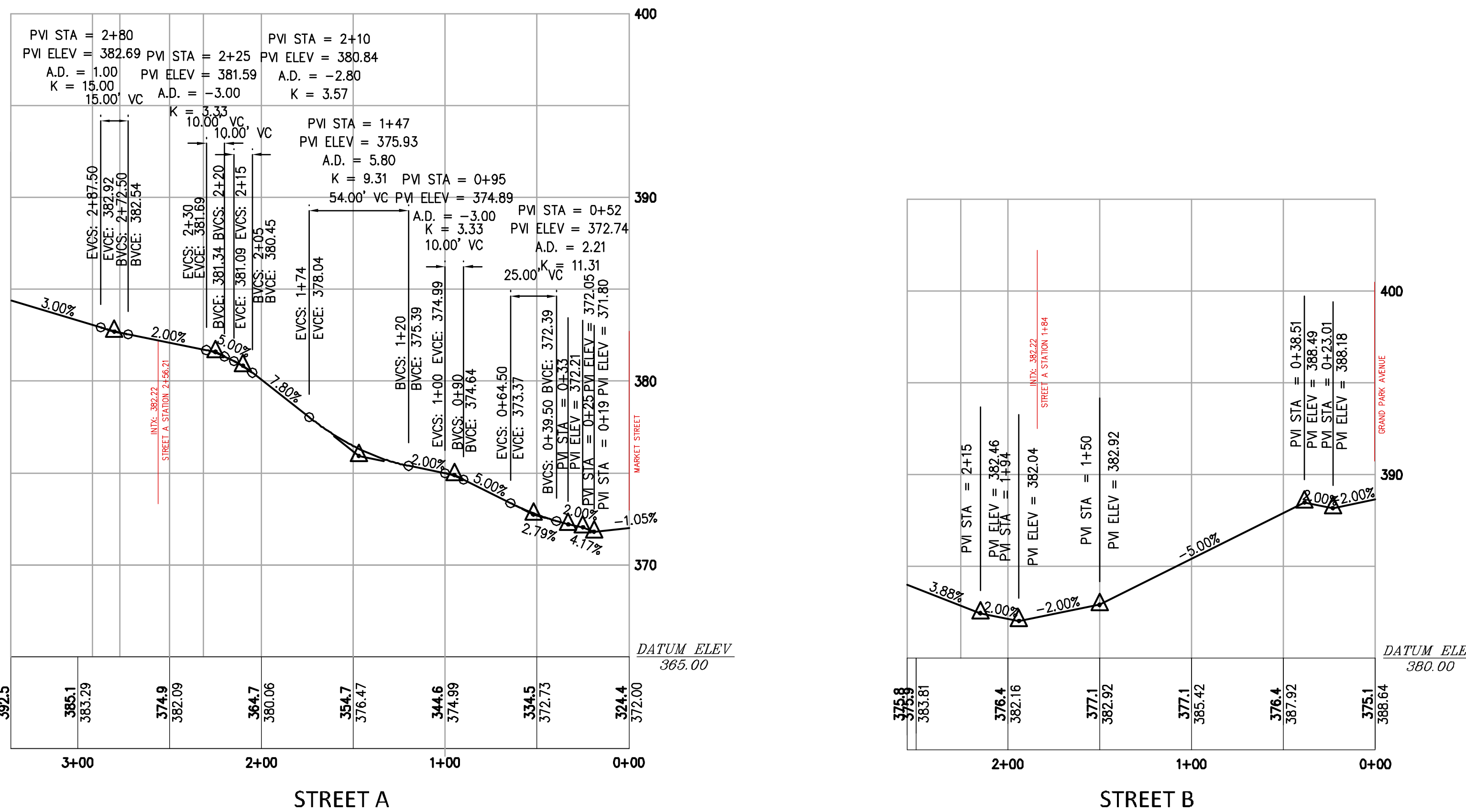
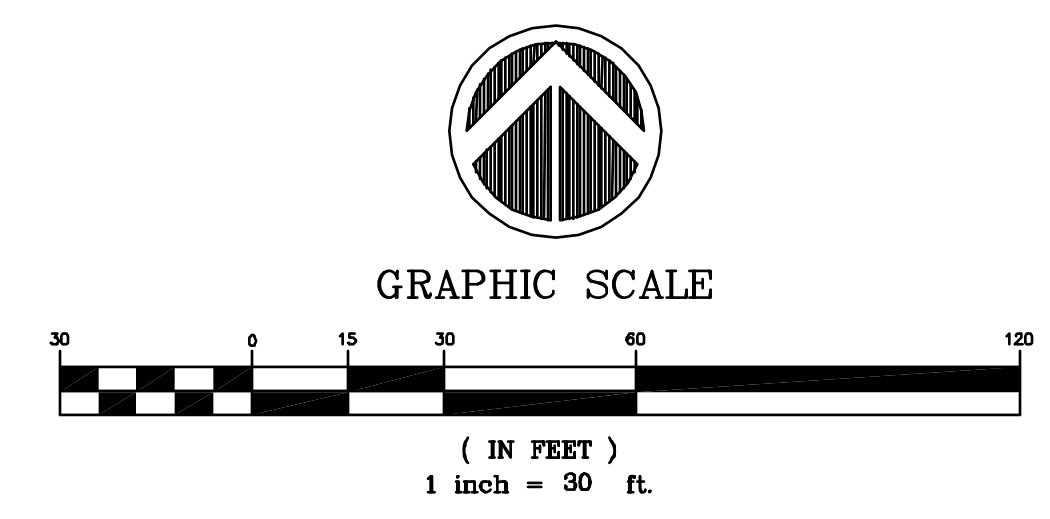

"FOR LOCATION OF UTILITIES CALL 81-1 or 1-800-257-7777 OR LOG ON TO www.call81.com or http://www.montgomery.net 48 HOURS IN ADVANCE OF ANY WORK IN THIS VICINITY"

PROFESSIONAL CERTIFICATION:
I HEREBY CERTIFY THAT THESE DOCUMENTS WERE PREPARED OR APPROVED BY ME, AND THAT I AM A DULY LICENSED PROFESSIONAL ENGINEER UNDER THE LAWS OF THE STATE OF MARYLAND.

SIGNATURE: JASON EVANS
DESIGNED BY: JPD
TITLE: ASSOCIATE

DATE: JANUARY 16, 2015
EXPIRATION DATE:

LICENSE No. 39885

| DATE | REVISIONS |
|------|-----------|
| | |
| | |
| | |
| | |

GABLES WHITE FLINT

PARCELS: P665, N610/P/O N628, & P/O EXECUTIVE BLVD R/W
1ST ELECTION DISTRICT
MONTGOMERY COUNTY, MARYLAND
WSSC GRID: 215 NW 06
TAX MAP: GQ62
MNCPPC
120150010

STREET PROFILES

DRAWN BY: LWA
DESIGNED BY: JPD
DATE ISSUED:

SHEET NO. GEP-1