

VICINITY MAP
SCALE: 1" = 2000'



ENGINEERS PLANNERS
LANDSCAPE ARCHITECTS SURVEYORS
VKA MARYLAND, LLC
20251 CENTURY BOULEVARD, SUITE 400
GERMANTOWN, MARYLAND 20874
PHONE: (301) 916-4100
FAX: (301) 916-2262
GERMANTOWN, MD. MCLEAN, VA.

PREPARED FOR:
USL2 MR
MONTGOMERY VILLAGE
BUSINESS TRUST
c/o MONUMENT REALTY
750 17th STREET, NW, SUITE 1100
WASHINGTON, DC 20006
202.777.2010
RUSSELL HINES

DESIGN CONSULTANTS

ARCHITECTS
TORTI GALLAS AND
PARTNERS, INC.
1300 SPRING STREET, SUITE 400
SILVER SPRING, MD 20910
301.588.4800
ERIK J. AULESTIA

ATTORNEY
LERCH, EARLY & BREWER
CHTD.
3 BETHESDA METRO CENTER
SUITE 460
BETHESDA, MD 20814
301.841.3832
PATRICIA HARRIS

TRAFFIC ENGINEER
WELLS + ASSOCIATES
8730 GEORGIA AVENUE, SUITE 200
SILVER SPRING, MD 20910
301.448.1333
KEVIN BERGER

LANDSCAPE ARCHITECT
VKA MARYLAND, LLC
20251 CENTURY BOULEVARD
SUITE 400
GERMANTOWN MD, 20874
301.916.4100
JOSH SLOAN

CIVIL ENGINEER
VKA MARYLAND, LLC
20251 CENTURY BOULEVARD
SUITE 400
GERMANTOWN MD, 20874
301.916.4100
MIKE GOODMAN

REVISIONS	DATE
DRC COMMENTS	08/09/17
REVIEWERS	08/31/17
COMMENTS	



I HEREBY CERTIFY THAT THESE DOCUMENTS WERE
PREPARED OR APPROVED BY ME, AND THAT I AM A DULY
LICENSED, REGISTERED LANDSCAPE ARCHITECT UNDER
THE LAWS OF THE STATE OF MARYLAND.
NAME: JOSHUA SLOAN, P.L.A. A.L.A.
LICENSE NUMBER: 3776
EXPIRATION DATE: 12/31/2018

BLOOM MV
AREA I-VI

9TH ELECTION DISTRICT
MONTGOMERY COUNTY,
MARYLAND
WSSC GRID: 227NW09
TAX MAP: FU342

SP# 820170130

AREA 4
COMPOSITE
HARDSCAPE
PLAN

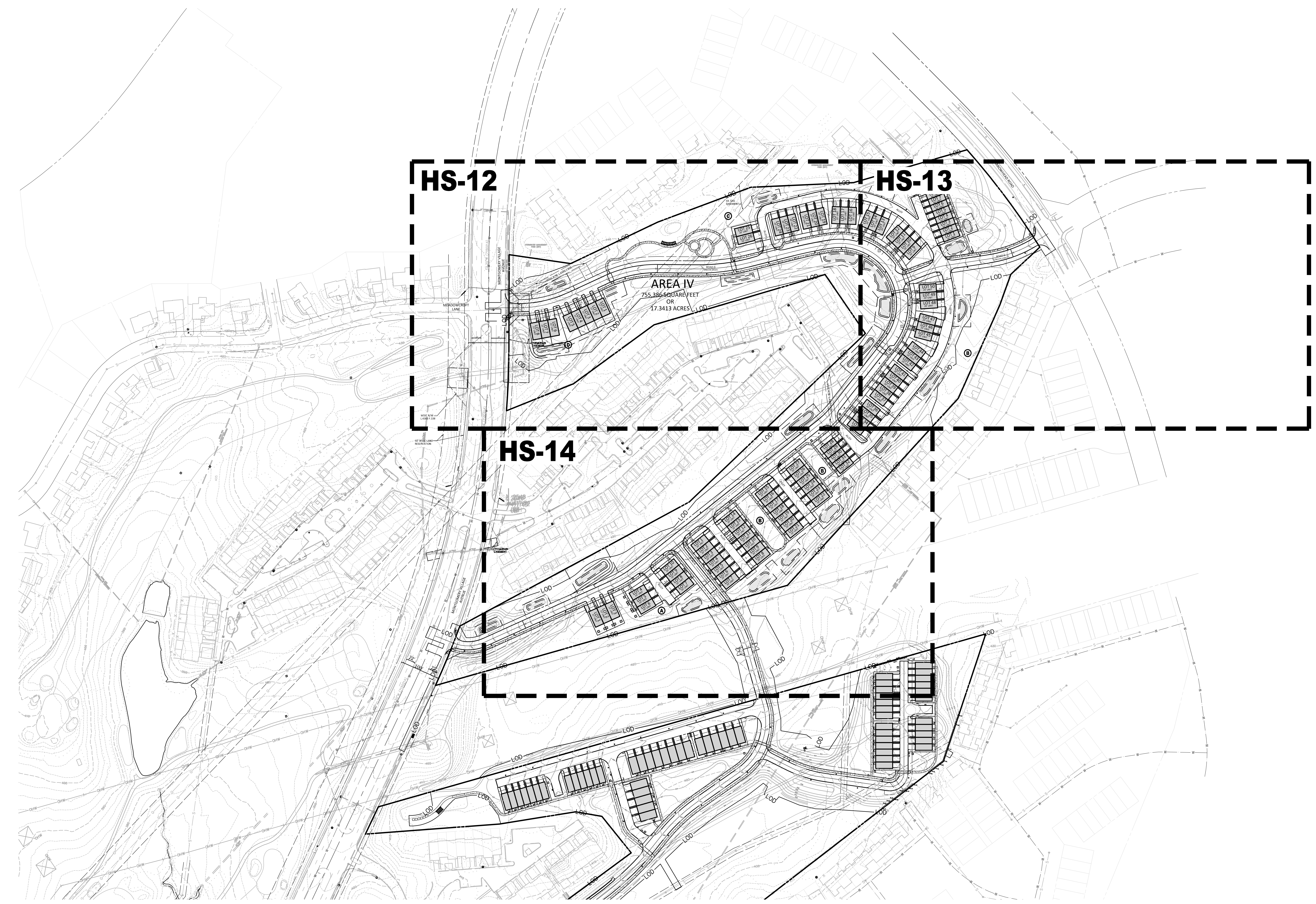

DEVELOPER'S CERTIFICATE
The undersigned agrees to execute all the features of the Site Plan Approval
No. 820170130, including Approval Conditions, Development Program,
and Certified Site Plan.

Developer's Name: USL2 MR Montgomery Village Business Trust
Contact Person: Russell Hines
Address: 2200 K Street, NW, Suite 600, Washington, DC 20006
Phone: 202.777.2010
Signature: _____ Date: _____

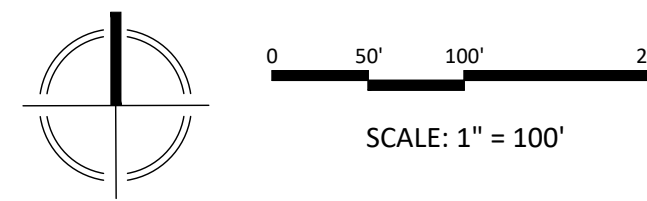

NOTE: SCHEMATIC DESIGN FOR ENTITLEMENT ONLY.
NOT FOR CONSTRUCTION OR BIDDING PURPOSES.

LAYOUT: HS-11, Plotted By: grimm

DRAWN BY: PJS
DESIGNED BY: DLK-JS-SCM
DATE ISSUED: May 5, 2017
VKA PROJECT: VM1920
DRAWING NO.: XXX
SHEET NO.: HS-11