

PLAN LEGEND

Table with 4 columns listing various symbols and their corresponding descriptions for utility lines, proposed features, existing structures, and landscape elements.

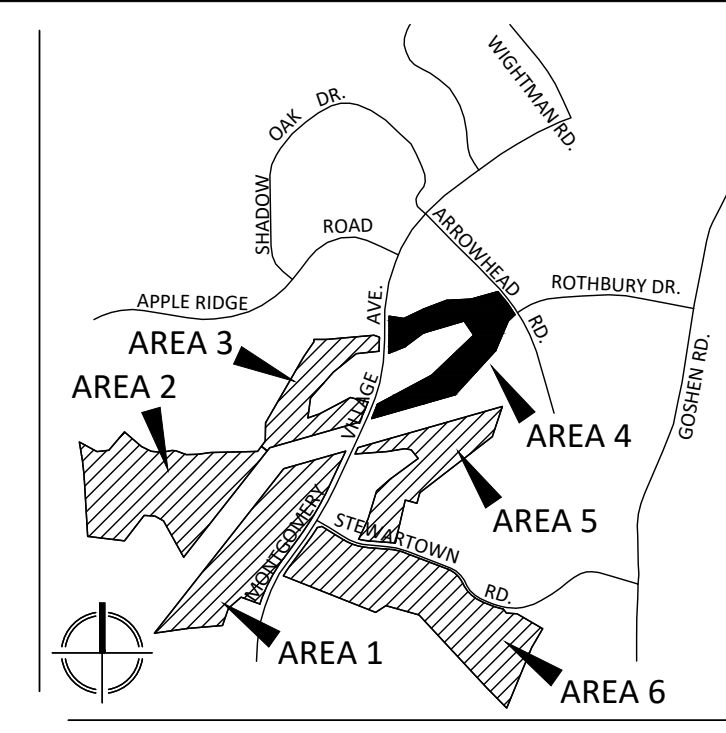

VICINITY MAP SCALE: 1" = 2000'



Prepared for: USL2 MR MONTGOMERY VILLAGE BUSINESS TRUST c/o MONUMENT REALTY

Design Consultants: ARCHITECTS TORTI GALLAS AND PARTNERS, INC.

Attorney: LERCH, EARLY & BREWER

Traffic Engineer: WELLS + ASSOCIATES

Landscape Architect: VIKA MARYLAND, LLC

Civil Engineer: VIKA MARYLAND, LLC

Revisions table with columns for 'REVISIONS' and 'DATE', containing several empty rows.

Professional Seal for Joshua Sloan, a Licensed Landscape Architect in the State of Maryland.

Bloom MV Area I-VI, 9th Election District, Montgomery County, Maryland. WSSC Grid: 227NW09, Tax Map: FU342, SP# 820170130.

AREA 4 DETAILED HARDSCAPE PLAN

Developer's Certificate information: DRAWN BY: PJS, DESIGNED BY: DLK-JS-SCM, DATE ISSUED: May 5, 2017.

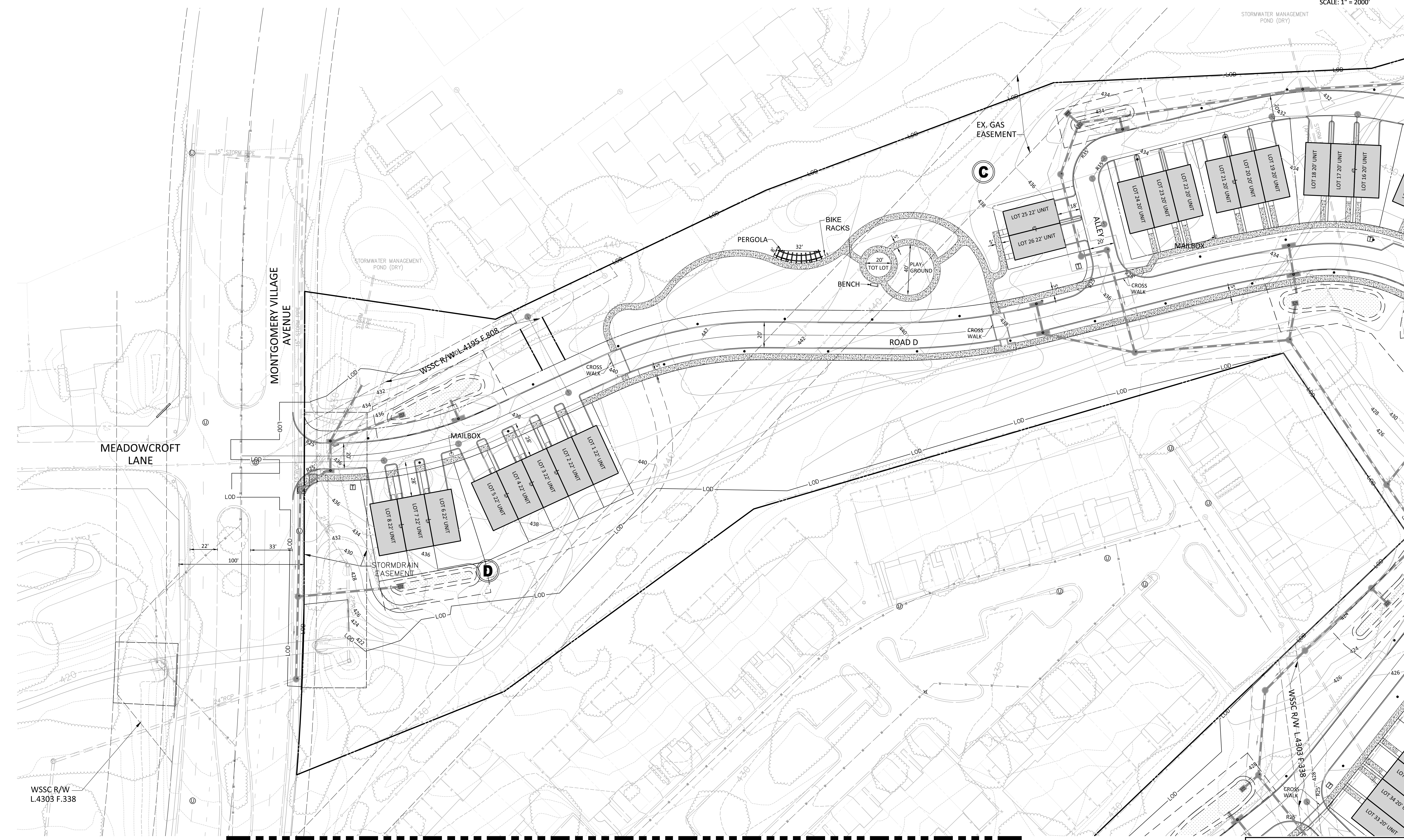

NOTE: SCHEMATIC DESIGN FOR ENTITLEMENT ONLY. NOT FOR CONSTRUCTION OR BIDDING PURPOSES.

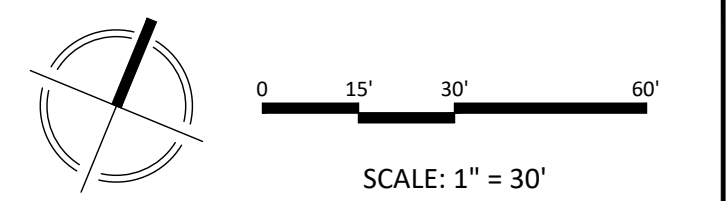

Developer's Certificate box with signature lines for the developer and professional seal area.