

PLAN LEGEND

— CTY —	PROPERTY LINES	— 8" W —	PROPOSED WATER LINE	— 8" S —	PROPOSED SANITARY SEWER WITH STRUCTURE	— () —	EXISTING GUY POLE	— () —	EXISTING BOLLARD	— () —	BUILDING HEIGHT MEASURING POINT
— E —	EXISTING CABLE TELEVISION CONDUIT	— () —	PROPOSED SANITARY SEWER WITH STRUCTURE	— () —	PROPOSED STORM DRAIN	— () —	EXISTING GAS VALVE	— () —	EXISTING SIGN POST	— () —	PROPOSED BIKE RACKS
— X —	EXISTING ELECTRIC CONDUIT	— () —	PROPOSED STORM DRAIN	— () —	PROPOSED LIMITS OF DISTURBANCE	— () —	EXISTING LIGHT POLE	— () —	EXISTING WOOD POST	— () —	PROPOSED LIGHTS
— G —	EXISTING FENCE LINE	— () —	PROPOSED STORM WATER EASEMENT	— () —	EXISTING PARKING LABEL	— () —	EXISTING PHONE PEDESTAL	— () —	EXISTING INLETS	— () —	PEDESTRIAN LIGHTS
— S —	EXISTING NATURAL GAS CONDUIT	— () —	EXISTING PARKING LABEL	— () —	EXISTING SANITARY CLEANOUT	— () —	EXISTING TELEPHONE CONDUIT	— () —	EXISTING CURB INLET	— () —	PROPOSED PARKING LABELS
— T —	EXISTING OVERHEAD WIRES	— () —	EXISTING SANITARY CLEANOUT	— () —	EXISTING STORM DRAIN MANHOLE	— () —	EXISTING TELEPHONE CONDUIT	— () —	EXISTING CONCRETE	— () —	PROPOSED HARDSCAPE
— T —	EXISTING TELEPHONE CONDUIT	— () —	EXISTING STORM DRAIN MANHOLE	— () —	EXISTING ELECTRICAL JUNCTION BOX	— () —	EXISTING TELEPHONE CONDUIT	— () —	EXISTING CURB AND GUTTER	— () —	PROPOSED FIRE HYDRANT
— T —	EXISTING PUBLIC UTILITIES EASEMENTS	— () —	EXISTING ELECTRICAL JUNCTION BOX	— () —	EXISTING ELECTRICAL MANHOLE	— () —	EXISTING TELEPHONE CONDUIT	— () —	EXISTING BUILDING	— () —	DOOR LOCATION
— S —	EXISTING SANITARY SEWER CONDUIT	— () —	EXISTING ELECTRICAL MANHOLE	— () —	EXISTING UNKNOWN UTILITY MANHOLE	— () —	EXISTING TELEPHONE CONDUIT	— () —	EXISTING STORY	— () —	PROPOSED SWM FACILITY
— S —	EXISTING STORM DRAIN CONDUIT	— () —	EXISTING UNKNOWN UTILITY MANHOLE	— () —	EXISTING FIRE DEPARTMENT CONNECTION	— () —	EXISTING TELEPHONE CONDUIT	— () —	EXISTING ELECTRICAL TRANSFORMER	— () —	DOOR LOCATION
— V —	EXISTING WATER CONDUIT	— () —	EXISTING FIRE DEPARTMENT CONNECTION	— () —	EXISTING WATER METER	— () —	EXISTING TELEPHONE CONDUIT	— () —	EXISTING ASPHALT	— () —	PROPOSED SWM FACILITY
— 520 —	PROPOSED 10' CONTOUR	— () —	EXISTING WATER METER	— () —	EXISTING FIRE HYDRANT	— () —	EXISTING TELEPHONE CONDUIT	— () —	EXISTING REINFORCED CONCRETE PIPE	— () —	DOOR LOCATION
— 524 —	PROPOSED 2' CONTOUR	— () —	EXISTING WATER VALVE	— () —	EXISTING GAS MANHOLE	— () —	EXISTING TELEPHONE CONDUIT	— () —	EXISTING CORRUGATED METAL PIPE	— () —	PROPOSED SWM FACILITY WITH CHEEK WALL AND CURB CUT

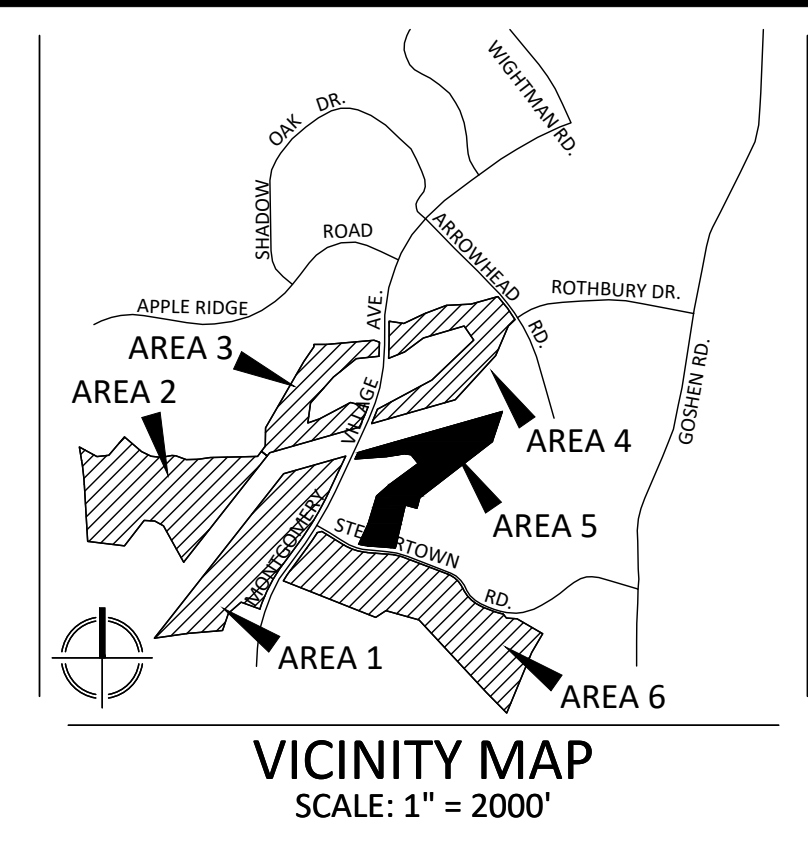

PREPARED FOR:
USL2 MR
MONTGOMERY VILLAGE BUSINESS TRUST
c/o MONUMENT REALTY
 1700 K STREET, NW, SUITE 600
 WASHINGTON, DC 20006
 202.777.2010
 RUSSELL HINES

DESIGN CONSULTANTS

ARCHITECTS
TORTI GALLAS AND PARTNERS, INC.
 1300 SPRING STREET, SUITE 400
 SILVER SPRING, MD 20910
 301.588.4800
 ERIK J. AULESTIA

ATTORNEY
LERCH, EARLY & BREWER CHTD.
 3 BETHESDA METRO CENTER
 SUITE 460
 BETHESDA, MD 20814
 301.841.3832
 PATRICIA HARRIS

TRAFFIC ENGINEER
WELLS + ASSOCIATES
 8730 GEORGIA AVENUE, SUITE 200
 SILVER SPRING, MD 20910
 301.448.1333
 KEVIN BERGER

LANDSCAPE ARCHITECT
VIKA MARYLAND, LLC
 20251 CENTURY BOULEVARD SUITE 400
 GERMANTOWN MD, 20874
 301.916.4100
 JOSH SLOAN

CIVIL ENGINEER
VIKA MARYLAND, LLC
 20251 CENTURY BOULEVARD SUITE 400
 GERMANTOWN MD, 20874
 301.916.4100
 MIKE GOODMAN

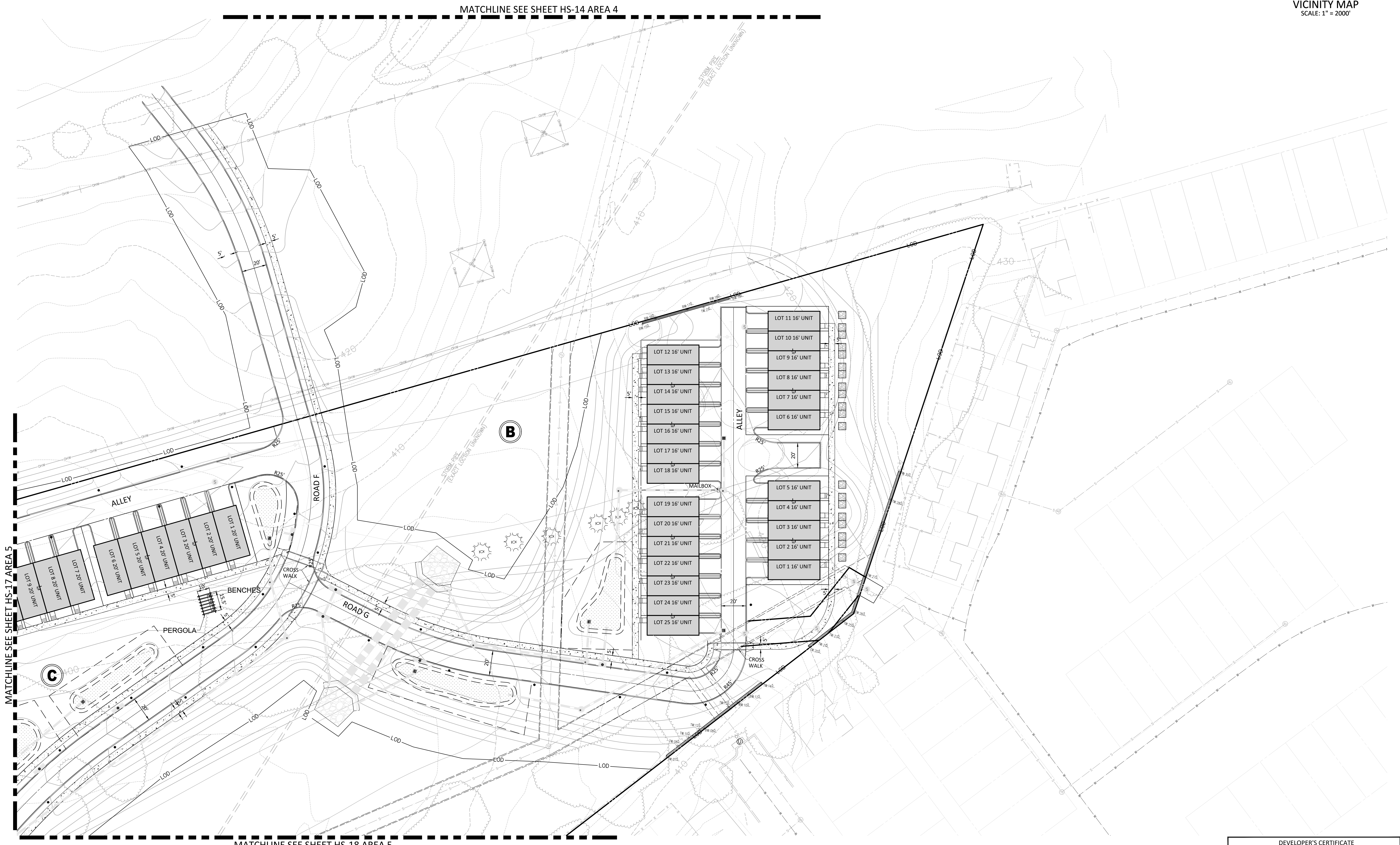

REVISIONS	DATE

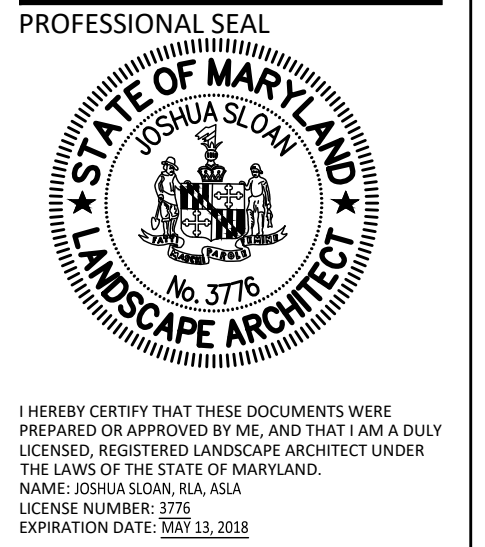

BLOOM MV
AREA I-VI

9TH ELECTION DISTRICT
 MONTGOMERY COUNTY,
 MARYLAND
 WSSC GRID: 227NW09
 TAX MAP: FU342

SP# 820170130

AREA 5
DETAILED
HARDSCAPE
PLAN

DEVELOPER'S CERTIFICATE

The undersigned agrees to execute all the features of the Site Plan Approval No. 820170130, including Approval Conditions, Development Program, and Certified Site Plan.

Developer's Name: USL2 MR Montgomery Village Business Trust

Contact Person: Russell Hines

Address: 1300 K Street, NW, Suite 600, Washington, DC 20006

Phone: 202.777.2010

Signature: _____ Date: _____

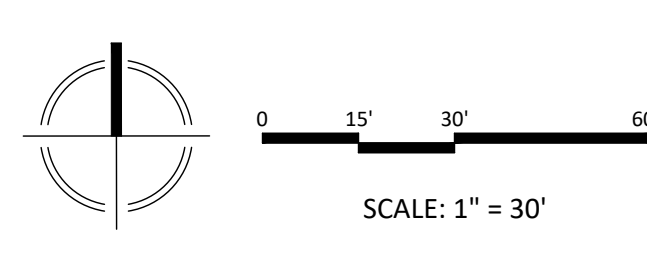

NOTE: SCHEMATIC DESIGN FOR ENTITLEMENT ONLY. NOT FOR CONSTRUCTION OR BIDDING PURPOSES.

LAYOUT: HS-16, Plotted By: schalln