

PLAN LEGEND

	PROPERTY LINES		PROPOSED WATER LINE		EXISTING GUY POLE		BUILDING HEIGHT MEASURING POINT
	EXISTING CABLE TELEVISION CONDUIT		PROPOSED SANITARY SEWER WITH STRUCTURE		EXISTING GAS VALVE		PROPOSED BIKE BACKS
	EXISTING EDGE OF PAVEMENT		PROPOSED STORM DRAIN		EXISTING LIGHT POLE		PROPOSED LIGHTS
	EXISTING FENCE LINE		PROPOSED LIMITS OF DISTURBANCE		EXISTING PHONE PEDESTAL		PEDESTRIAN LIGHTS
	EXISTING NATURAL GAS CONDUIT		PROPOSED STORM WATER EASEMENT		EXISTING PHONE MANHOLE		PROPOSED PARKING LABELS
	EXISTING OVERHEAD WIRES		EXISTING SANITARY CLEANOUT		EXISTING UTILITY POLE		PROPOSED CONCRETE PATH
	EXISTING TELEPHONE CONDUIT		EXISTING SANITARY MANHOLE		EXISTING SANITARY MANHOLE WITH STRUCTURE		PROPOSED ASPHALT PATH
	EXISTING PUBLIC UTILITIES EASEMENTS		EXISTING STORM DRAIN MANHOLE		EXISTING TREE		PROPOSED FIRE HYDRANT
	EXISTING SANITARY SEWER CONDUIT		EXISTING ELECTRICAL JUNCTION BOX		EXISTING BUILDING		DOOR LOCATION
	EXISTING STORM DRAIN CONDUIT		EXISTING ELECTRICAL MANHOLE		EXISTING ELECTRICAL TRANSFORMER		PROPOSED SWM FACILITY
	EXISTING WATER CONDUIT		EXISTING FIRE DEPARTMENT CONNECTION		EXISTING REINFORCED CONCRETE PIPE		FACILITY WITH CHEEK WALL AND CURB CUT
	EXISTING ZONE LIMITS		EXISTING FIRE HYDRANT		EXISTING CORRUGATED METAL PIPE		PROPOSED RETAINING WALL
	STREAM VALLEY BUFFER		EXISTING GAS MANHOLE		EXISTING BUILDING RESTRICTION LINE		PROPOSED STORM DRAIN
	100 YEAR FLOODPLAIN				EXISTING RIGHT-OF-WAY		PROPOSED MAIL BOX
	100 YEAR FLOODPLAIN BUFFER						
	520						
	524						

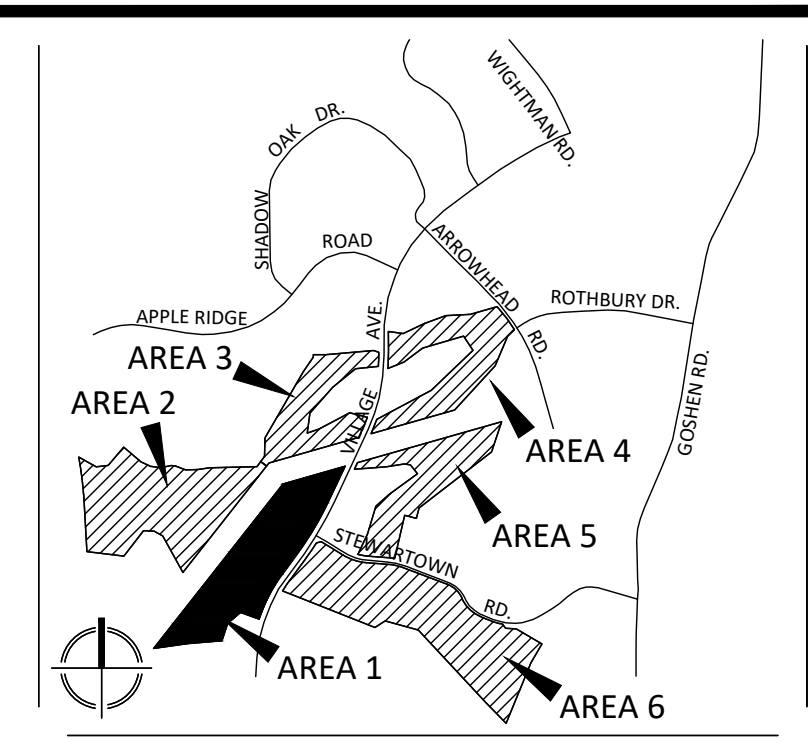

VICINITY MAP
SCALE: 1" = 2000'

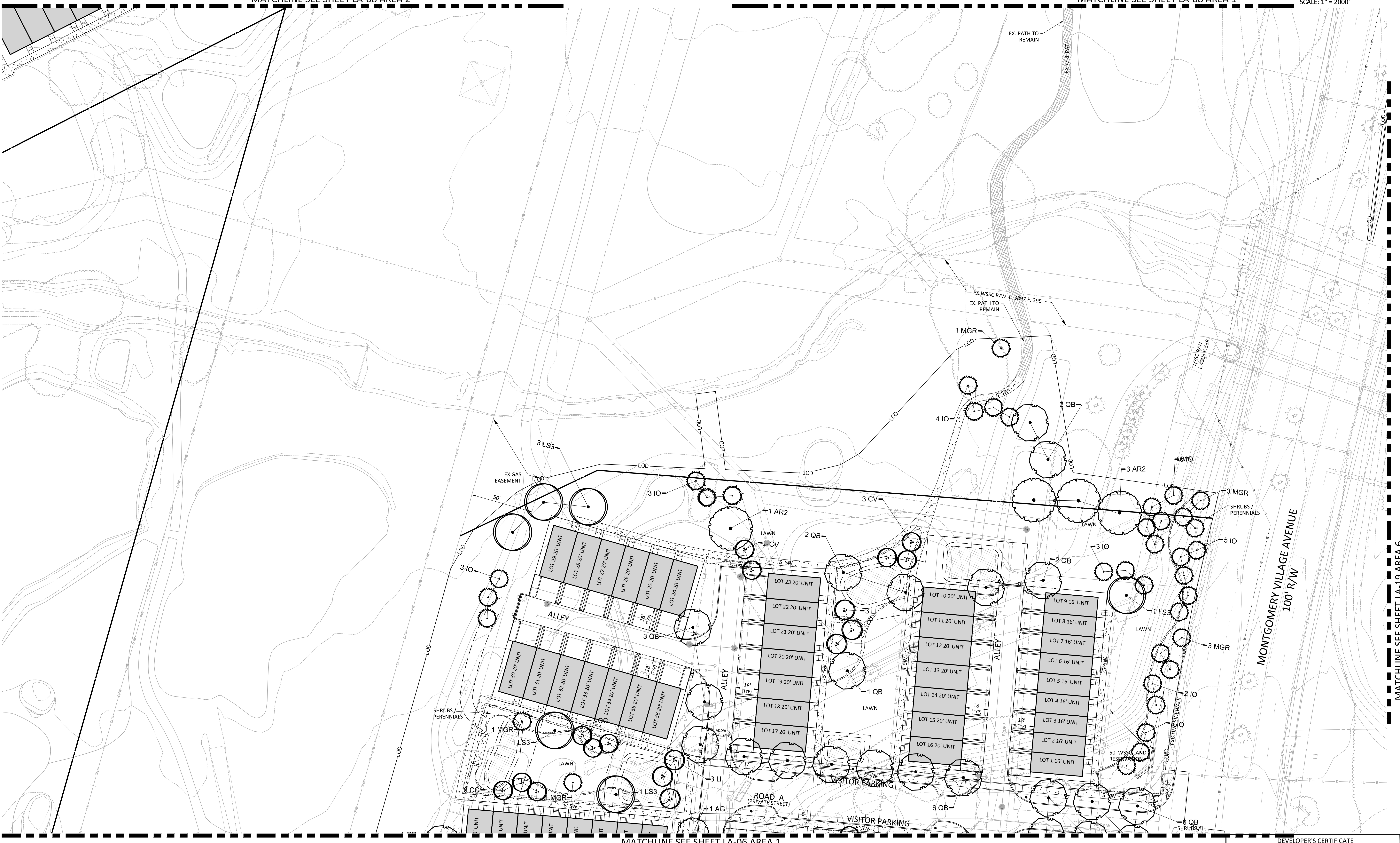

VKA
ENGINEERS PLANNERS
LANDSCAPE ARCHITECTS SURVEYORS
VKA MARYLAND, LLC
20251 CENTURY BOULEVARD SUITE 400
GERMANTOWN, MARYLAND 20874
PHONE: (301) 916-4100
FAX: (301) 916-2262
GERMANTOWN, MD. MCLEAN, VA.

PREPARED FOR:
USL2 MR
MONTGOMERY VILLAGE BUSINESS TRUST
c/o MONUMENT REALTY
750 17th STREET, NW, SUITE 1100
WASHINGTON, DC 20006
202.777.2010
RUSSELL HINES

DESIGN CONSULTANTS
ARCHITECTS
TORTI GALLAS AND PARTNERS, INC
1300 SPRING STREET, SUITE 400
SILVER SPRING, MD 20910
301.588.4800
ERIK J. AULESTIA

ATTORNEY
LERCH, EARLY & BREWER
CHTD.
3 BETHESDA METRO CENTER
SUITE 460
BETHESDA, MD 20814
301.841.3832
PATRICIA HARRIS

TRAFFIC ENGINEER
WELLS + ASSOCIATES
8730 GEORGIA AVENUE, SUITE 200
SILVER SPRING, MD 20910
301.448.1333
KEVIN BERGER

LANDSCAPE ARCHITECT
VKA MARYLAND, LLC
20251 CENTURY BOULEVARD
SUITE 400
GERMANTOWN MD, 20874
301.916.4100
JOSH SLOAN

CIVIL ENGINEER
VKA MARYLAND, LLC
20251 CENTURY BOULEVARD
SUITE 400
GERMANTOWN MD, 20874
301.916.4100
MIKE GOODMAN

REVISIONS
DRC COMMENTS 08/09/17
REVIEWERS 08/31/17
COMMENTS

PROFESSIONAL SEAL
STATE OF MARYLAND
LANDSCAPE ARCHITECT
No. 3775
EXPIRATION DATE: 12/31/2018

BLOOM MV AREA I-VI
9TH ELECTION DISTRICT
MONTGOMERY COUNTY, MARYLAND
WSSC GRID: 227NW09
TAX MAP: FU342
SP# 820170130

AREA 1 DETAILED LANDSCAPE PLAN
DRAWN BY: PJS
DESIGNED BY: DLK - JS - SCM
DATE ISSUED: May 5, 2017
VKA PROJECT: VM1920
DRAWING NO.: XXX
SHEET NO.: LA-07

NOTE: SCHEMATIC DESIGN FOR ENTITLEMENT ONLY. NOT FOR CONSTRUCTION OR BIDDING PURPOSES.

DEVELOPER'S CERTIFICATE
The undersigned agrees to execute all the features of the Site Plan Approval No. 820170130, including Approval Conditions, Development Program, and Certified Site Plan.
Developer's Name: USL2 MR Montgomery Village Business Trust
Contact Person: Russell Hines
Address: 2200 K Street, NW, Suite 600, Washington, DC 20006
Phone: 202.777.2010
Signature: _____ Date: _____

