

VICINITY MAP
SCALE: 1" = 2000'

VKA
ENGINEERS PLANNERS
LANDSCAPE ARCHITECTS SURVEYORS
VKA MARYLAND, LLC
20251 CENTURY BOULEVARD, SUITE 400
GERMANTOWN, MARYLAND 20874
PHONE: (301) 916-4100
FAX: (301) 916-2262
GERMANTOWN, MD. MCLEAN, VA.

PREPARED FOR:
**USL2 MR
MONTGOMERY VILLAGE
BUSINESS TRUST**
c/o MONUMENT REALTY
750 17th STREET, NW, SUITE 1100
WASHINGTON, DC 20006
202.777.2010
RUSSELL HINES

DESIGN CONSULTANTS
**ARCHITECTS
TORTI GALLAS AND
PARTNERS, INC**
1300 SPRING STREET, SUITE 400
SILVER SPRING, MD 20910
301.588.4800
ERIK J. AULESTIA

ATTORNEY
**LERCH, EARLY & BREWER
CHTD.**
3 BETHESDA METRO CENTER
SUITE 460
BETHESDA, MD 20814
301.841.3832
PATRICIA HARRIS

TRAFFIC ENGINEER
WELLS + ASSOCIATES
8730 GEORGIA AVENUE, SUITE 200
SILVER SPRING, MD 20910
301.448.1333
KEVIN BERGER

LANDSCAPE ARCHITECT
VKA MARYLAND, LLC
20251 CENTURY BOULEVARD
SUITE 400
GERMANTOWN MD, 20874
301.916.4100
JOSH SLOAN

CIVIL ENGINEER
VKA MARYLAND, LLC
20251 CENTURY BOULEVARD
SUITE 400
GERMANTOWN MD, 20874
301.916.4100
MIKE GOODMAN

REVISIONS	DATE
DRC COMMENTS	08/09/17
REVIEWERS	08/31/17
COMMENTS	

PROFESSIONAL SEAL

I HEREBY CERTIFY THAT THESE DOCUMENTS WERE
PREPARED OR APPROVED BY ME, AND THAT I AM A DULY
LICENSED, REGISTERED LANDSCAPE ARCHITECT UNDER
THE LAWS OF THE STATE OF MARYLAND.
NAME: JOSHUA SLOAN, P.L.A. No. 3775
LICENSE NUMBER: 3775
EXPIRATION DATE: 12/31/2018

**BLOOM MV
AREA I-VI**
9TH ELECTION DISTRICT
MONTGOMERY COUNTY,
MARYLAND
WSSC GRID: 227NW09
TAX MAP: FU342
SP# 820170130

**AREA 5
COMPOSITE
LANDSCAPE
PLAN**

DRAWN BY: PJS
DESIGNED BY: DLK - JS - SCM
DATE ISSUED: May 5, 2017
VKA PROJECT VM1920
DRAWING NO. -
SHEET NO. LA-19

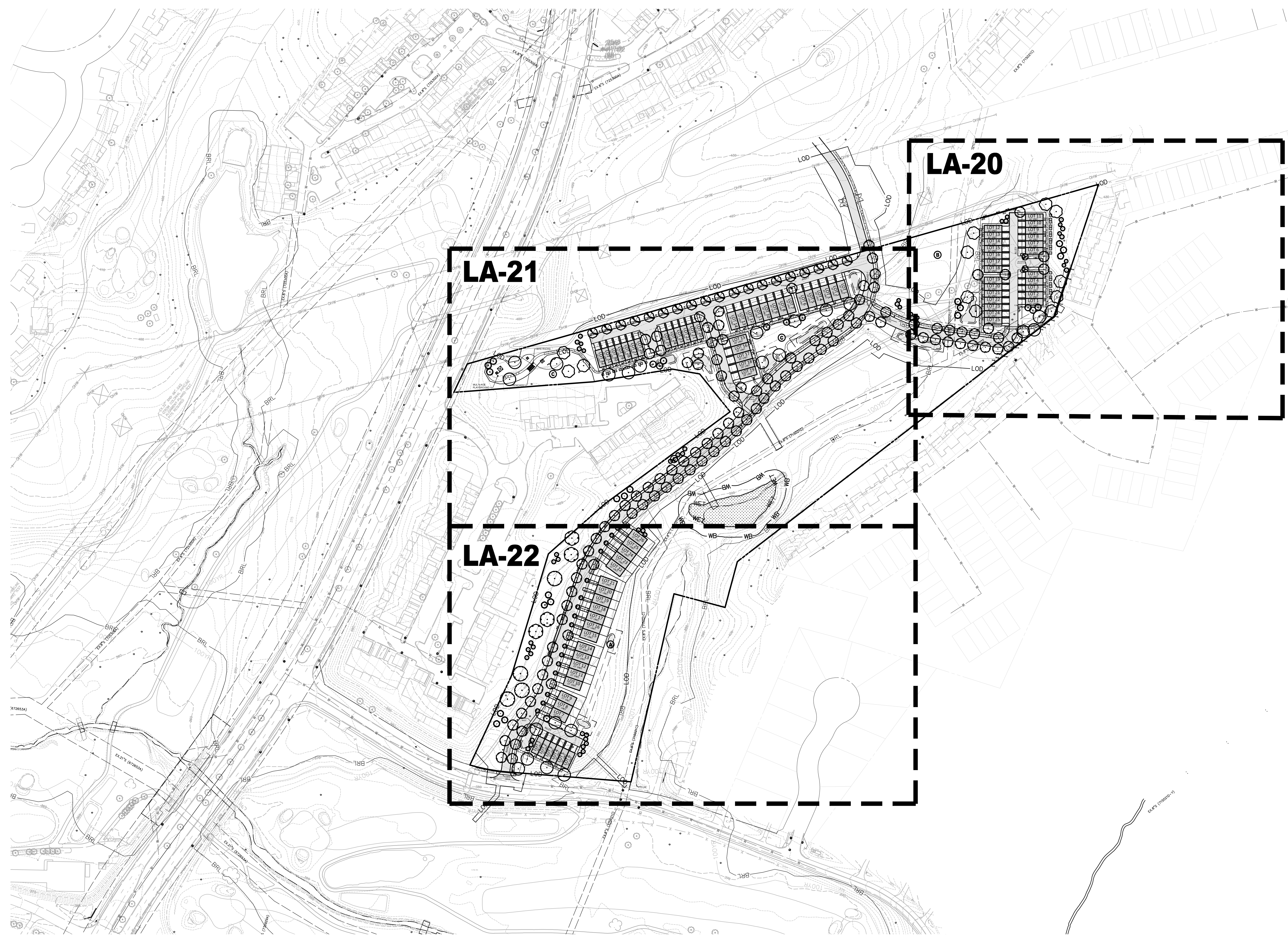

PLANT SCHEDULE

TREES	BOTANICAL NAME / COMMON NAME	CONT	CAL	QTY
AG	Acer griseum / Paperbark Maple	15 gal		10
AR2	Acer rubrum 'October Glory' / Red Maple	15 gal		5
AS	Amelanchier alnifolia / Serviceberry	15 gal		3
BN2	Betula nigra 'Heritage' / Heritage River Birch	-	2.5'Cal	21
CB	Carpinus betulus 'Fastigiata' / Pyramidal European Hornbeam	15 gal	2.5'Cal	15
CC2	Carpinus caroliniana / American Hornbeam	15 gal		2
CC	Cercis canadensis 'Forest Pansy' TM / Forest Pansy Redbud	15 gal		6
CV	Chionanthus virginicus / White Fringetree	15 gal		4
IO	Ilex opaca / American Holly	15 gal		6
IX2	Ilex x attenuata 'Fosteri' / Foster's Holly	15 gal		49
MGR	Magnolia grandiflora / Southern Magnolia	15 gal		9
PB	Platanus x acerifolia 'Bloodgood' / London Plane Tree	-	2.5'Cal	4
QC	Quercus coccinea / Scarlet Oak	-	2.5'Cal	13
TD	Taxodium distichum / Bald Cypress	15 gal		19
TS	Tilia americana 'Sentry' / American Linden	-	2.5'Cal	101

PLANT LEGEND

- SHADE TREES
- ORNAMENTAL TREES
- EVERGREEN TREES
- SHRUBS / ORNAMENTAL GRASSES

NOTE: LANDSCAPING WITHIN STORMWATER FACILITIES IS ILLUSTRATIVE ONLY AND MAY BE CHANGED AT THE TIME OF DETAILED PLAN REVIEW OF THE SEDIMENT CONTROL/STORMWATER MANAGEMENT PLANS BY THE MONTGOMERY COUNTY DPS, WATER RESOURCES SECTION.

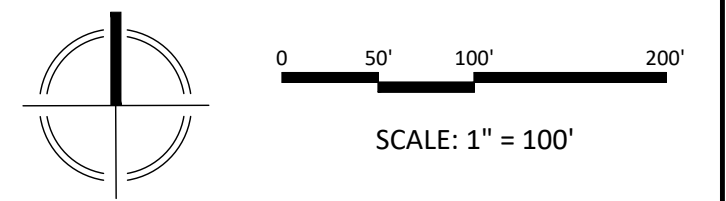

DEVELOPER'S CERTIFICATE
The undersigned agrees to execute all the features of the Site Plan Approval No. 820170130, including Approval Conditions, Development Program, and Certified Site Plan.
Developer's Name: USL2 MR Montgomery Village Business Trust
Contact Person: Russell Hines
Address: 2200 K Street, NW, Suite 600, Washington, DC 20006
Phone: 202.777.2010
Signature: _____ Date: _____