

**LEGEND**

- SUBJECT PROPERTY
- ADJACENT PROPERTY/LOT LINES
- PARKLAND CONVEYANCE BOUNDARY
- LIMITS OF DISTURBANCE
- 100 YEAR FLOODPLAIN
- 100 YEAR FLOODPLAIN 2' BRL
- STREAM VALLEY BUFFER
- WETLAND BUFFER
- WETLAND
- WATERS OF THE US
- PROPOSED CATEGORY I FOREST CONSERVATION EASEMENT
- SOILS
- EX. FORESTED UTILITY EASEMENT DEDUCTED FROM FROM FOREST TOTAL & FC TRACT AREA
- PROPOSED PEDESTRIAN LIGHT
- ROOT PRUNING TRENCH AT CONSTRUCTION TREE PROTECTION FENCE W/ SIGNAGE AT LOD, SHOWN OFF-SET FOR CLARITY
- SLOPE ≥ 25%
- SLOPE 15-25% ON HIGHLY ERODIBLE SOILS
- WETLAND
- EXISTING FOREST
- PROPOSED AFFORESTATION/ REFORESTATION
- PROPOSED BIODIVERSITY
- EXISTING TREE CANOPY (NOT FOREST)
- PATHS ON PARK CONVEYANCE TO BE REMOVED

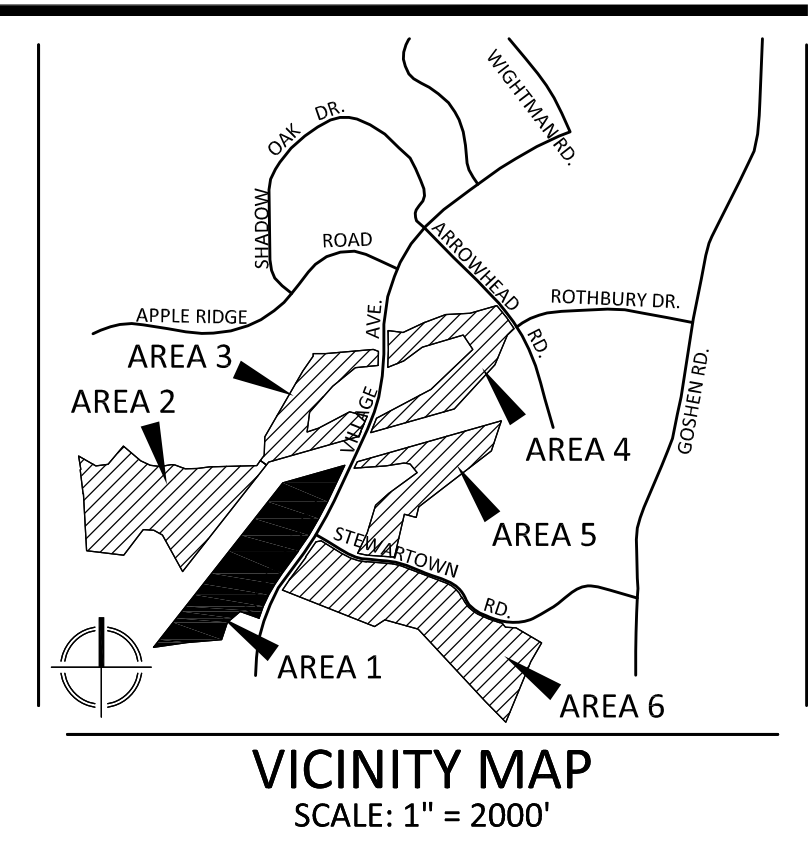

**VKA**  
ENGINEERS PLANNERS  
LANDSCAPE ARCHITECTS SURVEYORS  
VKA MARYLAND, LLC  
20251 CENTURY BOULEVARD SUITE 400  
GERMANTOWN, MARYLAND 20874  
PHONE: (301) 916-4100  
FAX: (301) 916-2262  
GERMANTOWN, MD. MCLEAN, VA.

PREPARED FOR:  
**USL2 MR MONTGOMERY VILLAGE BUSINESS TRUST**  
c/o MONUMENT REALTY  
1700 K STREET, NW, SUITE 600  
WASHINGTON, DC 20006  
202.777.2010  
RUSSELL HINES

DESIGN CONSULTANTS

ARCHITECTS  
**TORTI GALLAS AND PARTNERS, INC**  
1300 SPRING STREET, SUITE 400  
SILVER SPRING, MD 20910  
301.588.4800  
ERIK J. AULESTIA

ATTORNEY  
**LERCH, EARLY & BREWER CHTD.**  
3 BETHESDA METRO CENTER  
SUITE 460  
BETHESDA, MD 20814  
301.841.3832  
PATRICIA HARRIS

TRAFFIC ENGINEER  
**WELLS + ASSOCIATES**  
8730 GEORGIA AVENUE, SUITE 200  
SILVER SPRING, MD 20910  
301.448.1333  
KEVIN BERGER

LANDSCAPE ARCHITECT  
**VKA MARYLAND, LLC**  
20251 CENTURY BOULEVARD  
SUITE 400  
GERMANTOWN MD, 20874  
301.916.4100  
JOSH SLOAN

CIVIL ENGINEER  
**VKA MARYLAND, LLC**  
20251 CENTURY BOULEVARD  
SUITE 400  
GERMANTOWN MD, 20874  
301.916.4100  
MIKE GOODMAN

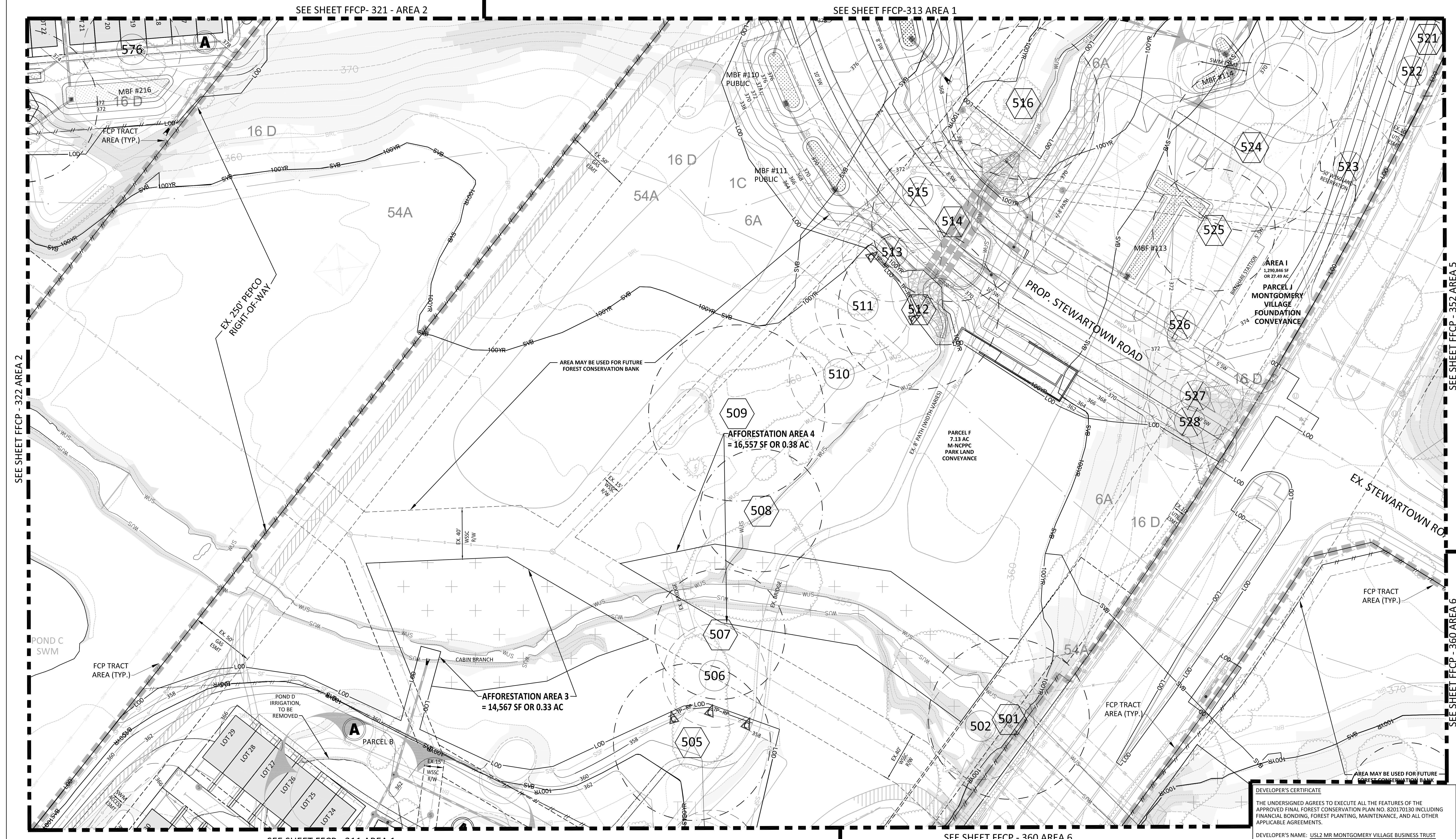

SEE SHEET FFCP - 322 AREA 2

SEE SHEET FFCP-313 AREA 1

SEE SHEET FFCP - 321 - AREA 2

SEE SHEET FFCP - 311 AREA 1

SEE SHEET FFCP - 360 AREA 6

SEE SHEET FFCP - 352 AREA 5

SEE SHEET FFCP - 360 AREA 6

REVISIONS	DATE
1ST SUBMISSION	05/05/17
DRC COMMENTS	08/09/17
REVIEWER COMMENTS	08/31/17

PROFESSIONAL SEAL

HEREBY CERTIFY THAT THESE DOCUMENTS WERE PREPARED OR APPROVED BY ME, AND THAT I AM A DULY LICENSED REGISTERED PROFESSIONAL ARCHITECT UNDER THE STATE OF MARYLAND.  
NAME: JOSHUA SLOAN, RLA, AIA  
LICENSE NUMBER: 3775  
EXPIRATION DATE: MAY 13, 2018

**BLOOM MV AREA I-VI**  
9TH ELECTION DISTRICT  
MONTGOMERY COUNTY, MARYLAND  
WSSC GRID: 227NW09  
TAX MAP: FU342  
**820170130**

**FINAL FOREST CONSERVATION PLAN**  
**AREA 1 DETAILED FCP**

DRAWN BY: NRP  
DESIGNED BY: JCS  
DATE ISSUED: AUGUST, 2017  
VKA PROJECT: VM1920  
DRAWING NO.:  
SHEET NO.: FFCP 312

FOR LOCATION OF UTILITIES CALL 8-1-1 or 1-800-257-7777 OR LOG ON TO www.call811.com or http://www.misutility.net 48 HOURS IN ADVANCE OF ANY WORK IN THIS VICINITY

The excavator must notify all public utility companies with underground facilities in the area of proposed excavation and have those facilities located by the utility companies prior to commencing excavation. The excavator is responsible for compliance with requirements of Chapter 55a of the Montgomery County Code.

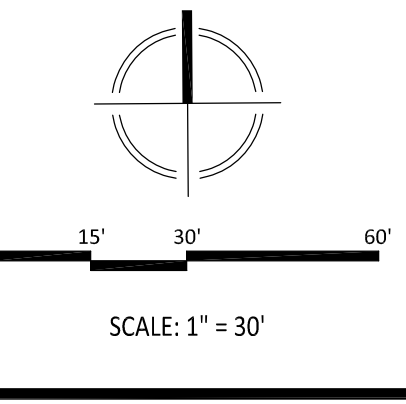

SCALE: 1" = 30'