

LEGEND

	SUBJECT PROPERTY		SLOPE 2-25%		EXISTING SIGNIFICANT TREE 24-29.9\" DBH W/CRZ SHOWN		EXISTING SIGNIFICANT TREE 30\" OR GREATER DBH W/CRZ SHOWN		EXISTING SPECIMEN TREE 24-29.9\" DBH W/CRZ SHOWN
	ADJACENT PROPERTY LOT LINES		SLOPE 15-25% ON HIGHLY ERODIBLE SOILS		EXISTING SPECIMEN TREE 30\" OR GREATER DBH W/CRZ SHOWN		EXISTING SPECIMEN TREE 30\" OR GREATER DBH W/CRZ SHOWN		EXISTING SPECIMEN TREE 30\" OR GREATER DBH W/CRZ SHOWN
	PARKLAND CONVEYANCE BOUNDARY		WETLAND		EXISTING FOREST		PROPOSED AFFORESTATION/ REFORESTATION		PROPOSED BIORETENTION
	LIMITS OF DISTURBANCE		PROPOSED AFFORESTATION/ REFORESTATION		PROPOSED BIORETENTION		EXISTING TREE CANOPY (NOT FOREST)		PROPOSED SEC EARTH DIKE
	100 YR FLOODPLAIN		PROPOSED SEC EARTH DIKE		PROPOSED SEC SEDIMENT TRAP AREA		PROPOSED STABILIZED CONSTRUCTION ENTRANCE		PROPOSED SEC SILT FENCE
	STREAM VALLEY BUFFER		PROPOSED SEC SEDIMENT TRAP AREA		PROPOSED STABILIZED CONSTRUCTION ENTRANCE		PROPOSED SEC SILT FENCE		PROPOSED SEC AT GRADE & CURB INLET PROTECTION OVER EXISTING INLET
	WETLAND BUFFER		PROPOSED STABILIZED CONSTRUCTION ENTRANCE		PROPOSED SEC SILT FENCE		PROPOSED SEC AT GRADE & CURB INLET PROTECTION OVER EXISTING INLET		PROPOSED SEC STABILIZED CONSTRUCTION ENTRANCE
	WATERS OF THE US		PROPOSED SEC STABILIZED CONSTRUCTION ENTRANCE		PROPOSED SEC AT GRADE & CURB INLET PROTECTION OVER EXISTING INLET		PROPOSED SEC STABILIZED CONSTRUCTION ENTRANCE		PROPOSED SEC AT GRADE & CURB INLET PROTECTION OVER EXISTING INLET
	PROPOSED CATEGORY 1 FOREST CONSERVATION EASEMENT		PROPOSED SEC AT GRADE & CURB INLET PROTECTION OVER EXISTING INLET		PROPOSED SEC STABILIZED CONSTRUCTION ENTRANCE		PROPOSED SEC AT GRADE & CURB INLET PROTECTION OVER EXISTING INLET		PROPOSED SEC STABILIZED CONSTRUCTION ENTRANCE
	EX. FORESTED UTILITY EASEMENT DEDICATED FROM FROM FOREST TOTAL & FC TRACT AREA		PROPOSED SEC STABILIZED CONSTRUCTION ENTRANCE		PROPOSED SEC AT GRADE & CURB INLET PROTECTION OVER EXISTING INLET		PROPOSED SEC STABILIZED CONSTRUCTION ENTRANCE		PROPOSED SEC AT GRADE & CURB INLET PROTECTION OVER EXISTING INLET
	PROPOSED PEDESTRIAN LIGHT		PROPOSED SEC AT GRADE & CURB INLET PROTECTION OVER EXISTING INLET		PROPOSED SEC STABILIZED CONSTRUCTION ENTRANCE		PROPOSED SEC AT GRADE & CURB INLET PROTECTION OVER EXISTING INLET		PROPOSED SEC STABILIZED CONSTRUCTION ENTRANCE
	ROOT PRUNING TRENCH AT CONSTRUCTION TREE PROTECTION FENCE W/ SIGNAGE AT LOD, SHOWN OFF-SET FOR CLARITY		PROPOSED SEC STABILIZED CONSTRUCTION ENTRANCE		PROPOSED SEC AT GRADE & CURB INLET PROTECTION OVER EXISTING INLET		PROPOSED SEC STABILIZED CONSTRUCTION ENTRANCE		PROPOSED SEC AT GRADE & CURB INLET PROTECTION OVER EXISTING INLET

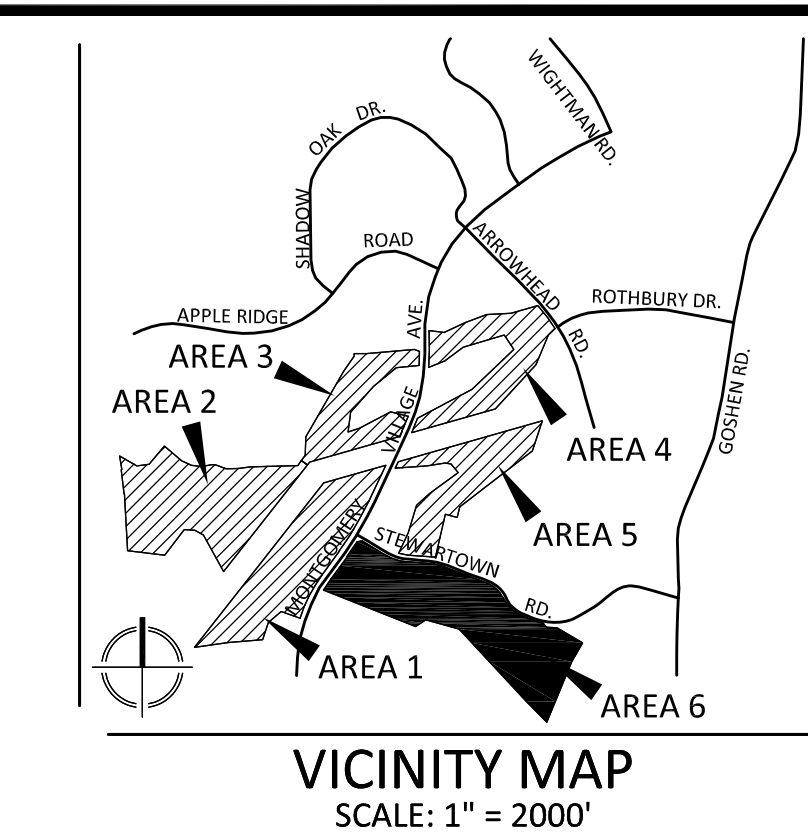

VKA
ENGINEERS PLANNERS
LANDSCAPE ARCHITECTS SURVEYORS
VKA MARYLAND, LLC
20251 CENTURY BOULEVARD SUITE 400
GERMANTOWN, MARYLAND 20874
PHONE: (301) 916-4100
FAX: (301) 916-2262
GERMANTOWN, MD. MCKEAN, VA.

PREPARED FOR:
USL2 MR MONTGOMERY VILLAGE BUSINESS TRUST
c/o MONUMENT REALTY
1700 K STREET, NW, SUITE 600
WASHINGTON, DC 20006
202.777.2010
RUSSELL HINES

DESIGN CONSULTANTS
ARCHITECTS
TORTI GALLAS AND PARTNERS, INC
1300 SPRING STREET, SUITE 400
SILVER SPRING, MD 20910
301.588.4800
ERIK J. AULESTIA

ATTORNEY
LERTCH, EARLY & BREWER
CHTD.
3 BETHESDA METRO CENTER
SUITE 460
BETHESDA, MD 20814
301.841.3832
PATRICIA HARRIS

TRAFFIC ENGINEER
WELLS + ASSOCIATES
8730 GEORGIA AVENUE, SUITE 200
SILVER SPRING, MD 20910
301.448.1333
KEVIN BERGER

LANDSCAPE ARCHITECT
VKA MARYLAND, LLC
20251 CENTURY BOULEVARD
SUITE 400
GERMANTOWN MD, 20874
301.916.4100
JOSH SLOAN

CIVIL ENGINEER
VKA MARYLAND, LLC
20251 CENTURY BOULEVARD
SUITE 400
GERMANTOWN MD, 20874
301.916.4100
MIKE GOODMAN

REVISIONS	DATE
1ST SUBMISSION	05/05/17
DRC COMMENTS	08/09/17
REVIEWER COMMENTS	08/31/17

PROFESSIONAL SEAL

STATE OF MARYLAND
JOSHUA SLOAN
LANDSCAPE ARCHITECT
NO. 3776

I HEREBY CERTIFY THAT THESE DOCUMENTS WERE PREPARED OR APPROVED BY ME, AND THAT I AM A DULY LICENSED REGISTERED LANDSCAPE ARCHITECT UNDER THE LAWS OF THE STATE OF MARYLAND.
NAME: JOSHUA SLOAN, RLA, AIA
LICENSE NUMBER: 3776
EXPIRATION DATE: MAY 13, 2018

BLOOM MV AREA I-VI
9TH ELECTION DISTRICT
MONTGOMERY COUNTY, MARYLAND
WSSC GRID: 227NW09
TAX MAP: FU342
820170130

FINAL FOREST CONSERVATION PLAN
AREA 6 DETAILED FCP

DRAWN BY: NRP
DESIGNED BY: JCS
DATE ISSUED: AUGUST, 2017
VKA PROJECT: VM1920
DRAWING NO.:
SHEET NO. FFCP 361

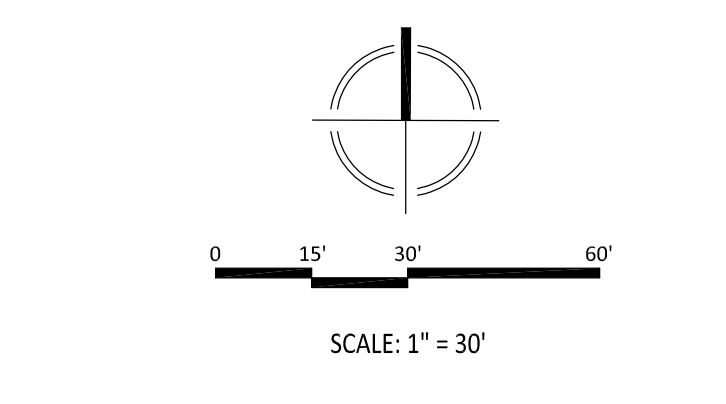
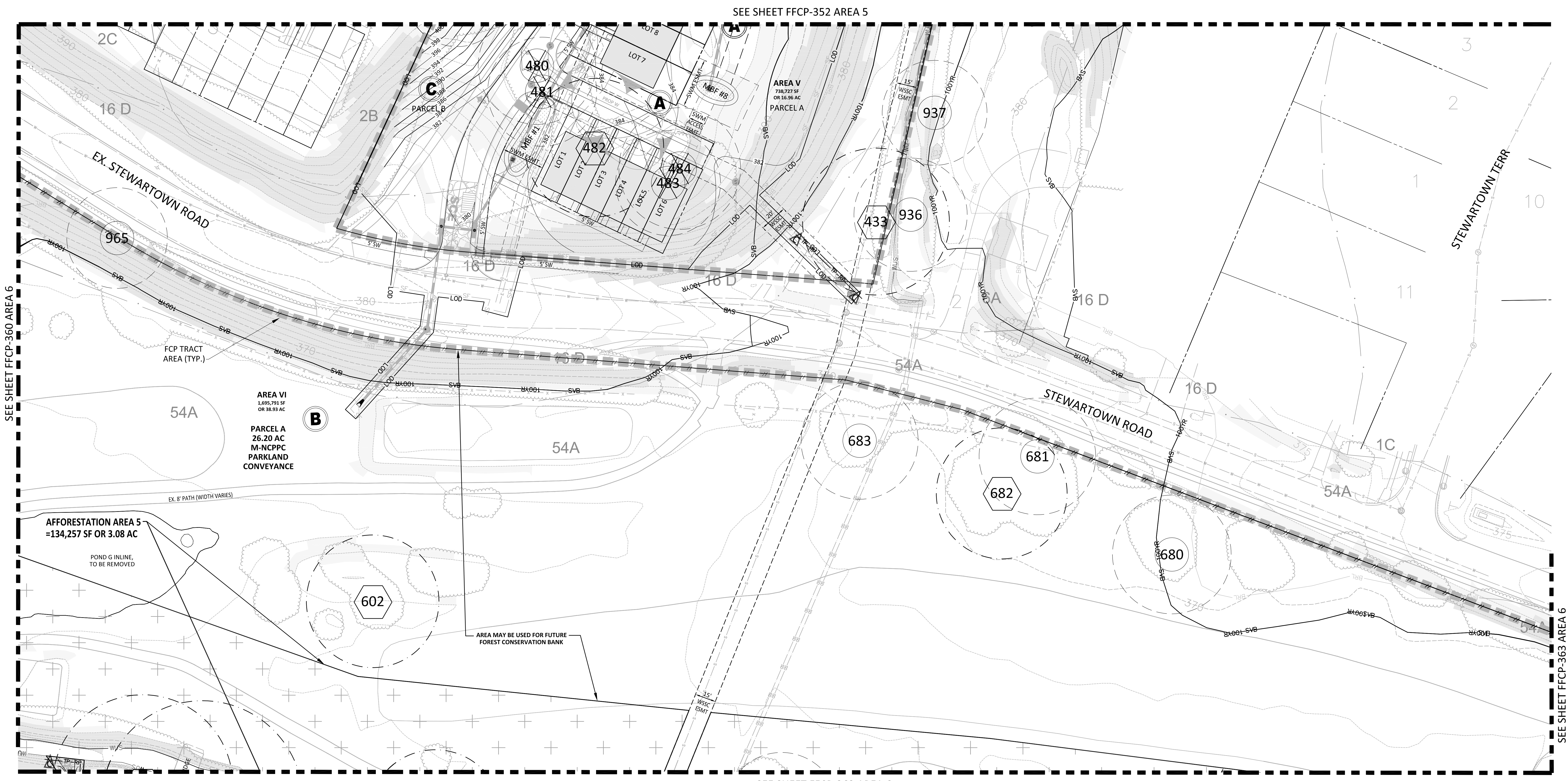
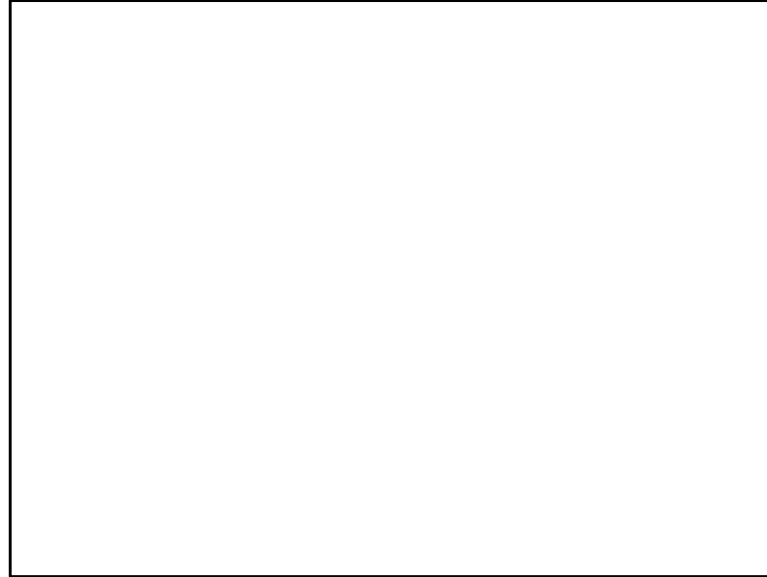

"FOR LOCATION OF UTILITIES CALL 8-1-1 or 1-800-257-7777 OR LOG ON TO www.call811.com or http://www.misutility.net 48 HOURS IN ADVANCE OF ANY WORK IN THIS VICINITY"

The excavator must notify all public utility companies with underground facilities in the area of proposed excavation and have those facilities located by the utility companies prior to commencing excavation. The excavator is responsible for compliance with requirements of Chapter 50A of the Montgomery County Code.

DEVELOPER'S CERTIFICATE
THE UNDERSIGNED AGREES TO EXECUTE ALL THE FEATURES OF THE APPROVED FINAL FOREST CONSERVATION PLAN NO. 820170130 INCLUDING FINANCIAL BONDING, FOREST MAINTENANCE, AND ALL OTHER APPLICABLE AGREEMENTS.

DEVELOPER'S NAME: USL2 MR MONTGOMERY VILLAGE BUSINESS TRUST
PRINTED COMPANY NAME

CONTACT PERSON OR OWNER: RUSSELL HINES
PRINTED NAME

ADDRESS: 1700 K STREET, NW, SUITE 600, WASHINGTON, DC 20006

PHONE & E-MAIL: 202.777.2010 rhines@monumentrealty.com

SIGNATURE: _____ DATE: _____