

WESTWOOD SHOPPING CENTER

7TH ELECTION DISTRICT
BETHESDA, MARYLAND

Applicant / Owner:
Equity One (Northeast Portfolio) LLC
c/o Regency Centers, L.P.

Regency Centers.

1919 Gallows Road, Suite 1000
Vienna, VA 22182
703-442-4302
Sam Siebel

THE NEIGHBORHOODS OF
EYA

Residential Developer:
The Neighborhoods of EYA
4800 Hampden Lane, Suite 300
Bethesda, MD 20814
301-634-8600
Jack Lester

LINOWES AND BLOCHER LLP
ATTORNEYS AT LAW

Attorney:
Linowes and Blocher LLP
7200 Wisconsin Avenue, Suite 800
Bethesda, MD 20814
301-654-0504
Erin Girard

J.B.A.
Johnson • Bernat • Associates, Inc.

Civil Engineer:
Johnson Bernat Associates, Inc.
205 N. Frederick Avenue, Suite 100
Gaithersburg, MD 20877
301-963-1133
Kevin Johnson

Architect:
Mushinsky Voelzke Associates | MV+A
1200 G Street, NW Suite 250
Washington, DC 20005
202-682-2822
Jim Voelzke

LandDesign.

Landscape Architect:
LandDesign
200 South Peyton Street
Alexandria, VA 22314
703.594.7784
Gabriela Conamur

WA

Traffic Consultant:
Wells + Associates
8730 Georgia Avenue, Suite 200
Silver Spring, MD 20910
301-971-3415
Nancy Randall

SITE PLAN NO. 820180190

LOT 1, BLOCK A FLOOR PLANS

MAY 1, 2018

DRAWN BY: **BJS** CHECKED BY: **JV**

REV.	ISSUE	DATE
1	SUBMISSION 1	04.20.2018

DRAWING STAMP

SHEET NUMBER

A102

GENERAL NOTES:

1. FINAL BUILDING LOCATIONS, DIMENSIONS, HEIGHT, AND UNIT TYPE DESIGNATIONS TO BE DETERMINED AT TIME OF CERTIFIED SITE PLAN.
2. THE PROPOSED ARCHITECTURAL DETAILS AND MATERIALS ARE CONCEPTUAL AND SUBJECT TO REVISION AT THE TIME OF CERTIFIED SITE PLAN.
3. INTERIOR PARTITIONS, INCLUDING THOSE BETWEEN DIFFERENT USES, AS WELL AS THE NUMBER, SIZE AND LOCATION OF STAIRS AND ELEVATORS ARE PRELIMINARY AND SHOWN FOR ILLUSTRATIVE PURPOSES ONLY. PARKING SPACE LAYOUT AND STRUCTURE IS SHOWN FOR ILLUSTRATIVE PURPOSES ONLY. FINAL LAYOUT MAY VARY.
4. RETAIL AND EGRESS DOORS ARE SHOWN FOR ILLUSTRATIVE PURPOSES ONLY. FINAL LOCATIONS AND QUANTITY MAY VARY. RETAIL STOREFRONTS ARE SHOWN FOR ILLUSTRATIVE PURPOSES AND SUBJECT TO CHANGE. FINAL STOREFRONT TO BE PROVIDED BY RETAIL TENANTS.
5. ROOFTOP MECHANICAL STRUCTURES ARE NOT INCLUDED IN GFA. FINAL LAYOUT OF ROOFTOP MECHANICAL STRUCTURES MAY VARY.
6. GREEN ROOF LOCATIONS SUBJECT TO CHANGE. THESE AREAS WILL BE RAISED ABOVE MAIN ROOF PLANE

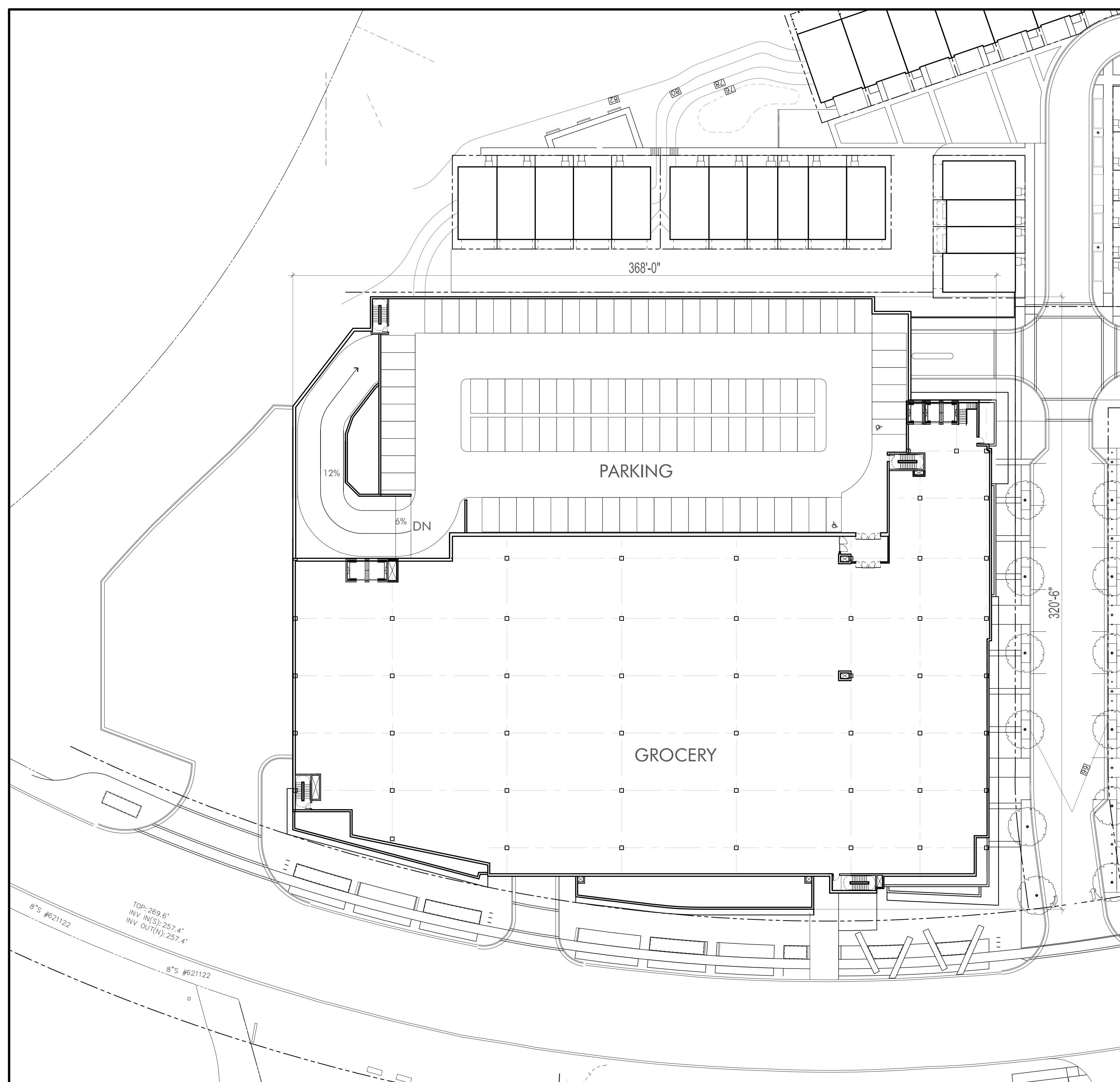
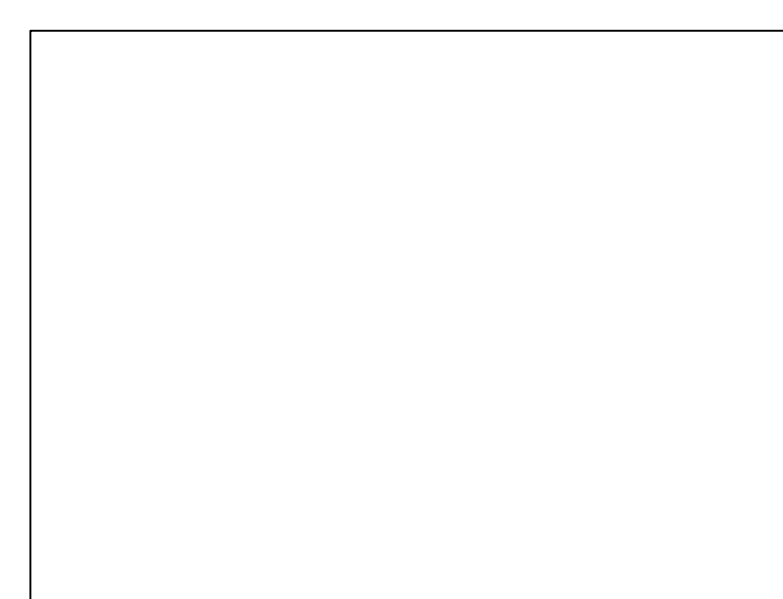

1 LEVEL 3 FLOOR PLAN

SCALE 1/30" = 1'-0"

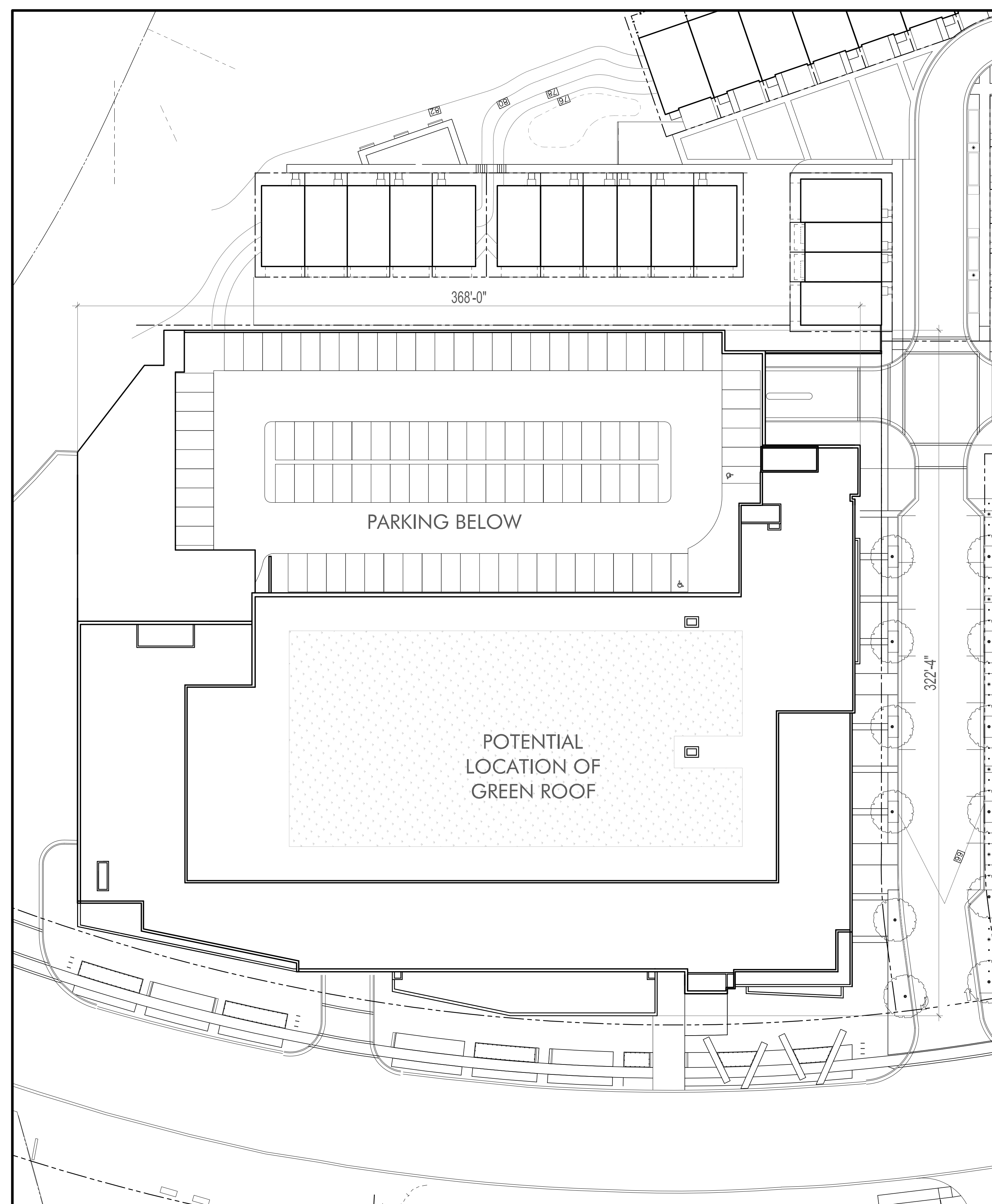

2 ROOF PLAN

SCALE 1/30" = 1'-0"

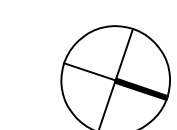

DEVELOPER'S CERTIFICATE

The Undersigned agrees to execute all the features of the Site Plan Approval No. 820180190 including Approval Conditions, Development Program, and Certified Site Plan.

Applicant's Name: **Equity One LLC c/o Regency Centers - Sam Siebel**
Company: _____ Contact Person: _____

Address: 1919 Gallows Road S. 1000
Vienna, VA 22182

Phone: 703-442-4302

Signature: _____