

# WESTWOOD SHOPPING CENTER

7TH ELECTION DISTRICT  
BETHESDA, MARYLAND

Applicant / Owner:  
Equity One (Northeast Portfolio) LLC  
c/o Regency Centers, L.P.



1919 Gallows Road, Suite 1000  
Vienna, VA 22182  
703-442-4302  
Sam Stiebel



Residential Developer:  
The Neighborhoods of EYA  
4800 Hampden Lane, Suite 300  
Bethesda, MD 20814  
301-634-8600  
Jack Lester

## LINOWES AND BLOCHER LLP

Attorney:  
Linows and Blocher LLP  
7200 Wisconsin Avenue, Suite 800  
Bethesda, MD 20814  
301-654-0504  
Erin Girard



Johnson + Bernat + Associates, Inc.

Civil Engineer:  
Johnson Bernat Associates, Inc.  
205 N. Frederick Avenue, Suite 100  
Gaithersburg, MD 20877  
301-963-1133  
Kevin Johnson



Architect:  
Mushinsky Voelzke Associates | MV+A  
1200 G Street, NW Suite 250  
Washington, DC 20005  
202-682-2822  
Jim Voelzke



Landscape Architect:  
LandDesign  
200 South Peyton Street  
Alexandria, VA 22314  
703.594.7784  
Gabriela Conamar



Traffic Consultant:  
Wells + Associates  
8730 Georgia Avenue, Suite 200  
Silver Spring, MD 20910  
301-971-3415  
Nancy Randall

SITE PLAN NO. 820180190

## LOT 2, 3 BLOCK A FLOOR PLANS

JANUARY 14, 2019

DRAWN BY: BJS CHECKED BY: JV

REV.	ISSUE	DATE
1	SUBMISSION 1	01.14.2019

DRAWING STAMP

SHEET NUMBER

A203

### GENERAL NOTES:

1. FINAL BUILDING LOCATIONS, DIMENSIONS, HEIGHT, AND UNIT TYPE DESIGNATIONS TO BE DETERMINED AT TIME OF CERTIFIED SITE PLAN.
2. THE PROPOSED ARCHITECTURAL DETAILS AND MATERIALS ARE CONCEPTUAL AND SUBJECT TO REVISION AT THE TIME OF CERTIFIED SITE PLAN.
3. INTERIOR PARTITIONS, INCLUDING THOSE BETWEEN DIFFERENT USES, AS WELL AS THE NUMBER, SIZE AND LOCATION OF STAIRS AND ELEVATORS ARE PRELIMINARY AND SHOWN FOR ILLUSTRATIVE PURPOSES ONLY. STRUCTURE SHOWN IS FOR ILLUSTRATIVE PURPOSES ONLY. MINOR CHANGES TO THE PARKING SPACE LAYOUT SHOWN MAY OCCUR AT TIME OF PERMITTING.
4. RETAIL AND EGRESS DOORS ARE SHOWN FOR ILLUSTRATIVE PURPOSES ONLY. FINAL LOCATIONS AND QUANTITY MAY VARY. RETAIL STOREFRONTS ARE SHOWN FOR ILLUSTRATIVE PURPOSES AND SUBJECT TO CHANGE. FINAL STOREFRONT TO BE PROVIDED BY RETAIL TENANTS.
5. ROOFTOP MECHANICAL STRUCTURES ARE NOT INCLUDED IN GFA. FINAL LAYOUT OF ROOFTOP MECHANICAL STRUCTURES MAY VARY.
6. GREEN ROOF LOCATIONS SUBJECT TO CHANGE. THESE AREAS WILL BE RAISED ABOVE MAIN ROOF PLANE

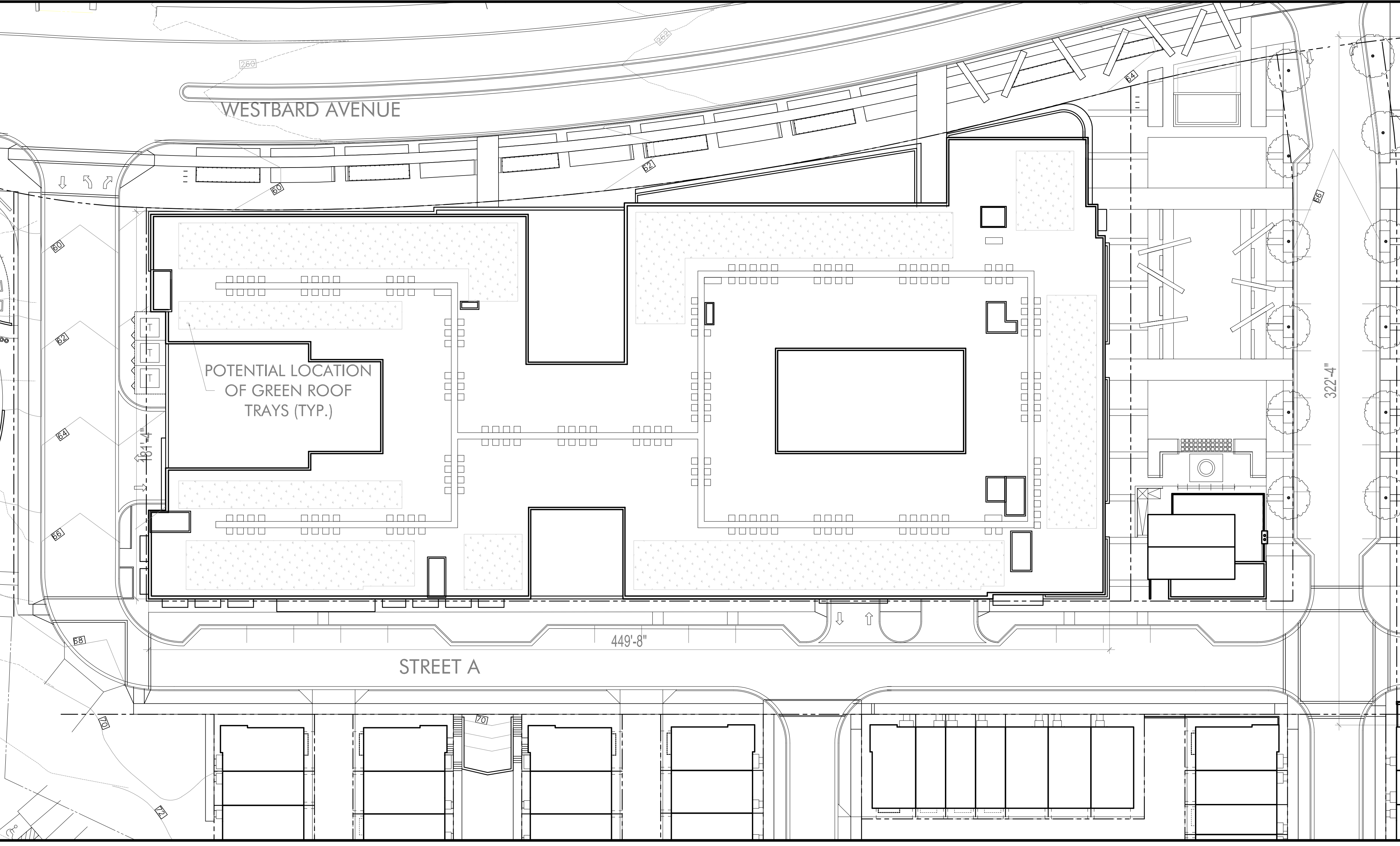

**1 ROOF PLAN**  
SCALE 1/30" = 1'-0"

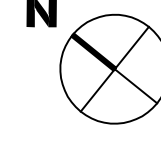

### DEVELOPER'S CERTIFICATE

The Undersigned agrees to associate all the features of the Site Plan Approval No. 820180190 including Approval Conditions, Development Program, and Certified Site Plan.

Applicant's Name: Equity One LLC c/o Regency Centers - Sam Stiebel  
Company Contact Person

Address: 1919 Gallows Road S. 1000  
Vienna, VA 22182

Phone: 703-442-4302

Signature: \_\_\_\_\_

1/11/2019 4:41 PM

S:\2010-2019\160001\6075 - WESTWOOD\02\_DESIGN\04\_CAD\16075 WESTWOOD CURRENT2.DWG