

WESTWOOD SHOPPING CENTER
7TH ELECTION DISTRICT
BETHESDA, MARYLAND

Applicant / Owner:
Equity One (Northeast Portfolio) LLC
c/o Regency Centers, L.P.



1919 Gallows Road, Suite 1000
Vienna, VA 22182
703-442-4302
Sam Stibel



Residential Developer:
The Neighborhoods of EYA
4800 Hampden Lane, Suite 300
Bethesda, MD 20814
301-634-8600
Jack Lester



Attorney:
Linowes and Blocher LLP
7200 Wisconsin Avenue, Suite 800
Bethesda, MD 20814
301-654-0504
Erin Girard



Civil Engineer:
Johnson Bernat Associates, Inc.
205 N. Frederick Avenue, Suite 100
Gaithersburg, MD 20877
301-963-1133
Kevin Johnson



Architect:
Mushinsky Voelzke Associates | MV+A
1200 G Street, NW Suite 250
Washington, DC 20005
202-682-2822
Jim Voelzke



Landscape Architect:
LandDesign
200 South Peyton Street
Alexandria, VA 22314
703.594.7784
Gabriela Canamar



Traffic Consultant:
Wells + Associates
8730 Georgia Avenue, Suite 200
Silver Spring, MD 20910
301-971-3415
Nancy Randall

SITE PLAN NO. 820180190

TOWNHOMES BUILDING ELEVATIONS #4

MAY 1, 2018

DRAWN BY: jfmc
CHECKED BY: jfmc

REV.	ISSUE	DATE
SUBMISSION 1		04.20.2018
SUBMISSION 2		09.19.2018

DRAWING STAMP

SHEET NUMBER
A313

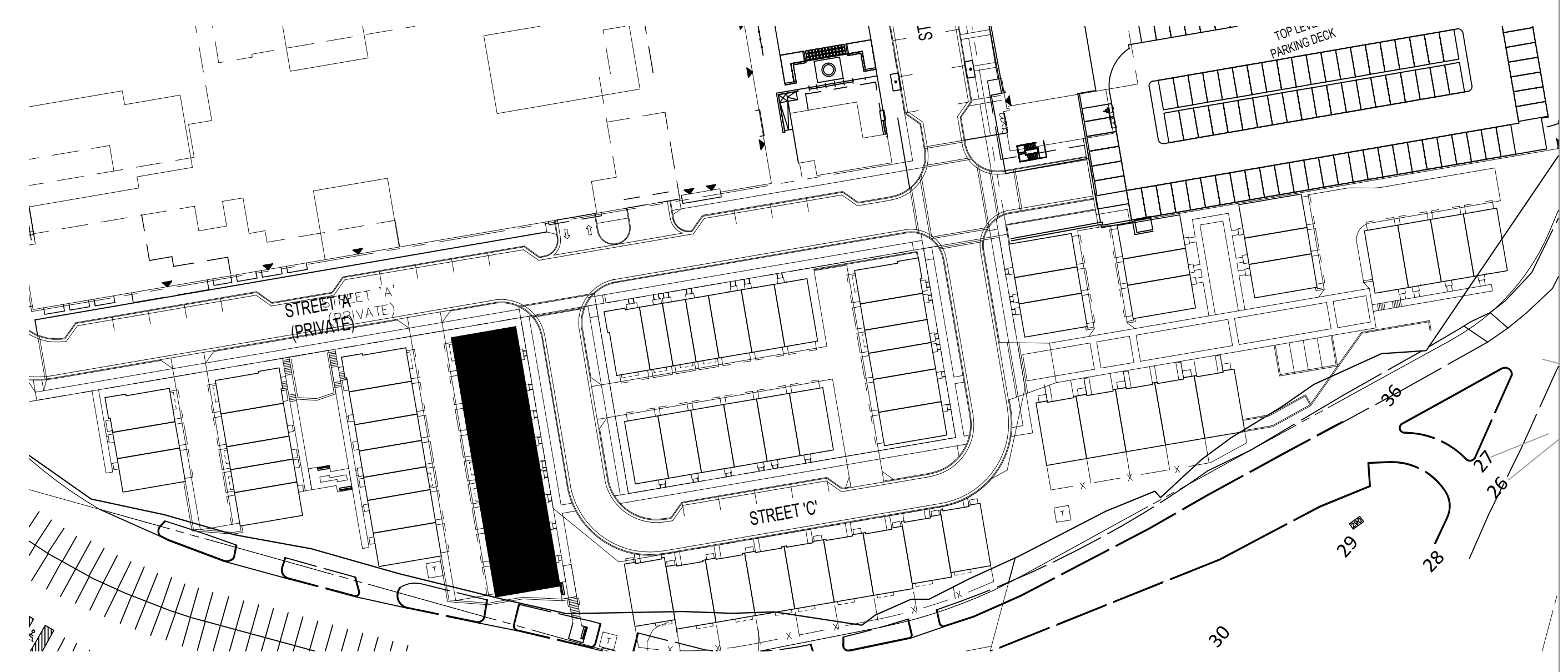

0 KEY PLAN
Scale: N.T.S.

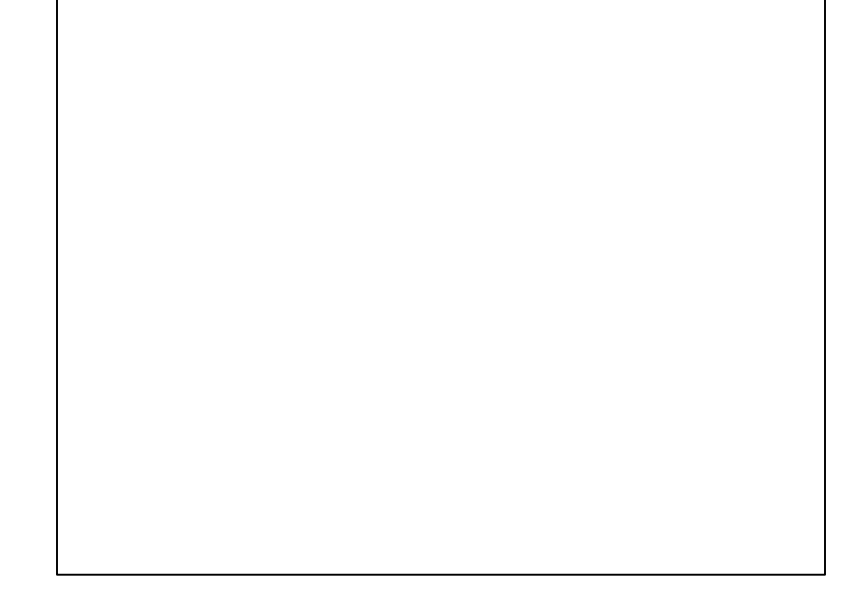

3 LEFT SIDE ELEVATION - BUILDING #4
Scale: 1/8"=1'-0"



1 FRONT ELEVATION - BUILDING #4
Scale: 1/8"=1'-0"



2 RIGHT SIDE ELEVATION - BUILDING #4
Scale: 1/8"=1'-0"



4 REAR ELEVATION - BUILDING #4
Scale: 1/8"=1'-0"

NOTE: FINAL BUILDING LOCATIONS, DIMENSIONS, HEIGHT, AND UNIT TYPE DESIGNATIONS TO BE DETERMINED AT TIME OF CERTIFIED SITE PLAN. THE PROPOSED ARCHITECTURAL DETAILS AND MATERIALS ARE CONCEPTUAL AND SUBJECT TO REVISION AT THE TIME OF CERTIFIED SITE PLAN.

DEVELOPER'S CERTIFICATE
The Undersigned agrees to execute all the features of the Site Plan Approval No. 820180190 including Approval Conditions, Development Program, and Certified Site Plan.
Applicant's Name: Equity One LLC c/o Regency Centers - Sam Stibel
Company Contact Person
Address: 1919 Gallows Road S. 1000
Vienna, VA 22182
Phone: 703-442-4302
Signature: _____

1/14/2019 11:50 AM
E:\DEPT\LAND\CONSTRUCTION\LANDSURVIV\WESTWOOD COMPLEX\SCHEMATIC\ELEVATIONS\DWG\WB-STRIP ELEVATIONS 190114.DWG
MUSHINSKY VOELZKE ASSOCIATES