

**WESTWOOD SHOPPING CENTER**  
7TH ELECTION DISTRICT  
BETHESDA, MARYLAND

Applicant / Owner:  
Equity One (Northeast Portfolio) LLC  
c/o Regency Centers, L.P.



1919 Gallows Road, Suite 1000  
Vienna, VA 22182  
703-442-4302  
Sam Stibel



Residential Developer:  
The Neighborhoods of EYA  
4800 Hampden Lane, Suite 300  
Bethesda, MD 20814  
301-634-8600  
Jack Lester



Attorney:  
Linowes and Blocher LLP  
7200 Wisconsin Avenue, Suite 800  
Bethesda, MD 20814  
301-654-0504  
Erin Girard



Civil Engineer:  
Johnson Bernat Associates, Inc.  
205 N. Frederick Avenue, Suite 100  
Gaithersburg, MD 20877  
301-963-1133  
Kevin Johnson



Architect:  
Mushinsky Voelzke Associates | MV+A  
1200 G Street, NW Suite 250  
Washington, DC 20005  
202-682-2822  
Jim Voelzke



Landscape Architect:  
LandDesign  
200 South Peyton Street  
Alexandria, VA 22314  
703.594.7784  
Gabriela Canamar



Traffic Consultant:  
Wells + Associates  
8730 Georgia Avenue, Suite 200  
Silver Spring, MD 20910  
301-971-3415  
Nancy Randall

SITE PLAN NO. 820180190

**TOWNHOMES BUILDING ELEVATIONS #5**

MAY 1, 2018

DRAWN BY: jfmc  
CHECKED BY: jfmc

REV.	ISSUE	DATE
SUBMISSION 1		04.20.2018
SUBMISSION 2		09.19.2018

DRAWING STAMP

SHEET NUMBER  
A314

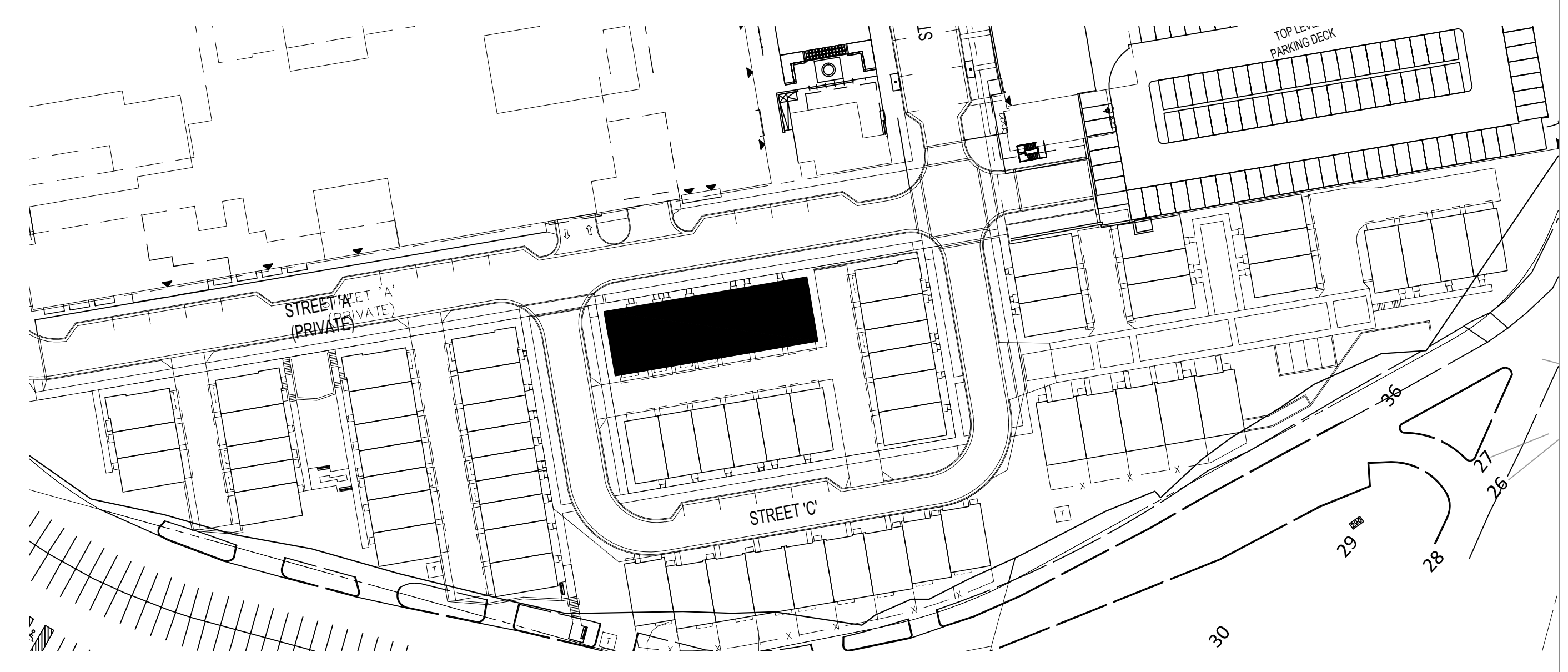

**0 KEY PLAN**  
Scale: N.T.S.



**3 LEFT SIDE ELEVATION - BUILDING #5**  
Scale: 1/8"=1'-0"



**1 FRONT ELEVATION - BUILDING #5**  
Scale: 1/8"=1'-0"



**2 RIGHT SIDE ELEVATION - BUILDING #5**  
Scale: 1/8"=1'-0"



**4 REAR ELEVATION - BUILDING #5**  
Scale: 1/8"=1'-0"

NOTE: FINAL BUILDING LOCATIONS, DIMENSIONS, HEIGHT, AND UNIT TYPE DESIGNATIONS TO BE DETERMINED AT TIME OF CERTIFIED SITE PLAN. THE PROPOSED ARCHITECTURAL DETAILS AND MATERIALS ARE CONCEPTUAL AND SUBJECT TO REVISION AT THE TIME OF CERTIFIED SITE PLAN.

**DEVELOPER'S CERTIFICATE**  
The Undersigned agrees to execute all the features of the Site Plan Approval No. 820180190 including Approval Conditions, Development Program, and Certified Site Plan.  
Applicant's Name: Equity One LLC c/o Regency Centers - Sam Stibel  
Company Contact Person  
Address: 1919 Gallows Road S. 1000  
Vienna, VA 22182  
Phone: 703-442-4302  
Signature: \_\_\_\_\_

F:\DEPT\LAND\ACQUISITION\LANDSURVIA\WESTWOOD COMPLEX\SCHEMATIC\ELEVATIONS\DWG\WB-STRIP ELEVATIONS 180114.DWG  
 1/14/2019 11:51 AM  
 © MUSHINSKY VOELZKE ASSOCIATES