

WESTWOOD SHOPPING CENTER

7TH ELECTION DISTRICT
BETHESDA, MARYLAND

Applicant / Owner:
Equity One (Northeast Portfolio) LLC
c/o Regency Centers, L.P.

Regency Centers

1919 Gallows Road, Suite 1000
Vienna, VA 22182
703-442-4302
Sam Steibel

EYA

Residential Developer:
The Neighborhoods of EYA
4800 Hampden Lane, Suite 300
Bethesda, MD 20814
301-634-8600
Jack Lester

LINOWES AND BLOCHER LLP
ATTORNEYS AT LAW

Attorney:
Linowes and Blocher LLP
7200 Wisconsin Avenue, Suite 800
Bethesda, MD 20814
301-654-0504
Erin Girard

J.B.A.
Johnson • Bernat • Associates, Inc.

Civil Engineer:
Johnson Bernat Associates, Inc.
205 N. Frederick Avenue, Suite 100
Gaithersburg, MD 20877
301-953-1133
Kevin Johnson

mv+a

Architect:
Mushinsky Voeztko Associates | MV+A
1200 G Street, NW, Suite 250
Washington, DC 20005
202-682-2822
Jim Voeztko

LandDesign

Landscape Architect:
LandDesign
200 South Peyton Street
Alexandria, VA 22314
703.594.7784
Gabriela Canamar

Wells + Associates

Traffic Consultant:
Wells + Associates
8730 Georgia Avenue, Suite 200
Silver Spring, MD 20910
301-971-3415
Nancy Randall

SITE PLAN NO. 820180190

STORMWATER MANAGEMENT CONCEPT PLAN

SEPTEMBER 19, 2018

DRAWN BY: AMB CHECKED BY: KJJ

REV.	ISSUE	DATE

DRAWING STAMP

SHEET NUMBER

SP-SWM-1

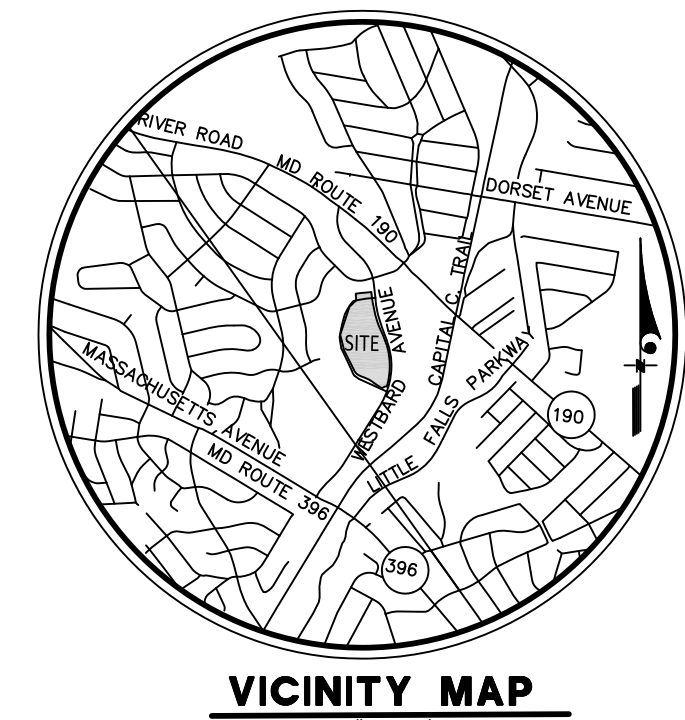

ONSITE:

AREA DIST.	= 11.02 AC
IMPERVIOUS	= 9.69 AC
TO MB1-MB4	= 0.96 AC
TO MB5-MB8	= 1.61 AC
TO MB TYPE A	= 1.15 AC
TO MB TYPE B	= 0.35 AC
TO MB TYPE C	= 0.39 AC
TO ALTERNATIVE	= 5.10 AC

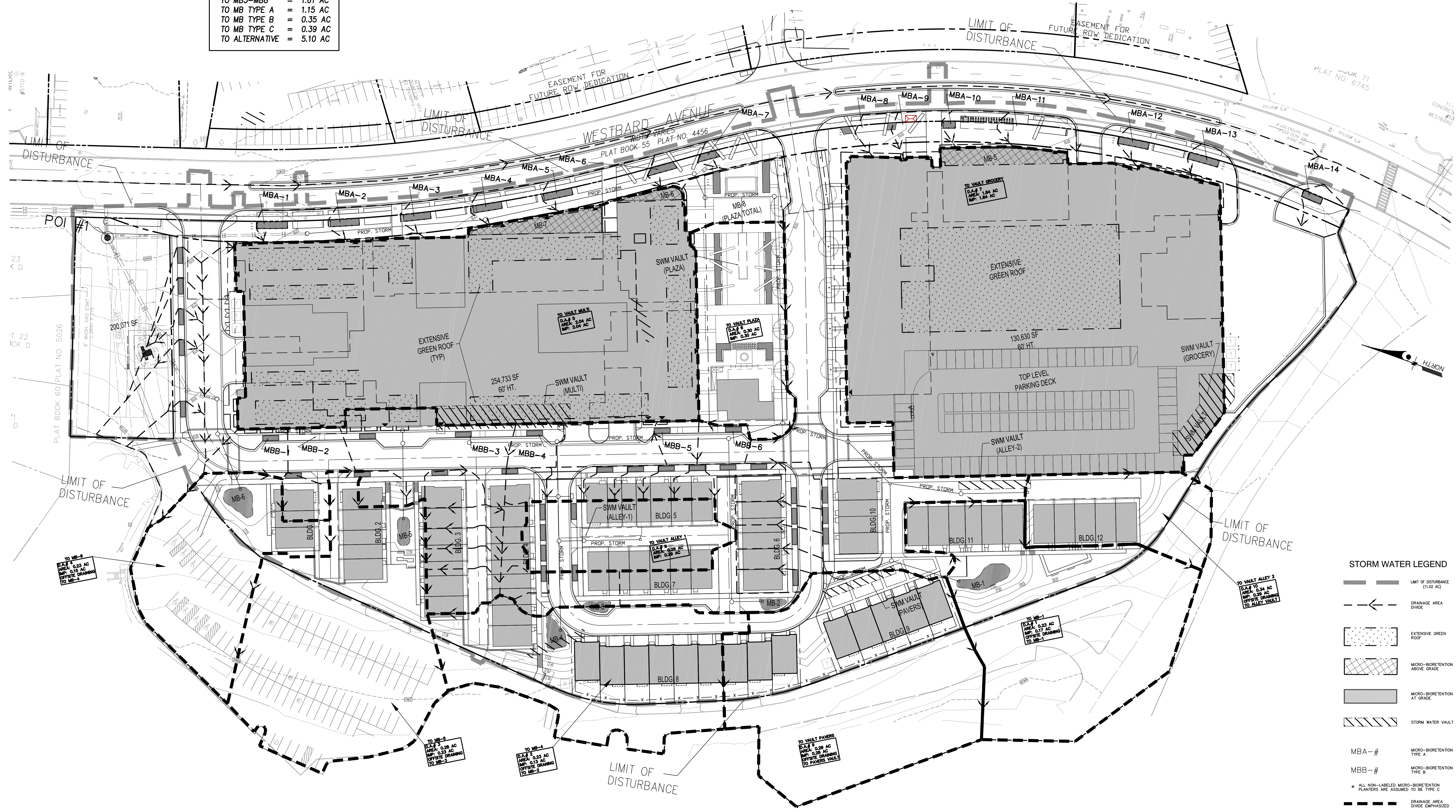

STORM WATER LEGEND

	LIMIT OF DISTURBANCE (11.02 AC)
	DRAINAGE AREA DIVIDE
	EXTENSIVE GREEN ROOF
	MICRO-BIORETENTION ABOVE GRADE
	MICRO-BIORETENTION AT GRADE
	STORM WATER VAULT
MBA-#	MICRO-BIORETENTION TYPE A
MBB-#	MICRO-BIORETENTION TYPE B
* ALL NON-LABELLED MICRO-BIORETENTION PLANTERS ARE ASSUMED TO BE TYPE C	
	DRAINAGE AREA DIVIDE EMPHASIZED

SCALE: 1"=40'