

ORDER FOR TRAFFIC CONTROL SIGNS

Pursuant to Section 31-2 and 31-10, Montgomery County Code, 2004 as amended, you are hereby directed to install the following traffic and or parking control devices at the designated location(s).

ID#	Signs to Install	Location
1	No Parking Fire Lane	In Montgomery Village: on the north and south side of proposed Private Street A, located at the intersection of Area #6 Private Street A & Montgomery Village Avenue, and every 200' continuing down the road.
2	No Parking Fire Lane	In Montgomery Village: on the north and south side of proposed Private Street B, located at the intersection of Area #6 Private Street B & Stewartown Road, and every 200' continuing down the road.
3	No Parking Fire Lane	In Montgomery Village: on the east and west of the island on proposed Private Street C, located 290' from the intersection of Area #6 Private Street B & Stewartown Road, and every 200' along the loop road.

- LEGEND**
- - Fire Lane Sign/Direction
 - Proposed Fire Hydrant

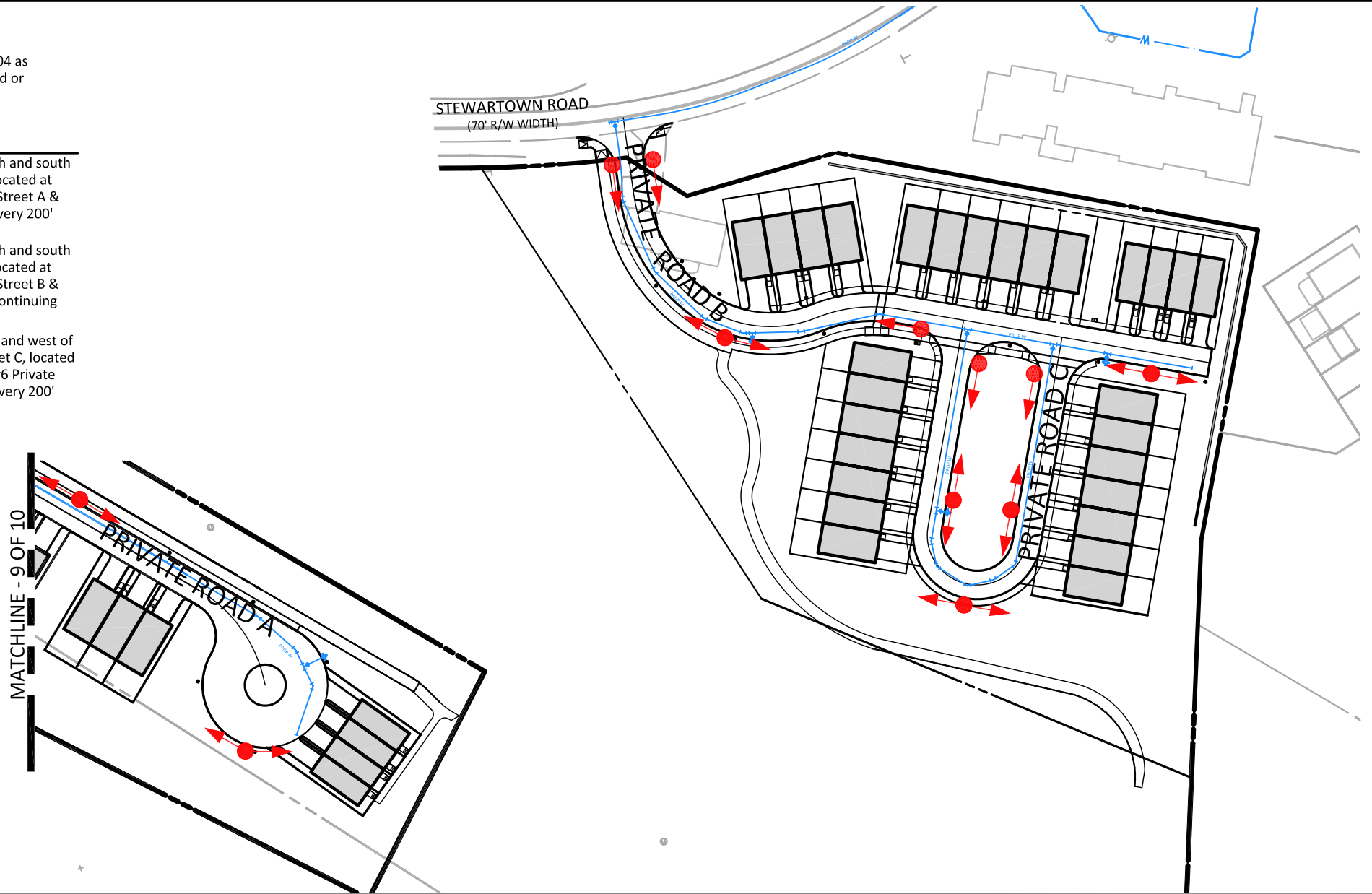

VIKA MARYLAND, LLC ■
 ENGINEERS ■ PLANNERS ■ LANDSCAPE ARCHITECTS ■
 SURVEYORS ■ 3D LASER SCANNING ■
 20251 CENTURY BOULEVARD SUITE 400 ■
 GERMANTOWN, MD 20874 ■
 (301)916-4100 ■ FAX (301)916-2262 ■
 WWW.VIKA.COM ■

BLOOM MV
 WSSC GRID: 227NW09
 TAX MAP: FU342
 9TH ELECTION DISTRICT
 MONTGOMERY COUNTY, MARYLAND

FIRE LANE ORDER	
DATE: MAY 19, 2017	
DRAWN: LWA	CHECKED: JS
----	10 OF 10



0 50 100 200

SCALE: 1" = 100'

PRIVATE STREETS A, B & C - AREA #6
FIRE LANE ORDER - NO PARKING SIGN LOCATIONS